

The London Borough of Richmond upon Thames (East Twickenham) (Parking Places) (No. 1) Order
202*

The London Borough of Richmond upon Thames (Parking Places) (Supplementary Provisions) (Permits)
(No. *) Order 202*

The London Borough of Richmond upon Thames (Waiting and Loading Restriction) (Civil Enforcement
Area) (Amendment No. *) Order 202*

ZONE F – EAST TWICKENHAM EXTENSION

(Reference 23/069)

1. The Council of the London Borough of Richmond upon Thames propose to make the above Orders under sections 6, 45, 46 and 49 of the Road Traffic Regulation Act 1984, as amended.
2. The general effect of the **Parking Places Order** will be to increase East Twickenham CPZ to include Beresford Avenue and Park Road operating between 10am and 4.30pm on Mondays to Fridays inclusive.
3. The general effect of the **Waiting and Loading Restriction Order** will be to introduce waiting restrictions in various lengths of the roads within the zone.
4. Within the zone, there will be designated resident permit holder only parking places and residents permit parking area where only vehicles which display a valid resident's permit may park during the controlled hours, or shared use bays.
5. Copies of the proposed Orders, a plan showing the location and effect of the Orders and the Council's Statement of Reasons for making the Orders: -
 - (a) can be inspected, quoting Reference 23/069, at the Civic Centre (Central Reception, ground floor), 44 York Street, Twickenham between 9.15am and 5pm on Mondays to Fridays, except for Bank and other public holidays; and
 - (b) may be viewed on the Council's web-site at http://www.richmond.gov.uk/public_notices.
6. Persons wishing to object to or support the proposals or any part thereof should write to the Head of Engineering, Traffic and Parking Policy, London Borough of Richmond upon Thames, Civic Centre, 44 York Street, Twickenham TW1 3BZ within 28 days of the date of this Notice giving the grounds of their objection. Representations may also be sent by email to Trafficorders@richmond.gov.uk

Nick O'Donnell
Assistant Director – Traffic and Engineering
Civic Centre, 44 York St, Twickenham, TW1 3BZ

Dated 21 April 2023

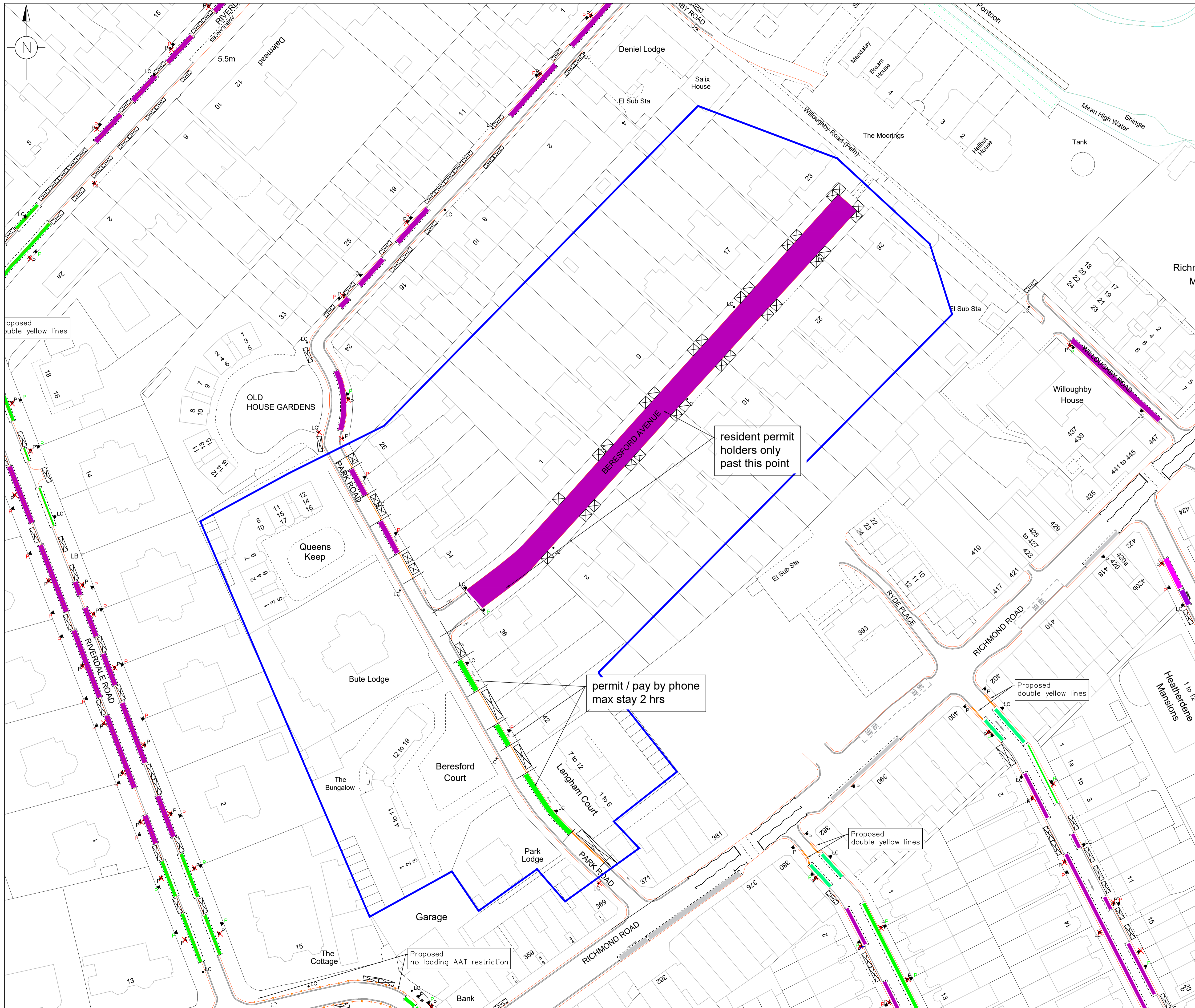

- KEY**
- RESIDENT PERMIT HOLDERS ONLY
 - RESIDENT PERMIT HOLDERS ONLY PAST THIS POINT
 - SHARED USE
 - EXISTING NO WAITING RESTRICTIONS : 'Mon-Fri 10am to 4.30pm'
 - EXISTING NO WAITING RESTRICTIONS : 'At Any Time'
 - PROPOSED NO WAITING RESTRICTIONS : 'At Any Time'
 - PROPOSED NO WAITING RESTRICTIONS : 'Mon-Fri 10am to 4.30pm'
 - ZONE EXTENSION BOUNDARY

"This map is reproduced from Ordnance Survey material with the permission of the Controller of Her Majesty's Stationery Office © Crown copyright. Unauthorised reproduction infringes Crown copyright and may lead to prosecution or civil proceedings. London Borough of Richmond Licence Number: 100019441 [2023]."

Rev	Date	By	Amendments
A	04/2019	MM	
Drawing Status: PROPOSAL			
Project Title: EAST TWICKENHAM ZONE F ZONE EXTENSION			
Drawing Title: PARK ROAD AND BERESFORD AVENUE			



Scale @ A1:	1:500	Drawn By:	MH	Project No:	2245-CPZF	Drawing No:	CPZ-F-001
Date:	APRIL 2023	Checked By:	CG	Revision:	D		