

## PUBLIC NOTICE:

### ROAD TRAFFIC REGULATION ACT 1984

#### THE GLA ROADS AND GLA SIDE ROADS (RICHMOND UPON THAMES) RED ROUTE CONSOLIDATION TRAFFIC ORDER 2007 THE VARIOUS ROADS (E-SCOOTER AND CYCLE BAYS) VARIATION ORDER 2026

1. Transport for London, hereby gives notice that it intends to make the above named Order under section 6 of the Road Traffic Regulation Act 1984.
2. The general nature and effect of the Order will be to:
  - (1) shorten the 20 metre long Monday to Saturday 7 am to 7 pm 1 hour parking and disabled persons' vehicles bay at the eastern side of East Sheen Avenue, to the side of No. 321 Upper Richmond Road West, by 14.5 metres at its northern end to accommodate an 11 metre long at any time hireable e-scooter and cycle only bay, 1.5 metre long traffic islands with bollards will be installed at each end. The adjacent Double Red Lines (No Stopping at Any Time) restrictions will be altered to reflect the changes;
  - (2) shorten the 15 metre long Monday to Saturday 7 am to 7 pm 1 hour parking and disabled persons' vehicles bay at the north-western side of Beechwood Avenue, to the side of No. 62 Mortlake Road, by 9 metres at its south-western end to accommodate an 6 metre long at any time hireable e-scooter and cycle only bay, 1.5 metre long traffic islands with bollards will be installed at each end. The adjacent Double Red Lines (No Stopping at Any Time) restrictions will be altered to reflect the changes;
  - (3) shorten the 19.25 metre long Monday to Saturday 7 am to 7 pm 1 hour parking and disabled persons' vehicles bay at the western side of Connaught Avenue, to the side of No. 344 Upper Richmond Road West, by 12 metres at its northern end to accommodate a 10.5 metre long at any time hireable e-scooter and cycle only bay with a 1.5 metre long traffic islands with bollards will be installed at its southern end. The adjacent Double Red Lines (No Stopping at Any Time) restrictions will be altered to reflect the changes;
  - (4) shorten the 21 metre long Monday to Saturday 7 am to 7 pm 1 hour parking and disabled persons' vehicles bay outside Sandstone, No. 5 Kent Road by 15.5 metres at its south-eastern end to accommodate a 12 metre long at any time hireable e-scooter and cycle only bay. 1.5 metre long traffic islands with bollards will be installed at either end. The adjacent Double Red Lines (No Stopping at Any Time) restrictions will be altered to reflect the changes;

- (5) replace the 15 metre long Monday to Saturday 7 am to 7 pm 1 hour parking and disabled persons' vehicles bay at the western side of Sutherland Gardens, to the side of No. 54 Upper Richmond Road West, with a 12.5 metre long at any time hireable e-scooter and cycle only bay. 1.5 metre long traffic islands with bollards will be installed at either end. Double Red Lines (No Stopping at Any Time) restrictions will be implemented to accommodate the changes.
  - (6) shorten the 25 metre long Monday to Saturday 7 am to 7 pm 1 hour parking and disabled persons' vehicles bay opposite Nos. 1 to 5 North Road by 14.5 metres at its south-eastern end to accommodate a 12 metre long at any time hireable e-scooter and cycle only bay. 1 metre long traffic islands with bollards will be installed at either end. The adjacent Double Red Lines (No Stopping at Any Time) restrictions will be altered to reflect the changes;
  - (7) shorten the 16.5 metre long Monday to Saturday 7 am to 7 pm Loading 20 minutes and disabled persons' vehicles 3 hours bay outside Nos. 211 to 217 Lower Richmond Road by 8 metres at its eastern end to accommodate a 7.5 metre long at any time hireable e-scooter and cycle only bay and a 1 metre long traffic islands with bollards at its western end. The adjacent Double Red Lines (No Stopping at Any Time) restrictions will be altered to reflect the changes.
3. The roads which would be affected by the Order are East Sheen Avenue, Beechwood Avenue, Connaught Avenue, Kent Road, Sutherland Gardens, North Road and the A316 Lower Richmond Road,
  4. A copy of the Order, a statement of Transport for London's reasons for the proposals, a map indicating the location and effect of the Order and copies of any Order revoked, suspended or varied by the Order can be inspected by visiting our website at <https://haveyoursay.tfl.gov.uk/tro> and selecting the relevant borough and reference the Traffic Order relates to or by appointment during normal office hours at our office at the address below. To arrange an appointment please email [trafficordersection@tfl.gov.uk](mailto:trafficordersection@tfl.gov.uk). Copies of the documents may be requested via email at [trafficordersection@tfl.gov.uk](mailto:trafficordersection@tfl.gov.uk), or by post at the following address quoting reference SNO/REGULATION/STOT/JW/TRO/GLA/2026/0101:
    - Transport for London  
Streets Traffic Order Team  
(SNO/REGULATION/STOT)  
Palestra, 197 Blackfriars Road  
London, SE1 8NJ
  5. All objections and other representations to the proposed Order must be made in writing and must specify the grounds on which they are made. Objections and representations must be sent to Transport for London, Streets Traffic Order Team, Palestra, 197 Blackfriars Road, London, SE1 8NJ or by emailing [trafficordersection@tfl.gov.uk](mailto:trafficordersection@tfl.gov.uk) quoting reference SNO/REGULATION/STOT/JW/TRO/GLA/2026/0101, to arrive before 29<sup>th</sup> January 2026. Please note due to hybrid working access to post is restricted and requests for documents and confirmation of your objections or representations may be delayed. Objections and other representations may be communicated to other persons who may be affected.

Dated this 8<sup>th</sup> day of January 2026

***Henry Cresser***

***Planning and Performance Manager***, Transport for London  
Palestra, 197 Blackfriars Road, London, SE1 8NJ

# Transport for London

GLA 2026 No.0101

## THE GLA ROADS AND GLA SIDE ROADS (RICHMOND UPON THAMES) RED ROUTE CONSOLIDATION TRAFFIC ORDER 2007 THE VARIOUS ROADS (E-SCOOTER AND CYCLE BAYS) VARIATION ORDER 2026

Made \_\_\_\_\_/\_\_\_\_\_/\_\_\_\_\_

Coming into force \_\_\_\_\_/\_\_\_\_\_/\_\_\_\_\_

Transport for London in exercise of the powers conferred by section 6 of the Road Traffic Regulation Act 1984<sup>a</sup>, and of all other enabling powers, hereby makes the following Order—

### 1. Commencement and citation

This Order may be cited as The GLA Roads and GLA Side Roads (Richmond Upon Thames) Red Route Consolidation Traffic Order 2007 The Various Roads (E-scooter and Cycle Bays) Variation Order 2026, and shall come into force on \_\_\_\_/\_\_\_\_/\_\_\_\_\_.

### 2. Variations

The GLA Roads and GLA Side Roads (Richmond) Red Route Consolidation Traffic Order 2007<sup>b</sup> is varied by the following provisions of this Order.

- 1 Schedule 2B the following text is added after item 28 as follows:  
29. A205 (LOWER RICHMOND ROAD), the south-east side from a point 4.5 metres south-west of the extended north-eastern building line of Forsyth House, Nos.211 to 217 Lower Richmond Road to a point 7.5 metres Westwards.  
No Stopping At Any Time Except e-scooters and pedal cycles available for hire only
- 2 In Schedule 2B side road item 1. is substituted as follows: 1. (in the vicinity of (A205)) BEECHWOOD AVENUE, the north-west side from a point 3.25 metres west of the extended eastern building line of No. 62 Mortlake Road to a point 9.25 metres west of the extended eastern building line of No. 62

---

<sup>a</sup> 1984 c.27

<sup>b</sup> GLA/2007/416

Mortlake Road.

Parking Mon-Sat 7am - 7pm 1 hour No return within 2 hours

- 3 Schedule 2B side road item 6. is substituted as follows: 6. (in the vicinity of (A205)) CONNAUGHT AVENUE, the west side from a point 14.25 metres north of the extended southern building line of No. 344 Upper Richmond Road West to a point 1 metre north of the extended northernmost building line of No. 346 Upper Richmond Road West..  
Parking Mon-Sat 7am - 7pm 1 hour No return within 2 hours
- 4 in Schedule 2B side road Item 8 (In the vicinity of A205) is deleted.
- 5 in Schedule 2B side road Item 21 (In the vicinity of A205) is deleted.
- 6 Schedule 2B the following text is added after side road item 37 as follows:  
38. (in the vicinity of (A205)) BEECHWOOD AVENUE, the north-west side from a point 10.5 metres west of the extended eastern building line of No. 62 Mortlake Road to a point 3 metres west of the extended western building line of No. 62 Mortlake Road.  
No Stopping At Any Time Except e-scooters and pedal cycles available for hire only
- 7 Schedule 2B the following text is added after side road item 38 as follows:  
39. (in the vicinity of (A205)) CONNAUGHT AVENUE, the west side from a point 3 metres north of the extended southern building line of No. 344 Upper Richmond Road West to a point 10 metres Northwards.  
No Stopping At Any Time Except e-scooters and pedal cycles available for hire only
- 8 Schedule 2B the following text is added after side road item 39 as follows:  
40. (in the vicinity of (A205)) EAST SHEEN AVENUE, the east side from a point 4.5 metres south of the extended northern building line of No. 213 Upper Richmond Road West to a point 11 metres Southwards.  
No Stopping At Any Time Except e-scooters and pedal cycles available for hire only
- 9 Schedule 2B the following text is added after side road item 40 as follows:  
41. (in the vicinity of (A205)) SUTHERLAND GARDENS, the south-west side from a point 1 metre north-west of the extended southern building line of No. 54 Upper Richmond Road West to a point 13 metres North-westwards.  
No Stopping At Any Time Except e-scooters and pedal cycles available for hire only
- 10 Schedule 2B side road item 2. is substituted as follows: 2 (in the vicinity of (A316)) NORTH ROAD, the north-west side from a point 17.5 metres south of a point opposite the extended common boundary of Nos. 1 to 5 and No. 6 North Road to a point 7 metres south of a point opposite the extended common boundary of Nos. 1 to 5 and No. 6 North Road.  
Parking Mon-Sat 7am - 7pm 1 hour No return within 2 hours

- 11 Schedule 2B side road item 13. is substituted as follows: 13. (in the vicinity of (A316)) KENT ROAD, the north-west side from a point 2.5 metres south-west of the extended north-eastern building line of Nos. 9 to 15 Sandstone, Kent Road to a point 3 metres north-east of the extended north-eastern building line of Nos. 9 to 15 Sandstone, Kent Road.  
Parking Mon-Sat 7am - 7pm 1 hour No return within 2 hours
- 12 Schedule 2B the following text is added after side item 13 as follows:  
14. (in the vicinity of (A316)) KENT ROAD, the north-west side from a point opposite the extended south-western building line of Nos. 18 to 27 Kenmore Close to a point 4 metres south-west of the extended north-eastern building line of Nos. 9 to 15 Sandstone, Kent Road.  
No Stopping At Any Time Except e-scooters and pedal cycles available for hire only
- 13 Schedule 2B the following text is added after item 14 as follows:  
5. (in the vicinity of (A316)) NORTH ROAD, the north-west side from a point 30.75 metres south of a point opposite the extended common boundary of Nos. 1 to 5 and No. 6 North Road from a point 19 metres south of a point opposite the extended common boundary of Nos. 1 to 5 and No. 6 North Road.  
No Stopping At Any Time Except e-scooters and pedal cycles available for hire only
- 14 In Schedule 3A main road item 5. is substituted as follows: 5. A316 (LOWER RICHMOND ROAD), the south-east side from a point 10.5 metres north-east of the extended common building line of Nos. 211 to 217 and 219 Lower Richmond Road to a point 8 metres north-eastwards.  
No Stopping Mon-Sat 7am - 7pm Except loading max 20 mins and disabled persons' vehicles max 3 hours
- 15 In Schedule 4 main road item 80. is substituted as follows: 80. A316 (LOWER RICHMOND ROAD), the south side from a point 2 metres west of the extended common boundary of Nos. 191 and 193 Lower Richmond Road to a point 4.5 metres south-west of the extended north-eastern building line of Forsyth House, Nos.211 to 217 Lower Richmond Road.  
No Stopping At Any Time
- 16 in Schedule 4 GLA/2012/0107 main road Item 80 A316 (LOWER RICHMOND ROAD) is deleted.
- 17 In Schedule 4 side road item 2. is substituted as follows: 2. (in the vicinity of (A205)) BEECHWOOD AVENUE, the north-west side from its junction with Mortlake Road to a point 3.25 metres west of the extended eastern building line of No. 62 Mortlake Road.  
No Stopping At Any Time
- 18 Schedule 4 side road item 17. is substituted as follows: 17. (in the vicinity of (A316)) KENT ROAD, the north-west side from its junction with Lower Richmond Road to a point 2.5 metres south-west of the extended north-

eastern building line of Nos. 9 to 15 Sandstone, Kent Road.  
No Stopping At Any Time

- 19 Schedule 4 side road item 28. is substituted as follows: 28 (in the vicinity of (A316)) NORTH ROAD, the north-west side its junction with Lower Richmond Road to a point 17.5 metres south of a point opposite the extended common boundary of Nos. 1 to 5 and No. 6 North Road.  
No Stopping At Any Time
- 20 Schedule 4 the following text is added after item 71 as follows:  
72. (in the vicinity of (A205)) BEECHWOOD AVENUE, the north-west side from a point 9.25 metres west of the extended eastern building line of No. 62 Mortlake Road to a point 4 metres west of the extended western building line of No. 62 Mortlake Road.  
No Stopping At Any Time
- 21 Schedule 4 the following text is added after item 72 as follows:  
73. (in the vicinity of (A205)) CONNAUGHT AVENUE, the west side from a point 3 metres north of the extended southern building line of No. 344 Upper Richmond Road West to a point 14.25 metres north of the extended southern building line of No. 344 Upper Richmond Road West.  
No Stopping At Any Time
- 22 Schedule 4 the following text is added after item 73 as follows:  
74. (in the vicinity of (A205)) EAST SHEEN AVENUE, the east side from a point 3.5 metres south of the extended northern building line of No. 213 Upper Richmond Road West to a point 4 metres south of the extended southern building line of No. 213 Upper Richmond Road West .  
No Stopping At Any Time
- 23 Schedule 4 the following text is added after item 74 as follows:  
75. (in the vicinity of (A205)) SUTHERLAND GARDENS, the south-west side from the extended southern building line of No. 54 Upper Richmond Road West to a point 15 metres North-westwards.  
No Stopping At Any Time

Dated this \_\_\_\_ day of \_\_\_\_\_

**Henry Cresser**  
**Planning and Performance Manager**  
Transport for London

# **Transport for London**

**GLA 2007 No. 416**

## **THE GLA ROADS AND GLA SIDE ROADS (RICHMOND UPON THAMES) RED ROUTE CONSOLIDATION TRAFFIC ORDER 2007**

*Made*

*28<sup>th</sup> November 2007*

*Coming into force*

*12<sup>th</sup> December 2007*

Transport for London in exercise of the powers conferred by sections 6 and 124 of and Part IV of Schedule 9 to the Road Traffic Regulation Act 1984<sup>a</sup> and of all other enabling powers, hereby makes the following Order.

### **1. Commencement and citation**

This Order may be cited as The GLA Roads and GLA Side Roads (Richmond Upon Thames) Red Route Consolidation Traffic Order 2007, and shall come into force on 12<sup>th</sup> December 2007.

### **2. Interpretation**

(1) In this Order-

- (a) a reference to an article or a schedule followed by a number is a reference to the article of, or the schedule to, this Order so numbered;
- (b) an entry in column (3),(4) or (5) of an item in a table in a schedule to this Order applies to that column in subsequent items in that table;
- (c) "authorised agent" means a parking services contractor appointed by and acting on behalf of Transport for London for the purposes of enforcing the provisions of this order;
- (d) "bus" has the same meaning as in regulation 22 of the Traffic Signs Regulations and General Directions 2002<sup>b</sup>;
- (e) "bus stop" means an area of carriageway bounded by the broken yellow lines comprising the road marking shown in diagram 1025.1, 1025.3 or 1025.4 in schedule 6 to the Traffic Signs Regulations and General Directions 2002 and on which is marked the words "bus stop";

---

<sup>a</sup> 1984 c.27

<sup>b</sup> S.I. 2002/3113



- (f) "bus stand" means an area of carriageway bounded by the broken yellow lines comprising the road marking shown in diagram 1025.1, 1025.3 or 1025.4 in schedule 6 to the Traffic Signs Regulations and General Directions 2002 and on which is marked the words "bus stand";
- (g) "carriageway" has the same meaning as in section 329(1) of the Highways Act 1980<sup>a</sup>;
- (h) "cause" includes permit, and "causing" includes "permitting";
- (i) disabled person's badge" and "parking disc" have the same meaning as in regulation 3(1) of the Local Authorities' Traffic Orders (Exemptions for Disabled Persons) (England) Regulations 2000<sup>b</sup>, and "relevant position" has the same meaning as in regulation 4 of those Regulations;
- (j) "GLA Road" has the same meaning as in sections 14D(1) and 329(1) of the Highways Act 1980;
- (k) "GLA Side Road" has the same meaning as in sections 124A(9) and 142(1) of the Road Traffic Regulation Act 1984;
- (l) "medical practitioner" means a person who provides health care to patients in the community, from a medical practice or health centre, and for whom the use of a vehicle is essential to providing that care, and includes, amongst others, doctors, nurses, midwives and health visitors;
- (m) "London Taxi" means a vehicle licensed under Section 6 of the Metropolitan Public Carriage Act 1869<sup>c</sup>
- (n) "London private hire vehicle" means a vehicle licensed under Section 7 of the Private Hire Vehicles (London) Act 1998<sup>d</sup> and fitted with signs authorised by Transport for London
- (o) "parking attendant" has the same meaning as in section 82(1) of the Road Traffic Act 1991<sup>e</sup>;
- (p) "pedal cycle" and "solo motor cycle" have the same meaning as in regulation 4 of the Traffic Signs Regulations and General Directions 2002;
- (q) "provision of a universal postal service" and "universal service provider" have the same meanings as in section 126 of the Postal Services Act 2000<sup>f</sup>
- (r) "public highway" has the same meaning as "highway maintainable at the public expense" in section 329(1) of the Highways Act 1980;
- (s) "red route" means those roads, or lengths of roads, that are specified in Schedule 1; comprising the whole width of public highway except where only one side of a road or length of road is specified, wherein it shall comprise the public highway from its edge to the centre of the carriageway;
- (t) "traffic sign" has the same meaning as in section 64 of the Road Traffic Regulation Act 1984;

---

<sup>a</sup> 1980 c.66

<sup>b</sup> S.I 2000/683

<sup>c</sup> 1869 c.115 Vict

<sup>d</sup> 1998 c.34

<sup>e</sup> 1991 c.40

<sup>f</sup> 2000 c.26

(u) "vehicle" includes any part of a vehicle.

(2) The Interpretation Act 1978<sup>a</sup> applies to this Order as if it were an enactment.

### **3. General prohibition of stopping**

- (1) Subject to the provisions of paragraphs (2) and (3) of this article, and of articles 4, 5, 6, 7, 9 and 10, no person shall cause any vehicle to stop on a red route during the restricted hours.
- (2) Subject to the provisions of paragraph (3) of this article, and of articles 4, 5, 6, 7, 9 and 10, no person shall cause any vehicle to stop at any time on a length of red route specified in schedule 4.
- (3) The controls specified in paragraphs (1) and (2) of this article do not apply in respect of any area of or length of road specified in an item in column (2) of the table in schedule 2A.
- (4) In this article "the restricted hours" means, in relation to a red route specified in an item in column (2) of the table in Schedule 1, the hours specified in column (3) in that item.

### **4. Exemptions for parking**

The controls specified in article 3(1) and (2) do not apply in respect of a person causing a vehicle to be parked, in accordance with the provisions of article 8, on a length of red route specified in an item in column (2) of the table in schedule 2B, during the hours specified in column (3) in that item, for a period not exceeding the period specified in column (4) in that item, provided that not less than the period specified in column (5) in that item has elapsed since the vehicle was last parked on any part of the same length of red route.

### **5. Miscellaneous exemptions for parking**

- (1) **Licensed taxis:** The controls specified in article 3(1) and (2) do not apply in respect of a person causing a London Taxi to be parked at the edge of carriageway on a length of road specified in schedule 2D.
- (2) **Buses:** The controls specified in article 3(1) and (2) do not apply in respect of a person causing a bus to be parked, in accordance with the provisions of article 8, on a length of red route specified in an item in column (2) of the table in schedule 2E, during the hours specified in column (3) in that item, for a period not exceeding the period specified in column (4) in that item, provided that not less than the period specified in column (5) in that item has elapsed since the vehicle was last parked on any part of the same length of red route.

---

<sup>a</sup> 1978 c.40

- (3) Medical practitioners' vehicles: The controls specified in article 3(1) and (2) do not apply in respect of a person causing a vehicle to be parked, in accordance with the provisions of article 8, on a length of red route specified in column (2) of the table in schedule 2F, during the hours specified in column (3) in that item, provided that-
- (a) there is displayed in the windscreen of the vehicle a permit issued by, or with the authority of, Transport for London to a medical practitioner, and which specifies:
    - (i) the name of the person to whom it was issued, and
    - (ii) the premises in relation to which it applies; and
  - (b) the vehicle was parked by, or with the permission of, the person whose name is specified on the permit and for so long only as the person who parked the vehicle is engaged in work at the premises specified on the permit.
- (4) Solo motor cycles: The controls specified in article 3(1) and (2) do not apply in respect of a person causing a solo motor cycle to be parked, in accordance with the provisions of article 8, on a length of red route specified in an item in column (2) of the table in schedule 2G, during the hours specified in column (3) in that item.

## **6. Exemptions for loading and unloading**

The controls specified in article 3(1) and (2) do not apply in respect of a person causing a vehicle to be stopped, in accordance with the provisions of article 8, on a length of red route specified in an item in column (2) of the table in schedule 3A or 3B, during the hours specified in column (3) in that item, provided that the vehicle is stopped only for the purposes of loading or unloading that vehicle for as long as is necessary or for a period of 20 minutes, whichever is the less, and provided that not less than 20 minutes has elapsed since the vehicle was last parked on any part of the same length of red route.

## **7. Exemptions for disabled persons**

- (1) The controls specified in article 3(1) and (2) do not apply in respect of a person causing a vehicle displaying a disabled person's badge in the relevant position to be parked, in accordance with the provisions of article 8, on a length of red route specified in an item in column (2) of the table in schedule 2B, during the hours specified in column (3) in that item.
- (2) The controls specified in article 3(1) and (2) do not apply in respect of a person causing a vehicle displaying a disabled person's badge in the relevant position to be parked, in accordance with the provisions of article 8, on a length of red route specified in column (2) of the table in schedule 2C, during the hours specified in column (3) in that item.

- (3) The controls specified in article 3(1) and (2) do not apply in respect of a person causing a vehicle displaying a disabled person's badge in the relevant position, and a parking disc on which is shown the time at which the period of parking began, to be parked, in accordance with the provisions of article 8, on a length of red route specified in an item in column (2) of the table in schedule 3A, during the hours specified in column (3) in that item, for a period of up to 3 hours, provided that not less than 1 hour has elapsed since the vehicle was last parked on any part of the same length of red route.

## **8. Manner of parking or Stopping**

Whenever a vehicle is parked or stopped on a length of red route specified in an item in column (2) of a table in schedule 2D, or in an item in column (2) of a table in schedule 2B, 2C, 2E, 2F, 2G, 3A or 3B during the hours specified in column (3) in that item, the vehicle shall stand either wholly within:-

- (1) an area of carriageway comprised in that length of red route which is bounded on one side or sides by the edge of the carriageway of that length of red route and on the other side or sides by a traffic sign indicating the limits of the area of carriageway within which a vehicle may be parked; or
- (2) an area of footway, carriageway or an area of both footway and carriageway comprised in that length of red route which is bounded on all sides by a traffic sign indicating the limits of the area of footway, carriageway or the area of both footway and carriageway, as the case may be, within which a vehicle may be parked.

## **9. Exemptions at bus stops and stands**

- (1) The controls specified in article 3 (1) and (2) do not apply in respect of a person causing-
  - (a) a bus to stop at a bus stop for as long as may be required to enable passengers to board or alight; or
  - (b) a bus to stop at a bus stop or a bus stand and being used for operational reasons in the course of providing a London local service (as defined in section 179 of the Greater London Authority Act 1999<sup>a</sup>) under an agreement with Transport for London or training drivers to allow such a service to be provided.
- (2) In this article "operational reasons" means-
  - (i) to enable passengers to board and alight; or
  - (ii) to enable crew changes to take place; or
  - (iii) to maintain the scheduled timetable subject, in the case of a bus stop, to a maximum wait of two minutes.

---

<sup>a</sup> 1999 c.29

## **10. Other exemptions**

- (1) The controls specified in article 3(1) and (2) do not apply in respect of a person causing a vehicle to stop if that person is-
  - (a) required by law to cause the vehicle to stop or not to proceed;
  - (b) obliged to stop the vehicle so as to avoid an accident;
  - (c) prevented from proceeding in the vehicle by circumstances beyond the person's control;
  - (d) getting or giving help in consequence of an accident or an emergency, or otherwise taking action for public safety;
  - (e) opening or closing a gate or other barrier at the entrance to premises to which the vehicle is being driven or from which it has emerged, if it is not reasonably practicable to cause the vehicle to stop elsewhere for the purpose;
  - (f) using the vehicle on any occasion for fire brigade, ambulance or police purposes if the observance of those provisions would hinder the use of the vehicle;
  - (g) using the vehicle in connection with the removal of any obstruction to traffic;
  - (h) using the vehicle in connection with the maintenance, improvement or reconstruction of a red route;
  - (i) using a London Taxi or London private hire vehicle to stop for so long only as may be required to enable a passenger to get on or off the vehicle;
  - (j) using a vehicle displaying a disabled person's badge in the relevant position to stop for so long only as may be required to enable a disabled person to get on or off the vehicle;
- (2) The controls specified in article 3(1) and (2) do not apply in respect of a vehicle bearing a livery which is used by a universal service provider and which is stopped at the edge of the carriageway of a red route for as long as may be necessary for the purposes of the provision of a universal postal service.
- (3) The controls specified in article 3(1) and (2) do not apply to anything done with the permission or at the direction of a police constable in uniform or a parking attendant.
- (4) The controls specified in article 3(1) and (2) do not apply in respect of a person causing a pedal cycle to be parked at a facility specifically provided for the purpose of pedal cycle parking by, or with the consent of, the highway authority.

## **11. Revocation of certain provisions in existing Orders**

- (1) Subject to paragraphs (2) and (3) of this article, provisions of the Orders specified in the Annex to this Order, are hereby revoked in so far as those Orders establish red route controls within the roads or lengths of roads specified in schedule 1 of this Order.
- (2) Where other provisions of Orders specified in paragraph (1) of this article concern lengths of GLA Roads or GLA Side Roads, other than those specified in schedule 1 of this Order, then the provisions of those Orders shall continue in force.
- (3) Where the provisions of Orders specified in paragraph (1) of this article in relation to the roads specified in schedule 1 of this Order are varied by an order made under section 9 of the Road Traffic Regulation Act 1984, then those provisions shall continue in force, as varied, until the Order made under section 9 of that Act is revoked or expires.

Dated this 28<sup>th</sup> day of November 2007

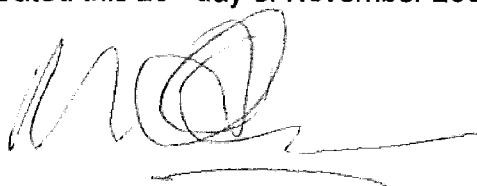
A handwritten signature in black ink, appearing to read 'Mark Allan', with a horizontal line underneath.

**Mark Allan**  
**Head of Strategic Project Support**  
Road Network Development  
Transport for London

**The GLA Roads and GLA Side Roads  
(Richmond Upon Thames) Red Route  
Consolidation Traffic Order 2007**

**SCHEDULE 2B**

**Articles 4 and 7(1)**

**Lengths of the red route on which there are exemptions for parking and disabled persons' vehicles**

**Table**

<i>(1) Item</i>	<i>(2) Length of Road</i>	<i>(3) Restricted Hours</i>	<i>(4) Maximum Period of Parking</i>	<i>(5) Minimum Interval</i>
<b>MAIN ROAD ITEMS</b>				
1	A205 MORTLAKE ROAD, the north-west side from a point 3 metres north-east of the extended south-eastern building line of No. 193 Mortlake Road for a distance of 11 metres in a north-westerly direction	Mon-Sat 7am-7pm	1 hour	2 hours
2	A205 MORTLAKE ROAD, the south-west side from a point 1 metre north of the extended common boundary of Nos. 134 and 136 Mortlake Road to the extended southern building line of No. 130 Mortlake Road	Mon-Sat 7am-7pm	1 hour	2 hours
3	A205 MORTLAKE ROAD, the west side from a point 7 metres south of the extended northern building line of No. 112 Mortlake Road to a point 1 metre north of the extended southern building line of No. 108 Mortlake Road	Mon-Sat 7am-7pm	1 hour	2 hours
4	A205 MORTLAKE ROAD, the west side from a point 125 metres north of the intersection of the extended northern kerbline of Upper Richmond Road and the extended western building line of Mortlake Road for a distance of 59 metres in a northerly direction	At any time	None	None
5	A205 UPPER RICHMOND ROAD WEST, the north side from a point 2 metres east of the extended common boundary of Nos. 350 and 352 Upper Richmond Road West to the extended common boundary of Nos. 356 and 358 Upper Richmond Road West	Mon-Sat 7am-7pm	20 mins	40 mins

**The GLA Roads and GLA Side Roads  
(Richmond Upon Thames) Red Route  
Consolidation Traffic Order 2007**

(1) Item	(2) Length of Road	(3) Restricted Hours	(4) Maximum Period of Parking	(5) Minimum Interval
25	A316 LOWER RICHMOND ROAD, the south-west side from a point 4 metres west of the extended common boundary of Nos. 189 and 191 Lower Richmond Road to a point 2 metres east of the extended common boundary of Nos. 191 and 193 Lower Richmond Road	Mon-Sat 7am-7pm	1 hour	2 hours
26	A316 LOWER RICHMOND ROAD, the south-west side from the extended common boundary of Nos. 219 and 221 Lower Richmond Road to a point 2 metres north-east of the extended common boundary of Nos. 235 and 237 Lower Richmond Road	At any time	None	None

**SIDE ROAD ITEMS**

*In the vicinity of the A205*

1	BEECHWOOD AVENUE, the north-west side from a point 3 metres west of the extended eastern building line of No. 62 Mortlake Road to a point 4 metres west of the extended western building line of No. 62 Mortlake Road	Mon-Sat 7am-7pm	1 hour	2 hours
2	BURLINGTON AVENUE, the south-east side from a point 1 metre east of the extended eastern building line of No. 46 Mortlake Road to the extended southern building line of No. 46 Mortlake Road	Mon-Sat 7am-7pm	1 hour	2 hours
3	CARLTON ROAD, the east side from a point 7 metres north of the extended southern building line of No. 362 Upper Richmond Road West to the extended northern building line of No. 362 Upper Richmond Road West	Mon-Sat 7am-7pm	1 hour	2 hours
4	CARLTON ROAD, the west side from the extended southern building line of No. 364 Upper Richmond Road West to a point 2 metres south of the extended northern building line of No. 366 Upper Richmond Road West	Mon-Sat 7am-7pm	1 hour	2 hours



**The GLA Roads and GLA Side Roads  
(Richmond Upon Thames) Red Route  
Consolidation Traffic Order 2007**

**SCHEDULE 3A**

**Articles 6 and 7(3)**

**Lengths of the red route on which there are exemptions for loading or unloading for up to 20 minutes and for disabled persons' vehicles for up to 3 hours**

**Table**

(1) Item	(2) Length of Road	(3) Restricted Hours
<b>MAIN ROAD ITEMS</b>		
1	A205 UPPER RICHMOND ROAD WEST, the north-west side from a point 2 metres west of the extended common boundary of No. 274 Upper Richmond Road West and Nos. 274a to 276 Upper Richmond Road West to a point 1 metre east of the extended common boundary of Nos. 276b Upper Richmond Road West and Nos. 276c to 276d Upper Richmond Road West	Mon-Sat 10am-4pm
2	A316 LOWER MORTLAKE ROAD, the north-west side a point 3 metres east of the extended common boundary of Nos. 227 and 229 Lower Mortlake Road to a point 1 metre east of the extended common boundary of Nos. 211 and 213 Lower Mortlake Road	Mon-Sat 7am-7pm
3	A316 LOWER MORTLAKE ROAD, the south-east side from point 2 metres north-east of the extended common boundary of Nos. 14 and 16 St George's Road to a point 1 metre south-west of the extended common boundary of Nos. 6 and 8 St George's Road	Mon-Sat 7am-7pm
4	A316 LOWER RICHMOND ROAD, the south-west side from a point 3 metres east of the extended common boundary of Nos. 187 and 189 Lower Richmond Road to a point 4 metres west of the extended common boundary of Nos. 189 and 191 Lower Richmond Road	Mon-Sat 7am-7pm
<b>SIDE ROAD ITEMS</b>		
<i>In the vicinity of the A205</i>		
1	AVENUE GARDENS, the north-east side from the extended southern building line of No. 108 Upper Richmond Road West to a point 1 metre north of the extended northern building line of No. 108 Upper Richmond Road West	Mon-Sat 7am-7pm

**The GLA Roads and GLA Side Roads  
(Richmond Upon Thames) Red Route  
Consolidation Traffic Order 2007**

**SCHEDULE 3B**

**Article 6**

**Lengths of the red route on which there are exemptions for loading or unloading.**

**Table**

<i>(1) Item</i>	<i>(2) Length of Road</i>	<i>(3) Restricted Hours</i>
<b>MAIN ROAD ITEMS</b>		
1	A205 CLIFFORD AVENUE, the south-west side from a point 1 metre south of a point opposite the extended southern building line of No. 115 St Leonards Road to a point 1 metre north of a point opposite the extended northern building line of No. 113 St Leonards Road	Mon-Sat 7am-7pm
2	A205 DEANHILL ROAD, the south side from a point 2 metres east of the extended common boundary of PO, Upper Richmond Road West and No. 503 Upper Richmond Road West to a point 1 metre east of the extended common boundary of Nos. 505 and 507 Upper Richmond Road West	Mon-Sat 10am-4pm
3	A205 UPPER RICHMOND ROAD WEST, the north side from a point 2 metres east of the extended common boundary of Nos. 414 and 412 Upper Richmond Road West to a point 2 metres west of the extended common boundary of Nos. 414 and 416 Upper Richmond Road West	Mon-Sat 10am-4pm
4	A205 UPPER RICHMOND ROAD WEST, the north side from the extended common boundary of Nos. 310 and 312 Upper Richmond Road West to a point 2 metres east of the extended common boundary of Nos. 314 and 316 Upper Richmond Road West	Mon-Sat 10am-4pm
5	A205 UPPER RICHMOND ROAD WEST, the north side from the extended common boundary of Nos. 356 and 358 Upper Richmond Road West to a point 3 metres west of the extended common boundary of Nos. 358 and 360 Upper Richmond Road West	Mon-Sat 7am-7pm
6	A205 UPPER RICHMOND ROAD WEST, the north side from a point 12 metres west of the extended common boundary of Nos. 224 and 226 Upper Richmond Road West to a point 10 metres east of the extended common boundary of Nos. 232 and 234 Upper Richmond Road West	Mon-Sat 7am-7pm

**The GLA Roads and GLA Side Roads  
(Richmond Upon Thames) Red Route  
Consolidation Traffic Order 2007**

(1) Item	(2) Length of Road	(3) Restricted Hours
15	A205 UPPER RICHMOND ROAD WEST, the south side from a point 4 metres east of the extended common boundary of Nos. 439 and 441 Upper Richmond Road West to a point 5 metres east of the extended western building line of No. 445 Upper Richmond Road West	Mon-Sat 7am-7pm
16	A205 UPPER RICHMOND ROAD WEST, the south side from a point 4 metres east of the extended western building line of No. 413 Upper Richmond Road West to a point 9 metres west of the extended common boundary of Nos. 423 and 425 Upper Richmond Road West	Mon-Sat 7am-7pm
17	A205 UPPER RICHMOND ROAD WEST, the south side from a point 2 metres south-west of a point opposite the extended common boundary of Nos. 262 and 264 Upper Richmond Road West to a point 3 metres south-west of the extended common boundary of No. 379 and Nos. 381 to 383 Upper Richmond Road West	Mon-Sat 7am-7pm
18	A205 UPPER RICHMOND ROAD WEST, the south side from a point 2 metres east of the extended common boundary of Nos. 193 and 195 Upper Richmond Road West to the extended common boundary of Nos. 197 and 199 Upper Richmond Road West	Mon-Sat 7am-7pm
19	A316 CHERTSEY ROAD, the north side from a point 4 metres east of the extended south-western building line of No. 133 Chertsey Road for a distance of 16 metres in a westerly direction	Mon-Sat 7am-7pm
20	A316 CHERTSEY ROAD, the south side from the extended eastern building line of No. 2 Chertsey Road for a distance of 13 metres in a easterly direction	Mon-Sat 7am-7pm
21	A316 LOWER MORTLAKE ROAD, the north-west side from a point 1 metre east of the extended eastern building line of No. 45 Lower Mortlake Road to a point 1 metre north-east of the extended common boundary of No. 39 and Nos. 35 to 37 Lower Mortlake Road	Mon-Sat 7am-7pm
22	A316 LOWER RICHMOND ROAD, the north side from a point 5 metres east of the extended common boundary of Nos. 13 and 14 Lower Richmond Road to a point 5 metres west of the extended common boundary of Nos. 13 and 14 Lower Richmond Road	Mon-Sat 10am-4pm
23	A316 LOWER RICHMOND ROAD, the north side from a point 4 metres east of the extended eastern building line of No. 1 Lytchett Terrace, Lower Richmond Road	Mon-Sat 7am-7pm

**The GLA Roads and GLA Side Roads  
(Richmond Upon Thames) Red Route  
Consolidation Traffic Order 2007**

**SCHEDULE 4**

**Article 3(2)**

**Lengths of the red route on which stopping is prohibited at all times**

**Table**

<i>(1)</i> <i>Item</i>	<i>(2)</i> <i>Area of Road</i>
---------------------------	-----------------------------------

**MAIN ROAD ITEMS**

- |   |   |
|---|---|
| 1 | A205 CLIFFORD AVENUE, the east side from a point 1 metre south-west of a point opposite the extended common boundary of Nos. 109 and 111 St Leonards Road to the extended northern building line of No. 171 Lower Richmond Road                                 |
| 2 | A205 CLIFFORD AVENUE, the east side from the extended northern building line of No. 37 Clifford Avenue to a point 4 metres south of the extended southern building line of No. 35 Clifford Avenue   |
| 3 | A205 CLIFFORD AVENUE, the east side from a point 6 metres north-west of the extended western building line of No. 424 Upper Richmond Road West to a point 5 metres south of the extended northern building line of No. 37 Clifford Avenue                       |
| 4 | A205 CLIFFORD AVENUE, the south-west side from a point 3 metres south-east of a point opposite the extended southern building line of No. 33 Clifford Avenue for a distance of 5 metres in a north-westerly direction   |
| 5 | A205 CLIFFORD AVENUE, the west side from a point 1 metre north of a point opposite the extended northern building line of No. 113 St Leonards Road to a point 4 metres north of the extended north-western building line of Nos. 179 to 181 Lower Richmond Road |
| 6 | A205 CLIFFORD AVENUE, the west side from a point 3 metres north-east of the extended eastern building line of No. 462 Upper Richmond Road West to a point 3 metres north of the extended common boundary of Nos. 26 and 28 Clifford Avenue                      |
| 7 | A205 KEW GREEN, the south-west side from a point 6 metres north of the extended north-eastern building line of No. 9 Kew Green to the extended common boundary of Nos. 11 and 13 Kew Green  |
| 8 | A205 KEW ROAD, the east side from a point 3 metres south of the extended common boundary of No. 1a Mortlake Terrace, Mortlake Road and Nos. 2 to 4 Kew Green to a point 152 metres north of the extended north-eastern building line of No. 110 Waterloo Place  |

**The GLA Roads and GLA Side Roads  
(Richmond Upon Thames) Red Route  
Consolidation Traffic Order 2007**

(1) Item	(2) Area of Road
46	A316 CHERTSEY ROAD, the south side from a point 10 metres south-west of the extended south-eastern building line of No. 75 Cole Park Road to the extended north-eastern building line of No. 2 Chertsey Road
47	A316 CHERTSEY ROAD, the south side from a point 5 metres north-east of the extended common boundary of Nos. 114 and 116 Chertsey Road to a point 4 metres south-east of the extended easternmost building line of No. 213, Surgery, London Road
48	A316 CHERTSEY ROAD, the south side from a point 14 metres west of the extended western building line of No. 7 Russell Road for a distance of 59 metres in a easterly direction
49	A316 CHERTSEY ROAD, the south-east side from a point 9 metres south-west of the extended common boundary of Nos. 114 and 116 Chertsey Road to a point 7 metres north of the extended north-western building line of No. 116 Whitton Road
50	A316 CHERTSEY ROAD, the south-east side from a point 14 metres north-east of the extended north-eastern building line of No. 2 Chertsey Road to a point 14 metres west of the extended north westernmost building line of Nos. 1 to 60 The Grove, Chertsey Road
51	A316 CLIFFORD AVENUE, the north-east side from a point 3 metres north of a point opposite the extended common boundary of Nos. 141 and 143 Lower Richmond Road to a point 8 metres south-west of the extended common boundary of Nos. 69 to 76 Chertsey Court, Clifford Avenue and Nos. 77 to 84 Chertsey Court, Clifford Avenue
52	A316 CLIFFORD AVENUE, the north-west side from a point 8 metres south-west of a point opposite the extended common boundary of Nos. 69 to 76 Chertsey Court, Clifford Avenue and Nos. 77 to 84 Chertsey Court, Clifford Avenue to a point 1 metre north-east of a point opposite the extended common boundary of No. 145 Lower Richmond Road and Nos. 151 to 153 Lower Richmond Road
53	A316 LOWER MORTLAKE ROAD, the north-west side from a point 30 metres south-west of the extended north-eastern building line of Nos. 243 to 253 Lower Mortlake Road to a point 2 metres north-east of the extended south-western building line of No. 7 Raleigh Road
54	A316 LOWER MORTLAKE ROAD, the north-west side from the extended common boundary of Nos. 147 and 149 Lower Mortlake Road to a point 2 metres east of the extended common boundary of Nos. 155 and 157 Lower Mortlake Road

**The GLA Roads and GLA Side Roads  
(Richmond Upon Thames) Red Route  
Consolidation Traffic Order 2007**

---

(1) Item	(2) Area of Road
-------------	---------------------

---

- |    |  |
|----|--|
| 55 | A316 LOWER MORTLAKE ROAD, the north-west side from a point 2 metres east of the extended common boundary of Nos. 61 and 63 Lower Mortlake Road to a point 1 metre east of the extended north-eastern building line of No. 45 Lower Mortlake Road   |
| 56 | A316 LOWER MORTLAKE ROAD, the north-west side from a point 1 metre north-east of the extended common boundary of No. 39 Lower Mortlake Road and Nos. 35 to 37 Mortlake Road to the extended western building line of Nos. 54 to 56 Kew Road  |
| 57 | A316 LOWER MORTLAKE ROAD, the south-east side from a point 2 metres north-east of the extended north-eastern building line of No. 2 Salisbury Road to a point 1 metre north-east of a point opposite the extended north-western building line of No. 29 St John's Road   |
| 58 | A316 LOWER MORTLAKE ROAD, the south-east side from a point opposite the extended common boundary of Nos. 195 and 197 Lower Mortlake Road to a point 2 metres south-west of a point opposite the extended common boundary of Nos. 209 and 211 Lower Mortlake Road   |
| 59 | A316 LOWER MORTLAKE ROAD, the south-east side from the extended common boundary of Nos. 58 and 56 St George's Road to a point 1 metre west of the extended common boundary of Nos. 24 and 26 St George's Road  |
| 60 | A316 LOWER RICHMOND ROAD, the north side from a point 1 metre north-east of a point opposite the extended common boundary of No. 145 Lower Richmond Road and Nos. 151 to 153 Lower Richmond Road to a point 12 metres west of a point opposite the extended eastern building line of No. 199 Lower Richmond Road |
| 61 | A316 LOWER RICHMOND ROAD, the north side from a point 4 metres east of the extended eastern building line of Nos. 1 to 27 Cranleigh Court, Lower Richmond Road to a point 15 metres west of the extended eastern building line of Nos. 1 to 27 Cranleigh Court, Lower Richmond Road                              |
| 62 | A316 LOWER RICHMOND ROAD, the north side from a point 10 metres east of the extended eastern building line of Nos. 1 to 5 Garage, Lower Richmond Road to a point 2 metres east of the extended western building line of Nos. 1 to 5 Garage, Lower Richmond Road  |
-

**The GLA Roads and GLA Side Roads  
(Richmond Upon Thames) Red Route  
Consolidation Traffic Order 2007**

---

(1) Item	(2) Area of Road
-------------	---------------------

---

- |    |   |
|----|---|
| 73 | A316 ROUNDABOUT AT JUNCTION WITH WHITTON ROAD AND CHERTSEY ROAD, the outer side for its whole length  |
| 74 | A316 THE AVENUE, the south-east side from a point 6 metres south-west of the extended south-western building line of Nos. 16 to 18 Cumberland Close to the extended common boundary of Nos. 48 and 50 Heathcote Road                                      |
| 75 | A316 TWICKENHAM BRIDGE, the north-west side from a point 6 metres south-west of a point opposite the north-eastern building line of No. 39 The Avenue to a point opposite the extended north-eastern building line of No. 47 The Avenue                   |
| 76 | A316 TWICKENHAM BRIDGE, the south-east side from the extended common boundary of No. 48 and 50 Heathcote Road to the extended north-eastern building line of No. 47 The Avenue  |
| 77 | A316 TWICKENHAM ROAD, the north side from a point 27 metres west of the extended south-eastern building line of No. 28 Michel's Row, Twickenham Road to a point 53 metres east of the extended easternmost building line of the Public Baths, Kew Road    |
| 78 | A316 TWICKENHAM ROAD, the south side from the extended westernmost building line of No. 63 Kew Road to a point 52 metres north-east of a point opposite the extended north easternmost building line of Public Baths, Twickenham Road                     |
| 79 | UPPER RICHMOND ROAD WEST, the north side from a point 7.3 metres east of the extended common boundary of Nos. 180 and 182 Upper Richmond Road West to a point 31 metres east of the extended common boundary of Nos. 180 and 182 Upper Richmond Road West |

**SIDE ROAD ITEMS**

*In the vicinity of the A205*

- |   |   |
|---|---|
| 1 | KEW ROAD, the south-east side from a point 11 metres north-west of the extended north-western building line of No. 358 Kew Road to the extended common boundary of Nos. 356 and 358 Kew Road                            |
| 2 | BEECHWOOD AVENUE, the north-west side from a point 5 metres south of the extended southern building line of No. 62 Mortlake Road to a point 3 metres west of the extended eastern building line of No. 62 Mortlake Road |
-



# **Transport for London**

## **GLA 2026 No.0101**

### **THE GLA ROADS AND GLA SIDE ROADS (RICHMOND UPON THAMES) RED ROUTE CONSOLIDATION TRAFFIC ORDER 2007 THE VARIOUS ROADS (E-SCOOTER AND CYCLE BAYS) VARIATION ORDER 2026**

#### **STATEMENT OF REASONS**

1. Transport for London proposes to make The GLA Roads and GLA Side Roads (Richmond Upon Thames) Red Route Consolidation Traffic Order 2007 The Various Roads (E-Scooter And Cycle Bays) Variation Order 2026
2. The proposed Order will:
  - (1) shorten the 20 metre long Monday to Saturday 7 am to 7 pm 1 hour parking and disabled persons' vehicles bay at the eastern side of East Sheen Avenue, to the side of No. 321 Upper Richmond Road West, by 14.5 metres at its northern end to accommodate an 11 metre long at any time hireable e-scooter and cycle only bay, 1.5 metre long traffic islands with bollards will be installed at each end. The adjacent Double Red Lines (No Stopping at Any Time) restrictions will be altered to reflect the changes;
  - (2) shorten the 15 metre long Monday to Saturday 7 am to 7 pm 1 hour parking and disabled persons' vehicles bay at the north-western side of Beechwood Avenue, to the side of No. 62 Mortlake Road, by 9 metres at its south-western end to accommodate an 6 metre long at any time hireable e-scooter and cycle only bay, 1.5 metre long traffic islands with bollards will be installed at each end. The adjacent Double Red Lines (No Stopping at Any Time) restrictions will be altered to reflect the changes;
  - (3) shorten the 19.25 metre long Monday to Saturday 7 am to 7 pm 1 hour parking and disabled persons' vehicles bay at the western side of Connaught Avenue, to the side of No. 344 Upper Richmond Road West, by 12 metres at its northern end to accommodate a 10.5 metre long at any time hireable e-scooter and cycle only bay with a 1.5 metre long traffic islands with bollards will be installed at its southern end. The adjacent Double Red Lines (No Stopping at Any Time) restrictions will be altered to reflect the changes;



- (4) shorten the 21 metre long Monday to Saturday 7 am to 7 pm 1 hour parking and disabled persons' vehicles bay outside Sandstone, No. 5 Kent Road by 15.5 metres at its south-eastern end to accommodate a 12 metre long at any time hireable e-scooter and cycle only bay. 1.5 metre long traffic islands with bollards will be installed at either end. The adjacent Double Red Lines (No Stopping at Any Time) restrictions will be altered to reflect the changes;
- (5) replace the 15 metre long Monday to Saturday 7 am to 7 pm 1 hour parking and disabled persons' vehicles bay at the western side of Sutherland Gardens, to the side of No. 54 Upper Richmond Road West, with a 12.5 metre long at any time hireable e-scooter and cycle only bay. 1.5 metre long traffic islands with bollards will be installed at either end. Double Red Lines (No Stopping at Any Time) restrictions will be implemented to accommodate the changes.
- (6) shorten the 25 metre long Monday to Saturday 7 am to 7 pm 1 hour parking and disabled persons' vehicles bay opposite Nos. 1 to 5 North Road by 14.5 metres at its south-eastern end to accommodate a 12 metre long at any time hireable e-scooter and cycle only bay. 1 metre long traffic islands with bollards will be installed at either end. The adjacent Double Red Lines (No Stopping at Any Time) restrictions will be altered to reflect the changes;
- (7) shorten the 16.5 metre long Monday to Saturday 7 am to 7 pm Loading 20 minutes and disabled persons' vehicles 3 hours bay outside Nos. 211 to 217 Lower Richmond Road by 8 metres at its eastern end to accommodate a 7.5 metre long at any time hireable e-scooter and cycle only bay and a 1 metre long traffic islands with bollards at its western end. The adjacent Double Red Lines (No Stopping at Any Time) restrictions will be altered to reflect the changes.

on East Sheen Avenue, Beechwood Avenue, Connaught Avenue, Kent Road, Sutherland Gardens, North Road and the A316 Lower Richmond Road in the London Borough of Richmond Upon Thames.

### 3. The reason for introducing this Order is:

- (1) to facilitate the ongoing TfL London E-Scooter Trial in provision of parking facilities for operational use of fleet deployment by Operators and for customers to start and end their journeys in dedicated E-Scooter parking bays.
- (2) to facilitate the expansion of the number of E- Scooters being used as part of TfL London E-Scooter Trial, providing customers with a zero-emission micro mobility travel option in line with the Mayors transport strategy.
- (3) to facilitate dedicated parking spaces for rental e-cycles, providing customers with a zero-emission micro mobility travel option in line with the Mayors transport strategy and to provide dedicated bays for users to start and end their journeys.

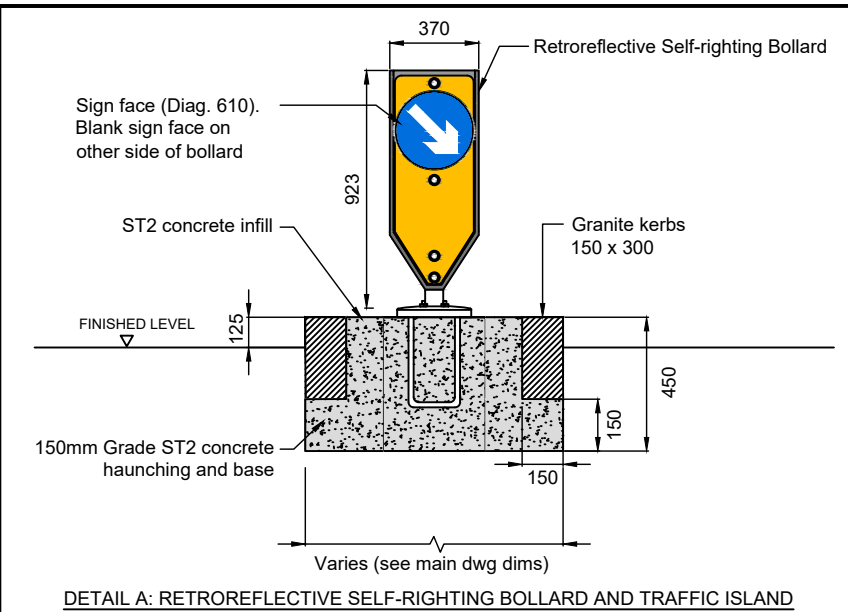

	Height	Width	Depth	Area	Diameter	Material
Bollard	923mm	370mm	90mm	-	-	-
Front Reflector	756mm	332mm	-	228,024mm <sup>2</sup>	-	Fluorescent Yellow
Side Reflector	504mm	51.5mm	-	25,872mm <sup>2</sup>	-	Fluorescent Yellow
Sign Face	-	-	-	-	300mm	-

TABLE A: BOLLARD DETAILS

- NOTES
- All designs to be in accordance with TfL Streetscape Guidance.
  - All lining and signing to be in accordance with the current Traffic Signs Regulations and General Directions (TSRGD) 2016.
  - All dimensions in metres, unless otherwise stated & measured to outside edge of road marking.
  - Road marking materials - formed in Thermoplastic road marking in accordance with BS EN 1871.
  - Drawing based on OS base or existing topographical surveys.
  - Existing road markings are indicative only & not accurate.
  - The contractor shall comply with the manual handling operations regulations 1992 as amended 2004.
  - All details to be checked on site by the supervising engineer.
  - The contractor shall be responsible for establishing the position and status of all statutory utility apparatus prior to commencing any works.
  - Excavations near any services are to be hand dug.
  - All items to be stored for reuse are to be protected and are the responsibility of the contractor until relocation.
  - Where traffic sign posts and foundations are being removed the contractor is to allow for the permanent reinstatement of the footway in materials that match the existing.
  - All proposed signs to set back a minimum of 450mm from the kerb face.
  - Refer to drawing BTPF0001-TFL-TRS-ZZ\_XX-DRG-TR-0001 for post and foundation details.
  - Refer to drawing BTPF0001-TFL-TRS-ZZ\_XX-DRG-TR-0002 for bollard and traffic island details.

KEY

Existing road marking

Existing lamp column

Existing gully

Existing cycle stand

Existing stats cover

TLRN boundary

Existing tree pit

Proposed road marking - White

Proposed kerb, bollard and traffic island surface course

Existing road marking to be removed with hydroblasting

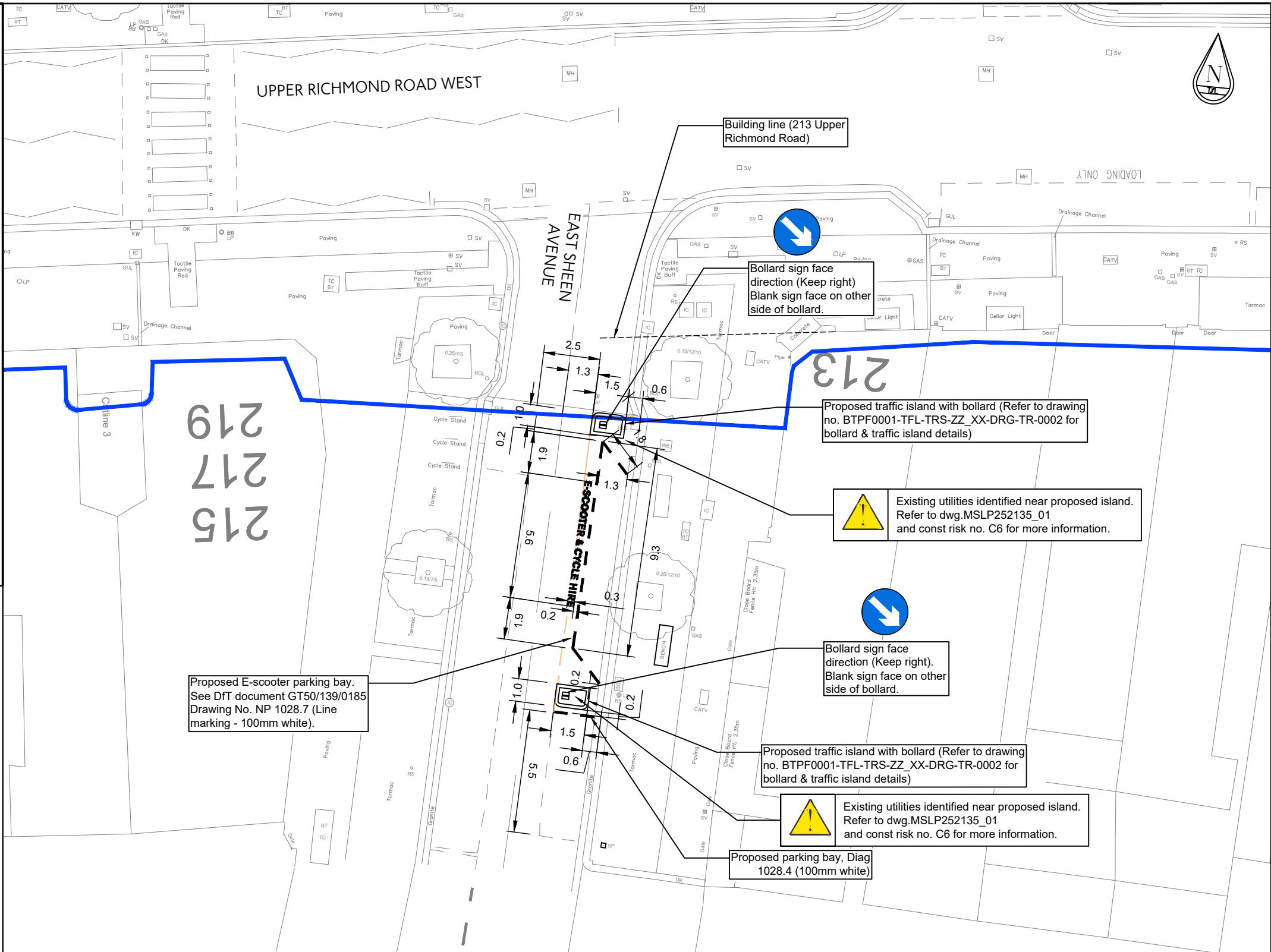

TfL RESTRICTED

C01	15-08-25	Construction issue	OG	TR	LP
rev	date	details	drn	chk	app

E-Scooter Parking Bay

East Sheen Avenue/ Upper Richmond Road

Batch 4

Project

Micromobility Parking Bays

Originator

Transport for London

Asset Classification

Traffic Signs & Road Markings

Location

Richmond upon Thames

Scale

1:200 @ A3

Sheet no

1 of 5

Transport for London

suitability

A

FOR CONSTRUCTION

revision

C01

drawing No

BTPF0001-TFL-120-24-04-DRG-TR-00001

© Crown copyright and database rights 2024 Ordnance Survey 100035971

FILE REF: \ONE\LONDON.TFL\LOCAL\SHARED\MYP\TDE\SCHEME INFORMATION\ALL AREAS\MICRO-MOBILITY\TLRN E-SCOOTER PARKING BAYS AND TH\06 DRAWINGS\01 WIP\DR\BATCH 4\RICHMOND UPON THAMES\120-24-04-DRG-TR-00001-01.dwg















	Height	Width	Depth	Area	Diameter	Material
Bollard	923mm	370mm	90mm	-	-	-
Front Reflector	756mm	332mm	-	228,024mm <sup>2</sup>	-	Fluorescen Yellow
Side Reflector	504mm	51.5mm	-	25,872mm <sup>2</sup>	-	Fluorescen Yellow
Sign Face	-	-	-	-	300mm	-

TABLE A: BOLLARD DETAILS

## NOTES

1. All designs to be in accordance with TFL Streetscape Guidance.
2. All lining and signing to be in accordance with the current Traffic Signs Regulations and General Directions (TSRGD) 2016.
3. All dimensions in metres, unless otherwise stated & measured to outside edge of road marking.
4. Road marking materials - formed in Thermoplastic road marking in accordance with BS EN 1871.
5. Drawing based on OS base or existing topographical surveys.
6. Existing road markings are indicative only & not accurate.
7. The contractor shall comply with the manual handling operations regulations 1992 as amended 2004.
8. All details to be checked on site by the supervising engineer.
9. The contractor shall be responsible for establishing the position and status of all statutory utility apparatus prior to commencing any works.
10. Excavations near any services are to be hand dug.
11. All items to be stored for reuse are to be protected and are the responsibility of the contractor until relocation.
12. Where traffic sign posts and foundations are being removed the contractor is to allow for the permanent reinstatement of the footway in materials that match the existing.
13. All proposed signs to set back a minimum of 450mm from the kerb face.
14. Refer to drawing BTPF0001-TFL-TRS-ZZ\_XX-DRG-TR-0001 for post and foundation details.
15. Refer to drawing BTPF0001-TFL-TRS-ZZ\_XX-DRG-TR-0002 for bollard and traffic island details.

KEY

- |  |  |  |  |
|--|--|--|--|
|     | Existing road marking                                    |     | Existing road marking to be removed with hydroblasting   |
| LC  | Existing lamp column                                     | RS  | Take up or down existing sign face (refer to drawing if sign face is to be set aside for re-use) |
| G   | Existing gully   |  |  |
|     | Existing cycle stand                                     |  |  |
|     | Existing stats cover                                     |  |  |
|     | TLRN boundary  |  |  |
|     | Existing tree pit  |  |  |
|     | Proposed road marking - White                            |  |  |
|     | Proposed kerb, bollard and traffic island surface course |  |  |
| SP  | Proposed sign and post                                   |  |  |

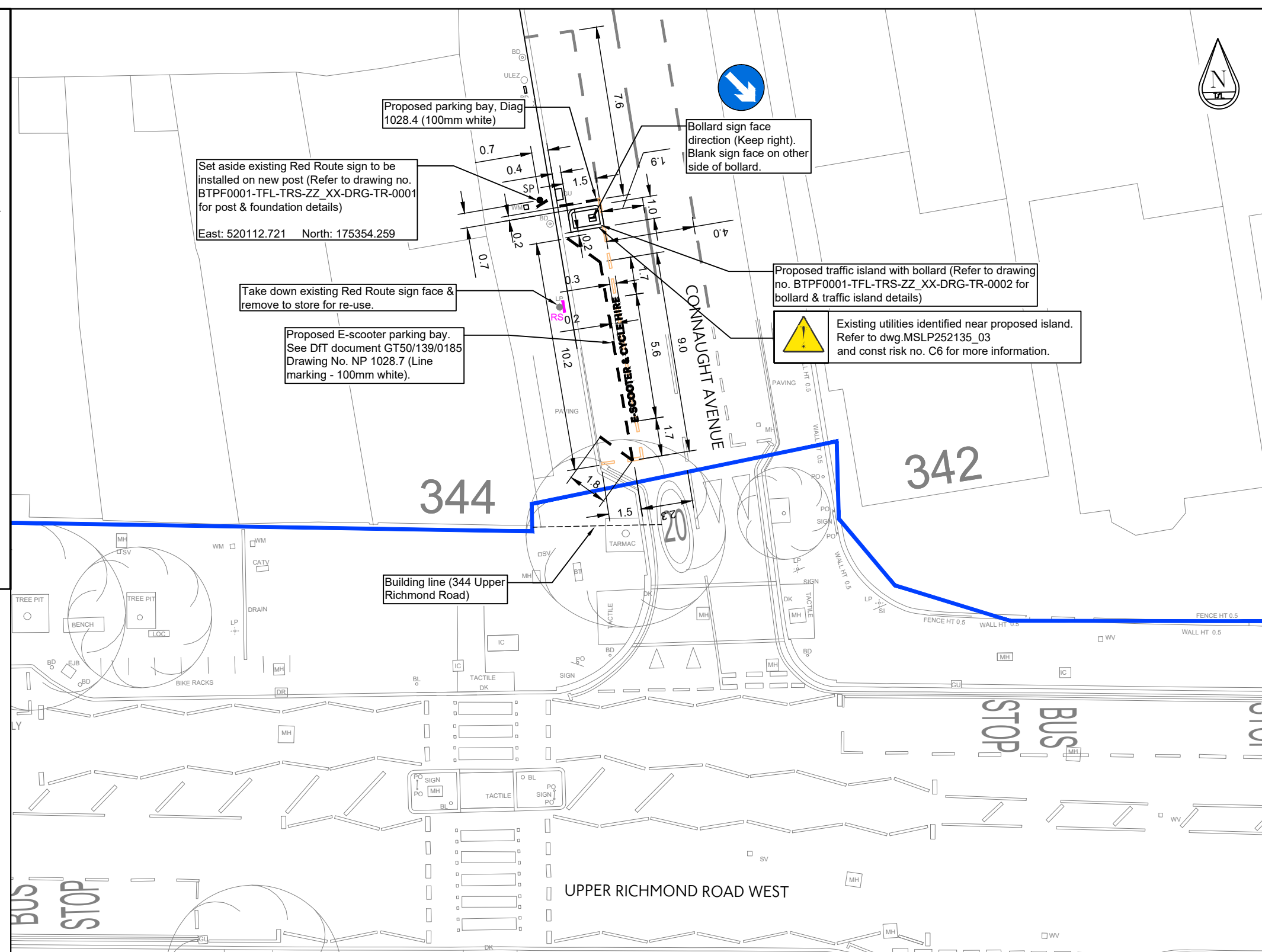

TfL RESTRICTED							Project		<div><div>Transport for London</div></div>		
							Micromobility Parking Bays				
							Originator				
	C01	15-08-25	Construction issue		OG	TR	LP	Transport for London			
	rev	date	details		drn	chk	app	Asset Classification			
	E-Scooter Parking Bay Connaught Avenue/ Upper Richmond Road Batch 4							Traffic Signs & Road Markings		<div><div>suitability</div><div>A</div><div>FOR CONSTRUCTION</div><div>revision</div><div>C01</div><div>drawing No</div><div>BTPF0001-TFL-120-24-04-DRG-TR-00002</div><div>© Crown copyright and database rights 2024 Ordnance Survey 100035971</div></div>	
Location											
Richmond upon Thames											
Scale		Sheet no									
1:200 @ A3		2 of 5									

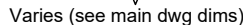

TABLE A: BOLLARD DETAILS

East: 519614.537    North: 175808.513

Existing gully grate to be removed & changed to 'Pedestrian friendly' D400 grate



Building line (Forsyth House, 211-217 Lower Richmond Road

LOWER RICHMOND ROAD

211 to 217

Existing road marking to be removed with hydroblasting

Take up or down & remove to approved licensed tip off site existing sign post & sign face (refer to drawing if sign face is to be set aside for re-use). Permanent reinstatement of footway to be undertaken in material that matches existing footway.

Take up or down & remove to approved licensed tip off site existing gully grate & re-install 'Pedestrian friendly' class D400 gully grating

© Crown copyright and database rights 2024 Ordnance Survey 100035971





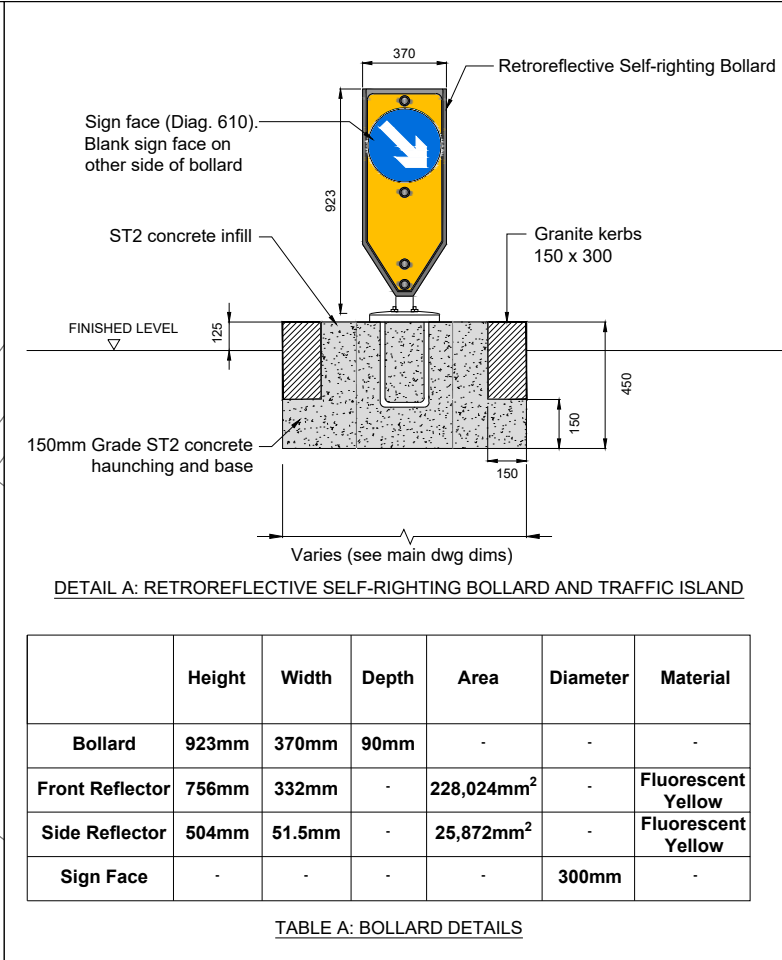
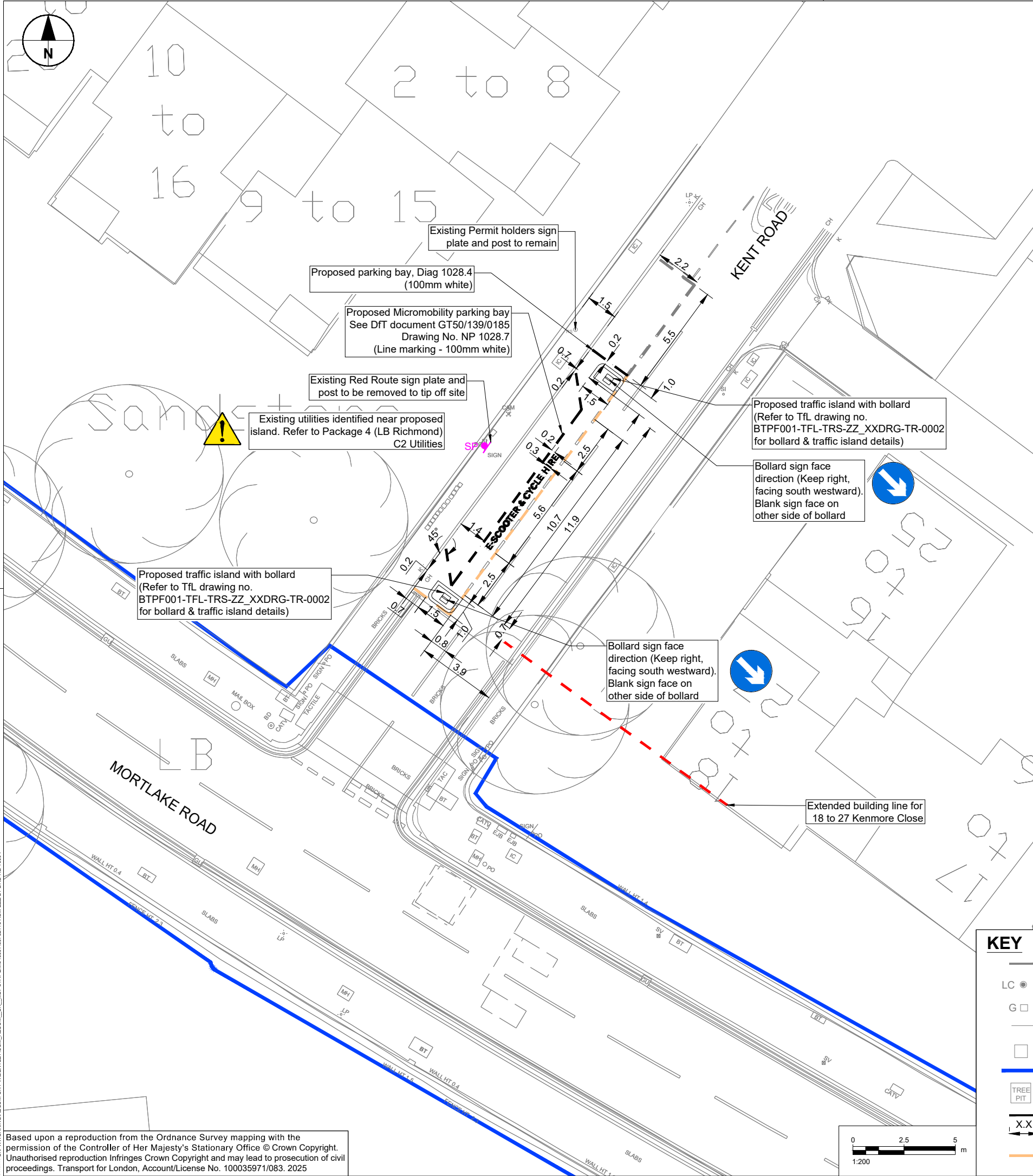

Safety, Health and Environmental Information Box

IT IS ASSUMED THAT ALL WORKS ON THIS DRAWING WILL BE CARRIED OUT BY A COMPETENT CONTRACTOR WORKING, WHERE APPROPRIATE, TO AN APPROPRIATE METHOD STATEMENT.

THIS DRAWING IS TO BE USED ONLY FOR THE PURPOSE OF ISSUE THAT IT WAS ISSUED FOR AND IS SUBJECT TO AMENDMENT.

EXCEPTIONAL RISKS RELATING TO THE WORKS ASSOCIATED WITH THIS DRAWING ARE IDENTIFIED BELOW.

NOTES

1. ALL DESIGNS TO BE IN ACCORDANCE WITH TFL STREETSCAPE GUIDANCE.

2. ALL LINING AND SIGNING TO BE IN ACCORDANCE WITH THE CURRENT TRAFFIC SIGNS REGULATIONS AND GENERAL DIRECTIONS (TSRGD) 2016.

3. ALL DIMENSIONS IN METRES, UNLESS OTHERWISE STATED & MEASURED TO OUTSIDE EDGE OF ROAD MARKING.

4. ROAD MARKING MATERIALS TO BE FORMED IN THERMOPLASTIC ACCORDANCE WITH BS EN 1871.

5. DRAWING BASED ON OS BASE OR EXISTING TOPOGRAPHICAL SURVEY.

6. EXISTING ROAD MARKINGS ARE INDICATIVE ONLY & NOT ACCURATE.

7. THE CONTRACTOR SHALL COMPLY WITH THE MANUAL HANDLING OPERATIONS REGULATIONS 1992 AS AMENDED 2004.

8. ALL DETAILS TO BE CHECKED ON SITE BY THE SUPERVISING ENGINEER PRIOR TO CONSTRUCTION.

9. THE CONTRACTOR SHALL BE RESPONSIBLE FOR ESTABLISHING THE POSITION AND STATUS OF ALL STATUTORY UTILITY APPARATUS PRIOR TO COMMENCING ANY WORKS.

10. EXCAVATIONS NEAR ANY SERVICES ARE TO BE HAND DUG.

11. ALL ITEMS TO BE STORED FOR REUSE ARE TO BE PROTECTED AND ARE THE RESPONSIBILITY OF THE CONTRACTOR UNTIL RELOCATION.

12. WHERE TRAFFIC SIGN POSTS AND FOUNDATIONS ARE BEING REMOVED THE CONTRACTOR IS TO ALLOW FOR THE PERMANENT REINSTATEMENT OF THE FOOTWAY IN MATERIALS THAT MATCH THE EXISTING.

13. ALL PROPOSED SIGNS AND STREET FURNITURE TO BE SET BACK A MINIMUM OF 450mm FROM THE KERB FACE.

14. REFER TO TFL DRAWING BTPF0001-TFL-TRS-ZZ\_XX-DRG-TR-0001 FOR POST AND FOUNDATION DETAILS.

15. REFER TO TFL DRAWING BTPF0001-TFL-TRS-ZZ\_XX-DRG-TR-0002 FOR BOLLARD AND TRAFFIC ISLAND DETAILS.

16. DO NOT SCALE FROM THIS DRAWING, USE FIGURED DIMENSIONS ONLY.

17. ALL ROAD SIGNS TO HAVE A MINIMUM MOUNTING HEIGHT OF 2400mm VERTICAL CLEARANCE.

18. SECTION 8 HIGHWAYS AGREEMENT MAY BE REQUIRED FOR CONSTRUCTION OUTSIDE OF THE TLRN.

19. LOCATION OF E-SCOOTER/E-BIKE PARKING BAY BASED ON THE LIST OF SITES ISSUED TO AECOM BY TFL IN MARCH 2025.

20. ITEMS IN GREY REPRESENT THE EXISTING LAYOUT AND INFRASTRUCTURE UNLESS OTHERWISE INDICATED.

First issue

SK

07/07/25

P01

Second issue

AP

22/07/25

P02

For Construction

AP

22/08/25

C01

REVISION DETAILS

By

Date

Suffix

Purpose of issue

App

Work stage authorized or accepted (See ISO19650-2)

Client

Transport For London

Palestra House

197 Blackfriars Road

London

SE1 8NJ

Project Title

MICROMOBILITY PARKING TLRN

Drawing Title

For Construction

London Borough of Richmond

Kent Road

Site Number 04

Designed

AP

Drawn

AP

Reviewed

KK

Approved

KK

Date

22/08/25

Internal Project No.

60752118

Subsidiarity

A1

Scale @ A3

1:200

Volume

General - Scheme Wide generic information

THIS DOCUMENT HAS BEEN PREPARED PURSUANT TO AND SUBJECT TO THE TERMS OF AECOM'S APPOINTMENT BY ITS CLIENT. AECOM ACCEPTS NO LIABILITY FOR ANY USE OF THIS DOCUMENT OTHER THAN BY ITS ORIGINAL CLIENT OR FOLLOWING AECOM'S EXPRESS AGREEMENT TO SUCH USE, AND ONLY FOR THE PURPOSES FOR WHICH IT WAS PREPARED AND PROVIDED.

AECOM

10 Brickel Road

St Albans

AL1 3JX, UK

Tel: +44 (0) 1727-53-5000

www.aecom.com

Project

60752118

Originator

-ACM

Volume

-ZZZ

Location

24

Type

-DRG-HE

Role

-10

Number

004

Rev

C01

KEY

- Existing road marking
- Existing lamp column
- Existing gully
- Existing cycle stand
- Existing stats cover
- TLRN boundary
- Existing tree pit
- Proposed road marking - White
- Setting out dimension
- Existing road marking to be removed

- Existing sign plate and post to be removed to approved licensed tip off site. Permanent reinstatement of footway to be undertaken in material that matches existing footway.
- Proposed kerb, bollard and traffic island
- Extended building line

Based upon a reproduction from the Ordnance Survey mapping with the permission of the Controller of Her Majesty's Stationary Office © Crown Copyright. Unauthorised reproduction infringes Crown Copyright and may lead to prosecution of civil proceedings. Transport for London, Account/License No. 100035971/083. 2025



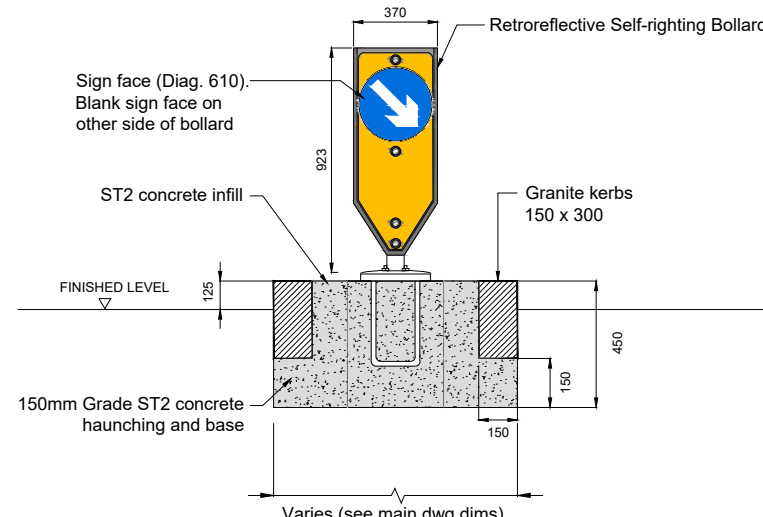
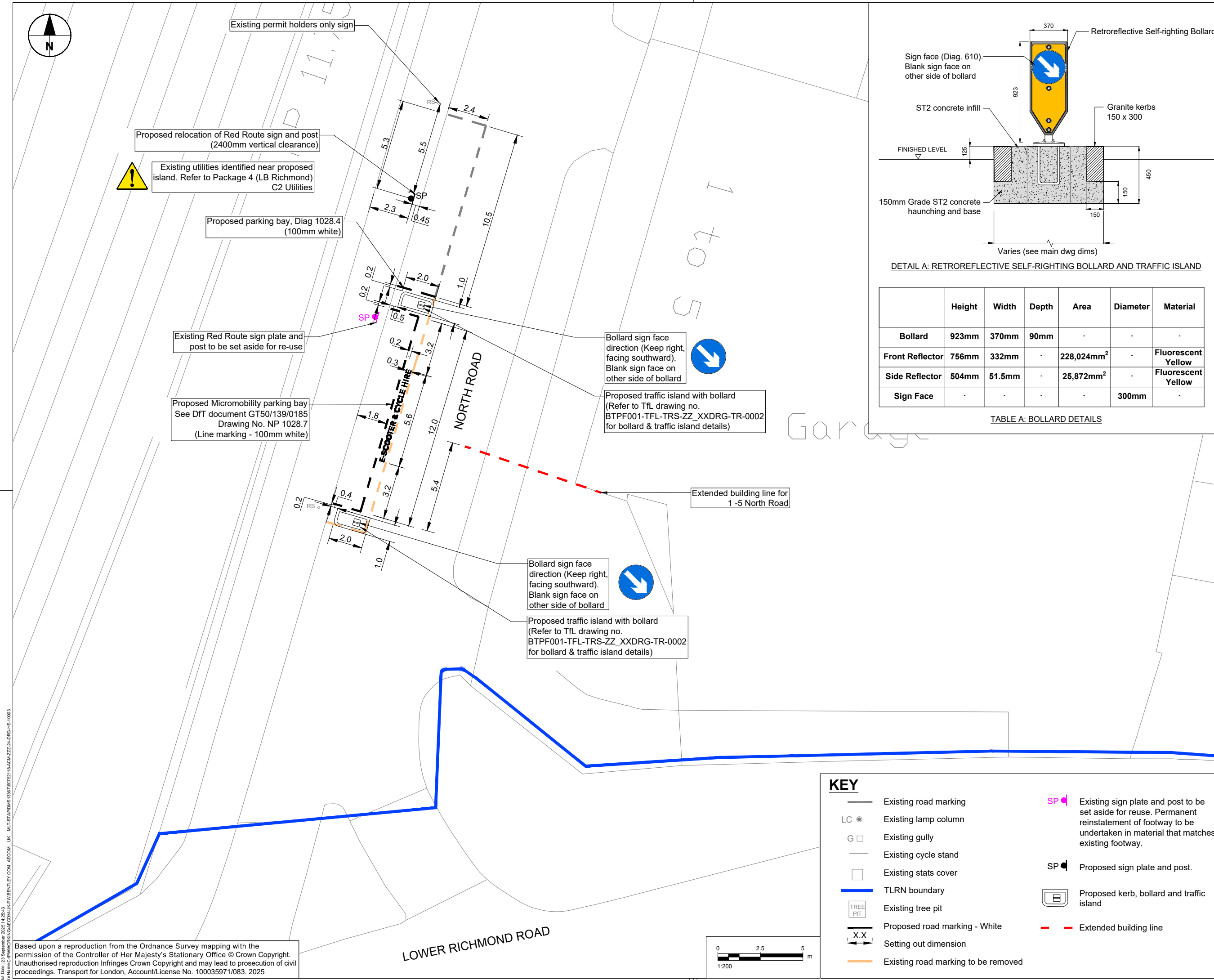

DETAIL A: RETROREFLECTIVE SELF-RIGHTING BOLLARD AND TRAFFIC ISLAND

	Height	Width	Depth	Area	Diameter	Material
Bollard	923mm	370mm	90mm	-	-	-
Front Reflector	756mm	332mm	-	228,024mm <sup>2</sup>	-	Fluorescent Yellow
Side Reflector	504mm	51.5mm	-	25,872mm <sup>2</sup>	-	Fluorescent Yellow
Sign Face	-	-	-	-	300mm	-

TABLE A: BOLLARD DETAILS

- SAFETY, HEALTH AND ENVIRONMENTAL INFORMATION BOX
- IT IS ASSUMED THAT ALL WORKS ON THIS DRAWING WILL BE CARRIED OUT BY A COMPETENT CONTRACTOR WORKING, WHERE APPROPRIATE, TO AN APPROPRIATE METHOD STATEMENT.
- THIS DRAWING IS TO BE USED ONLY FOR THE PURPOSE OF ISSUE THAT IT WAS ISSUED FOR AND IS SUBJECT TO AMENDMENT.
- EXCEPTIONAL RISKS RELATING TO THE WORKS ASSOCIATED WITH THIS DRAWING ARE IDENTIFIED BELOW.
- NOTES
1. ALL DESIGNS TO BE IN ACCORDANCE WITH TFL STREETSCAPE GUIDANCE.

2. ALL LINING AND SIGNING TO BE IN ACCORDANCE WITH THE CURRENT TRAFFIC SIGNS REGULATIONS AND GENERAL DIRECTIONS (TSRGD) 2016.

3. ALL DIMENSIONS IN METRES, UNLESS OTHERWISE STATED & MEASURED TO OUTSIDE EDGE OF ROAD MARKING.

4. ROAD MARKING MATERIALS TO BE FORMED IN THERMOPLASTIC ACCORDANCE WITH BS EN 1871.

5. DRAWING BASED ON OS BASE OR EXISTING TOPOGRAPHICAL SURVEY.

6. EXISTING ROAD MARKINGS ARE INDICATIVE ONLY & NOT ACCURATE.

7. THE CONTRACTOR SHALL COMPLY WITH THE MANUAL HANDLING OPERATIONS REGULATIONS 1992 AS AMENDED 2004.

8. ALL DETAILS TO BE CHECKED ON SITE BY THE SUPERVISING ENGINEER PRIOR TO CONSTRUCTION.

9. THE CONTRACTOR SHALL BE RESPONSIBLE FOR ESTABLISHING THE POSITION AND STATUS OF ALL STATUTORY UTILITY APPARATUS PRIOR TO COMMENCING ANY WORKS.

10. EXCAVATIONS NEAR ANY SERVICES ARE TO BE HAND DUG.

11. ALL ITEMS TO BE STORED FOR REUSE ARE TO BE PROTECTED AND ARE THE RESPONSIBILITY OF THE CONTRACTOR UNTIL RELOCATION.

12. WHERE TRAFFIC SIGN POSTS AND FOUNDATIONS ARE BEING REMOVED THE CONTRACTOR IS TO ALLOW FOR THE PERMANENT REINSTATEMENT OF THE FOOTWAY IN MATERIALS THAT MATCH THE EXISTING.

13. ALL PROPOSED SIGNS AND STREET FURNITURE TO BE SET BACK A MINIMUM OF 450mm FROM THE KERB FACE.

14. REFER TO TFL DRAWING BTPF0001-TFL-TRS-ZZ\_XX-DRG-TR-0001 FOR POST AND FOUNDATION DETAILS.

15. REFER TO TFL DRAWING BTPF0001-TFL-TRS-ZZ\_XX-DRG-TR-0002 FOR BOLLARD AND TRAFFIC ISLAND DETAILS.

16. DO NOT SCALE FROM THIS DRAWING, USE FIGURED DIMENSIONS ONLY.

17. ALL ROAD SIGNS TO HAVE A MINIMUM MOUNTING HEIGHT OF 2400mm VERTICAL CLEARANCE.

18. SECTION 8 HIGHWAYS AGREEMENT MAY BE REQUIRED FOR CONSTRUCTION OUTSIDE OF THE TLRN.

19. LOCATION OF E-SCOOTER/E-BIKE PARKING BAY BASED ON THE LIST OF SITES ISSUED TO AECOM BY TFL IN MARCH 2025.

20. ITEMS IN GREY REPRESENT THE EXISTING LAYOUT AND INFRASTRUCTURE UNLESS OTHERWISE INDICATED.

First issue	SK	07/07/25	P01
Second issue	AP	22/07/25	P02
For Construction	AP	22/08/25	C01
REVISION DETAILS	By	Date	Suffix
Purpose of issue	App		

Work stage authorized or accepted (See ISO19650-2)

Client  
Transport For London  
Palestra House  
197 Blackfriars Road  
London  
SE1 8NJ



Project Title  
**MICROMOBILITY PARKING TLRN**

Drawing Title  
**For Construction  
London Borough of Richmond  
North Road  
Site Number 03**

Designed AP	Drawn AP	Reviewed KK	Approved KK	Date 22/08/25
Internal Project No. 60752118	Suitability A1	Volume General - Scheme Wide generic information		
Scale @ A3 1:200				

THIS DOCUMENT HAS BEEN PREPARED PURSUANT TO AND SUBJECT TO THE TERMS OF AECOM'S APPOINTMENT BY ITS CLIENT. AECOM ACCEPTS NO LIABILITY FOR ANY USE OF THIS DOCUMENT OTHER THAN BY ITS ORIGINAL CLIENT OR FOLLOWING AECOM'S EXPRESS AGREEMENT TO SUCH USE, AND ONLY FOR THE PURPOSES FOR WHICH IT WAS PREPARED AND PROVIDED.

AECOM  
10 Bricket Road  
St Albans  
AL1 3JX, UK  
Tel: +44 (0) 1727-53-5000  
www.aecom.com



Drawing Number 60752118	I Originator -ACM	I Volume -ZZZ -	Rev C01
Project 24 -DRG-HE	I Role -10	I MCHW 003	
Location	I Type	I Number	

Rev Data: 21 September 2025 14:25:03  
Rev Name: C:\WORKING\BENTLEY\COM\_AECOM\_UK\_ML-STARPUS1336760752118-ACM\ZZ-24-DRG-HE-0003

Based upon a reproduction from the Ordnance Survey mapping with the permission of the Controller of Her Majesty's Stationary Office © Crown Copyright. Unauthorised reproduction infringes Crown Copyright and may lead to prosecution of civil proceedings. Transport for London, Account/License No. 100035971/083. 2025

KEY

Existing road marking

Existing lamp column

Existing gully

Existing cycle stand

Existing stats cover

TLRN boundary

Existing tree pit

Proposed road marking - White

Setting out dimension

Existing road marking to be removed

Existing sign plate and post to be set aside for reuse. Permanent reinstatement of footway to be undertaken in material that matches existing footway.

Proposed sign plate and post.

Proposed kerb, bollard and traffic island

Extended building line

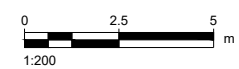

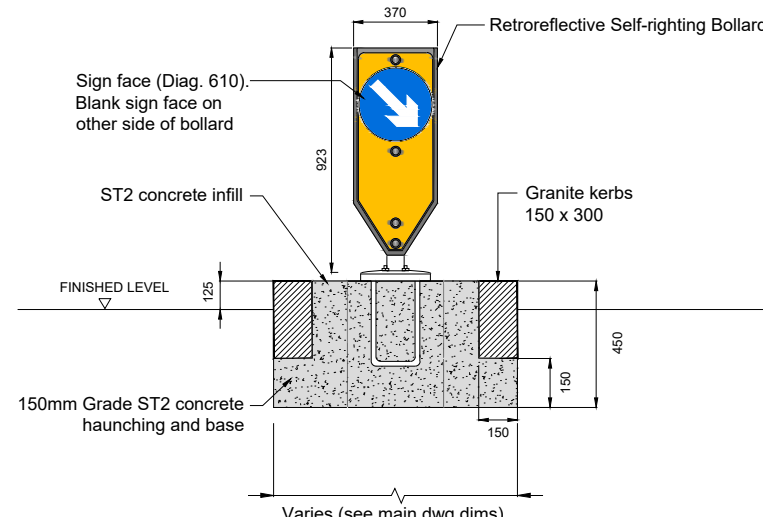
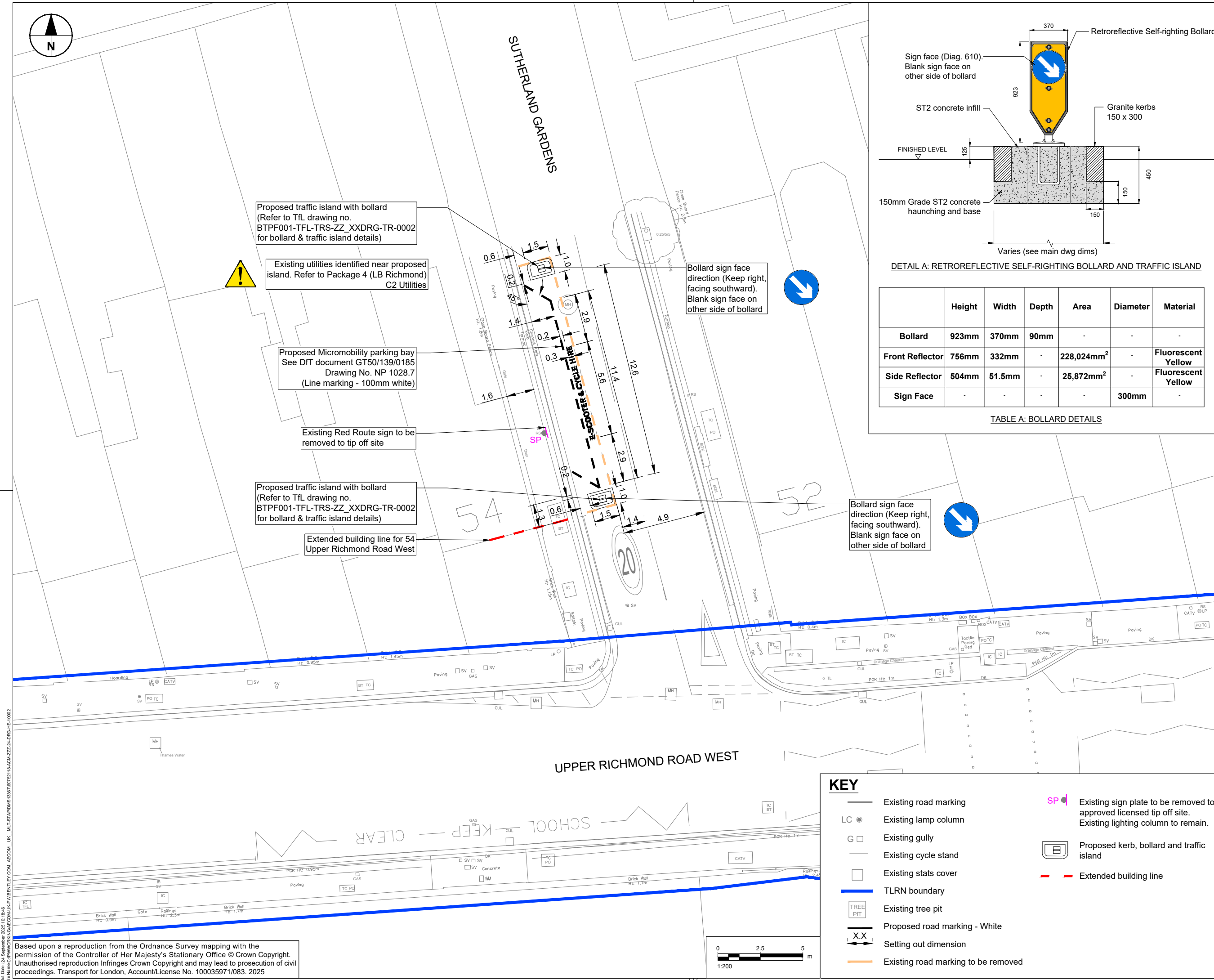

DETAIL A: RETROREFLECTIVE SELF-RIGHTING BOLLARD AND TRAFFIC ISLAND

	Height	Width	Depth	Area	Diameter	Material
Bollard	923mm	370mm	90mm	-	-	-
Front Reflector	756mm	332mm	-	228,024mm <sup>2</sup>	-	Fluorescent Yellow
Side Reflector	504mm	51.5mm	-	25,872mm <sup>2</sup>	-	Fluorescent Yellow
Sign Face	-	-	-	-	300mm	-

TABLE A: BOLLARD DETAILS

- SAFETY, HEALTH AND ENVIRONMENTAL INFORMATION BOX**

IT IS ASSUMED THAT ALL WORKS ON THIS DRAWING WILL BE CARRIED OUT BY A COMPETENT CONTRACTOR WORKING, WHERE APPROPRIATE, TO AN APPROPRIATE METHOD STATEMENT.

THIS DRAWING IS TO BE USED ONLY FOR THE PURPOSE OF ISSUE THAT IT WAS ISSUED FOR AND IS SUBJECT TO AMENDMENT.

EXCEPTIONAL RISKS RELATING TO THE WORKS ASSOCIATED WITH THIS DRAWING ARE IDENTIFIED BELOW.
- NOTES**

  - ALL DESIGNS TO BE IN ACCORDANCE WITH TFL STREETSCAPE GUIDANCE.
  - ALL LINING AND SIGNING TO BE IN ACCORDANCE WITH THE CURRENT TRAFFIC SIGNS REGULATIONS AND GENERAL DIRECTIONS (TSRGD) 2016.
  - ALL DIMENSIONS IN METRES, UNLESS OTHERWISE STATED & MEASURED TO OUTSIDE EDGE OF ROAD MARKING.
  - ROAD MARKING MATERIALS TO BE FORMED IN THERMOPLASTIC ACCORDANCE WITH BS EN 1871.
  - DRAWING BASED ON OS BASE OR EXISTING TOPOGRAPHICAL SURVEY.
  - EXISTING ROAD MARKINGS ARE INDICATIVE ONLY & NOT ACCURATE.
  - THE CONTRACTOR SHALL COMPLY WITH THE MANUAL HANDLING OPERATIONS REGULATIONS 1992 AS AMENDED 2004.
  - ALL DETAILS TO BE CHECKED ON SITE BY THE SUPERVISING ENGINEER PRIOR TO CONSTRUCTION.
  - THE CONTRACTOR SHALL BE RESPONSIBLE FOR ESTABLISHING THE POSITION AND STATUS OF ALL STATUTORY UTILITY APPARATUS PRIOR TO COMMENCING ANY WORKS.
  - EXCAVATIONS NEAR ANY SERVICES ARE TO BE HAND DUG.
  - ALL ITEMS TO BE STORED FOR REUSE ARE TO BE PROTECTED AND ARE THE RESPONSIBILITY OF THE CONTRACTOR UNTIL RELOCATION.
  - WHERE TRAFFIC SIGN POSTS AND FOUNDATIONS ARE BEING REMOVED THE CONTRACTOR IS TO ALLOW FOR THE PERMANENT REINSTATEMENT OF THE FOOTWAY IN MATERIALS THAT MATCH THE EXISTING.
  - ALL PROPOSED SIGNS AND STREET FURNITURE TO BE SET BACK A MINIMUM OF 450mm FROM THE KERB FACE.
  - REFER TO TFL DRAWING BTPF0001-TFL-TRS-ZZ\_XX-DRG-TR-0001 FOR POST AND FOUNDATION DETAILS.
  - REFER TO TFL DRAWING BTPF0001-TFL-TRS-ZZ\_XX-DRG-TR-0002 FOR BOLLARD AND TRAFFIC ISLAND DETAILS.
  - DO NOT SCALE FROM THIS DRAWING, USE FIGURED DIMENSIONS ONLY.
  - ALL ROAD SIGNS TO HAVE A MINIMUM MOUNTING HEIGHT OF 2400mm VERTICAL CLEARANCE.
  - SECTION 8 HIGHWAYS AGREEMENT MAY BE REQUIRED FOR CONSTRUCTION OUTSIDE OF THE TLRN.
  - LOCATION OF E-SCOOTER/E-BIKE PARKING BAY BASED ON THE LIST OF SITES ISSUED TO AECOM BY TFL IN MARCH 2025.
  - ITEMS IN GREY REPRESENT THE EXISTING LAYOUT AND INFRASTRUCTURE UNLESS OTHERWISE INDICATED.

First issue	SK	07/07/25	P01
Second issue	AP	22/07/25	P02
For Construction	AP	22/08/25	C01
REVISION DETAILS			
Purpose of issue	By	Date	Suffix
	App		

Work stage authorized or accepted (See ISO19650-2)

Client  
Transport For London  
Palestra House  
197 Blackfriars Road  
London  
SE1 8NJ

**MICROMOBILITY PARKING TLRN**

**For Construction**  
**London Borough of Richmond**  
**Sutherland Gardens**  
**Site Number 02**

Designed AP	Drawn AP	Reviewed KK	Approved KK	Date 22/08/25
Internal Project No. 60752118		Suitability A1		
Scale @ A3 1:200		Volume General - Scheme Wide generic information		

THIS DOCUMENT HAS BEEN PREPARED PURSUANT TO AND SUBJECT TO THE TERMS OF AECOM'S APPOINTMENT BY ITS CLIENT. AECOM ACCEPTS NO LIABILITY FOR ANY USE OF THIS DOCUMENT OTHER THAN BY ITS ORIGINAL CLIENT OR FOLLOWING AECOM'S EXPRESS AGREEMENT TO SUCH USE, AND ONLY FOR THE PURPOSES FOR WHICH IT WAS PREPARED AND PROVIDED.

AECOM  
10 Bricket Road  
St Albans  
AL1 3JX, UK  
Tel: +44 (0) 1727-53-5000  
www.aecom.com

Drawing Number 60752118	I Originator -ACM	I Volume -ZZZ -	Rev C01
Project 24 -DRG-HE	I Role -10	I MCHW 002	
Location	I Type	I Number	

**KEY**

- Existing road marking
- Existing lamp column
- Existing gully
- Existing cycle stand
- Existing stats cover
- TLRN boundary
- Existing tree pit
- Proposed road marking - White
- Setting out dimension
- Existing road marking to be removed

Existing sign plate to be removed to approved licensed tip off site. Existing lighting column to remain.

Proposed kerb, bollard and traffic island

Extended building line

Rev Data: 21 September 2025 15:08:45  
Rev Name: C:\P\WORKING\AECOM\UK\PEWENTLEY\COM\_AECOM\_UK\_ML-STAPOLIS\3367607\52118-ACM\ZZZ-24-DRG-HE-0002

Based upon a reproduction from the Ordnance Survey mapping with the permission of the Controller of Her Majesty's Stationary Office © Crown Copyright. Unauthorised reproduction infringes Crown Copyright and may lead to prosecution of civil proceedings. Transport for London, Account/License No. 100035971/083. 2025