

ROAD TRAFFIC REGULATION ACT 1984 – SECTION 6

THE LONDON BOROUGH OF RICHMOND UPON THAMES (FREE PARKING PLACES)
(PEOPLE WITH DISABILITIES) (AMENDMENT No. 36) ORDER 2013

DISABLED PERSONS PARKING BAYS
VARIOUS STREETS THROUGHOUT THE BOROUGH
(Reference 13/122)

1. The Council of the London Borough of Richmond upon Thames has made the above Order under sections 6 and 124 of, and Part IV of Schedule 9 to, the Road Traffic Regulation Act 1984, as amended.
2. The principal objective of the Order is to introduce a number of parking places for disabled persons where a high level of parking makes reasonable means of access difficult and to discontinue a number of similar parking places previously provided where the demand for such bays no longer exists.
3. The Order will introduce a parking bay for disabled persons' vehicles, operating "at any time" in the following streets in the vicinity of the properties indicated:

Clavering Avenue, Barnes (extension of existing);* ¹ 8 Eastbank Road, Hampton Hill; 6 Edgar Road, Houslow; 155 Haliburton Road, St Margarets;	12 Marlow Crescent, Twickenham; 71 Nelson Gardens, Whitton; Riverview Gardens, Barnes;* ² 2 South Road, Hampton; and Warren Avenue, Richmond.* ³
---	--

*¹ along the south-western boundary of 21-30 Castlenau Mansions
*² outside 25-30 Riverview Gardens
*³ along the eastern boundary of 436 Upper Richmond Road
4. The Order will revoke the existing parking bay for disabled persons vehicles in the vicinity of each of the following locations:

12a Cambridge Cottages, Kew; 72 The Green, Twickenham 40 Grimwood Road, Twickenham 2 Norfolk Close, Twickenham; 4 Oldfield Road, Hampton;	1-6 Riverview Gardens, Barnes (reduction of one bay); 37-44 Riverview Gardens, Barnes; 40 St Winifred's Road, Teddington; and 17 Windsor Road, Teddington.
---	---
5. Copies of this Order, which will come into operation on 7 September 2013, a plan showing the locations and effect of the Order and the Council's Statement of Reasons for proposing to make the Order can, for a period of six weeks from the date of this Notice, quoting Reference 13/122:-
 - (a) be inspected, at the Civic Centre Reception, 44 York Street, Twickenham TW1 3BZ between 9.15am and 5pm on Mondays to Fridays, except for Bank and other public holidays; and
 - (b) be viewed on the Council's website at http://www.richmond.gov.uk/traffic_management_orders.htm
6. Copies of this Order may be purchased from the Environment Directorate, Civic Centre, 44 York Street, Twickenham TW1 3BZ.
7. Persons wishing to question the validity of this Order or any of its provisions on the grounds that it or they are not within the powers conferred by the 1984 Act, or that

any requirement of the Act or any instrument made under the Act has not been complied with that person may, within six weeks from the date on which the Order was made, apply for the purpose to the High Court.

ANDREW DARVILL
Assistant Director, Traffic and Transport
Civic Centre, 44 York Street, Twickenham TW1 3BZ

Dated 6 September 2013



"This map is reproduced from Ordnance Survey material with the permission of the Controller of Her Majesty's Stationery Office © Crown copyright. Unauthorised reproduction infringes Crown copyright and may lead to prosecution or civil proceedings 100019441 [2012]."

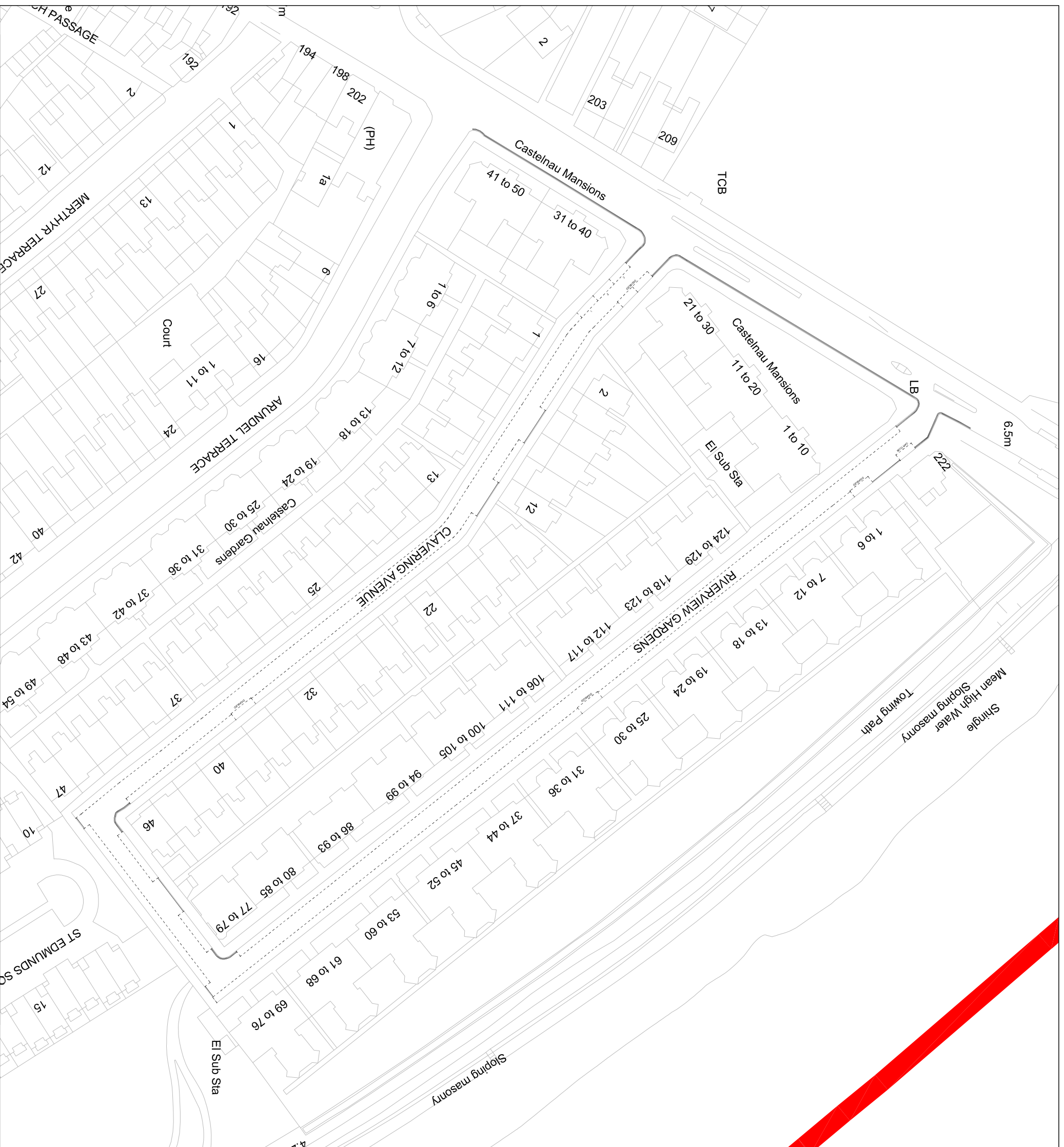

REVISION	A	-	AMENDMENT	AP	10/07/13	AP	10/07/13	MP	10/07/13	MT	10/07/13	
				DRAWN BY	AND DATE	DESIGNED BY	AND DATE	CHECKED BY	AND DATE	APPROVED BY	AND DATE	
				DRAFT	<input checked="" type="checkbox"/>	ISSUE	<input checked="" type="checkbox"/>	SCALE (AT A3 SIZE)				
				1:1000								
CLIENT	LONDON BOROUGH OF RICHMOND UPON THAMES											
PROJECT	RIVERVIEW GARDENS											
DRAWING TITLE	DISABLED PARKING BAYS PROPOSED											
ISSUING OFFICE	TWICKENHAM	DRAWING NUMBER	2288_03_PR_GL_477191									REVISION
TELEPHONE	020 88911411										A	



LONDON BOROUGH OF RICHMOND UPON THAMES

"This map is reproduced from Ordnance Survey material with the permission of the Controller of Her Majesty's Stationery Office © Crown copyright. Unauthorised reproduction infringes Crown copyright and may lead to prosecution or civil proceedings 100019441 [2013]."

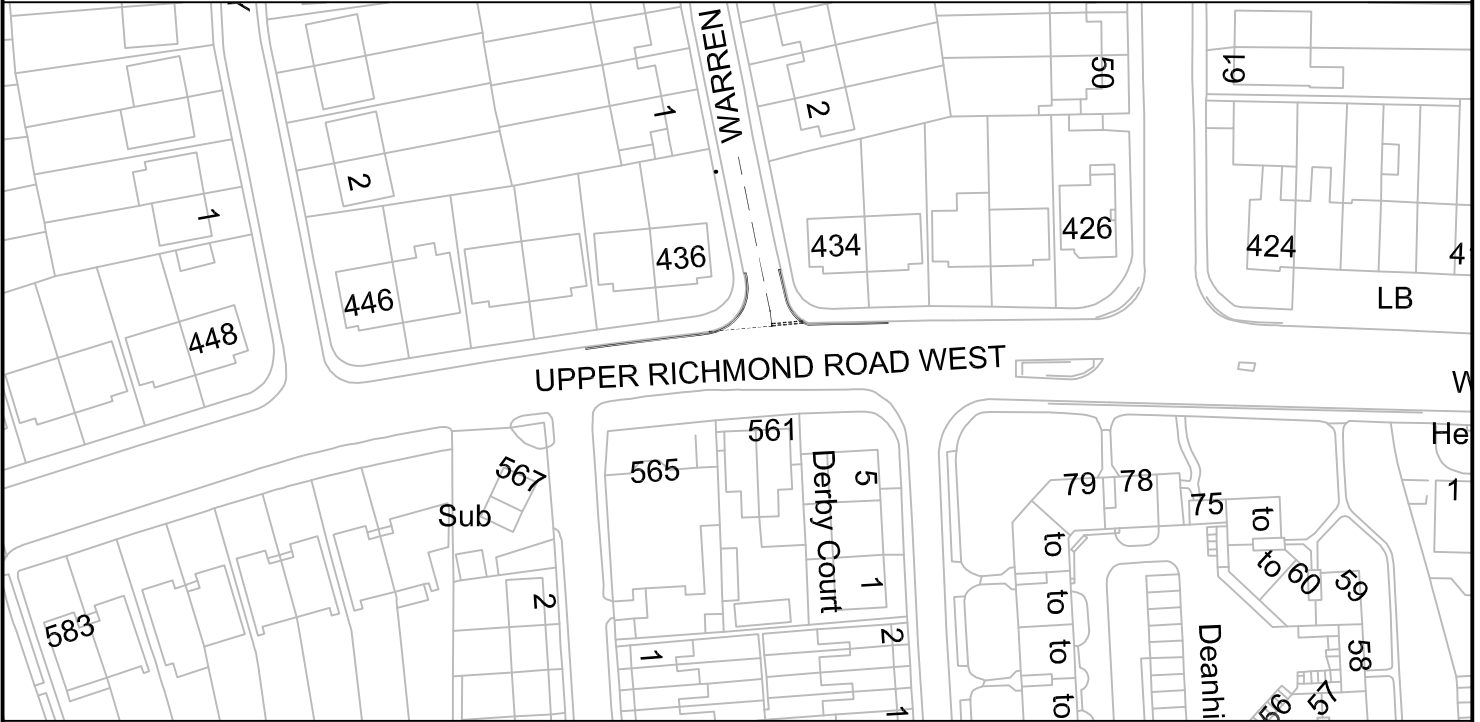

LOCATION PLAN – SCALE 1:1250

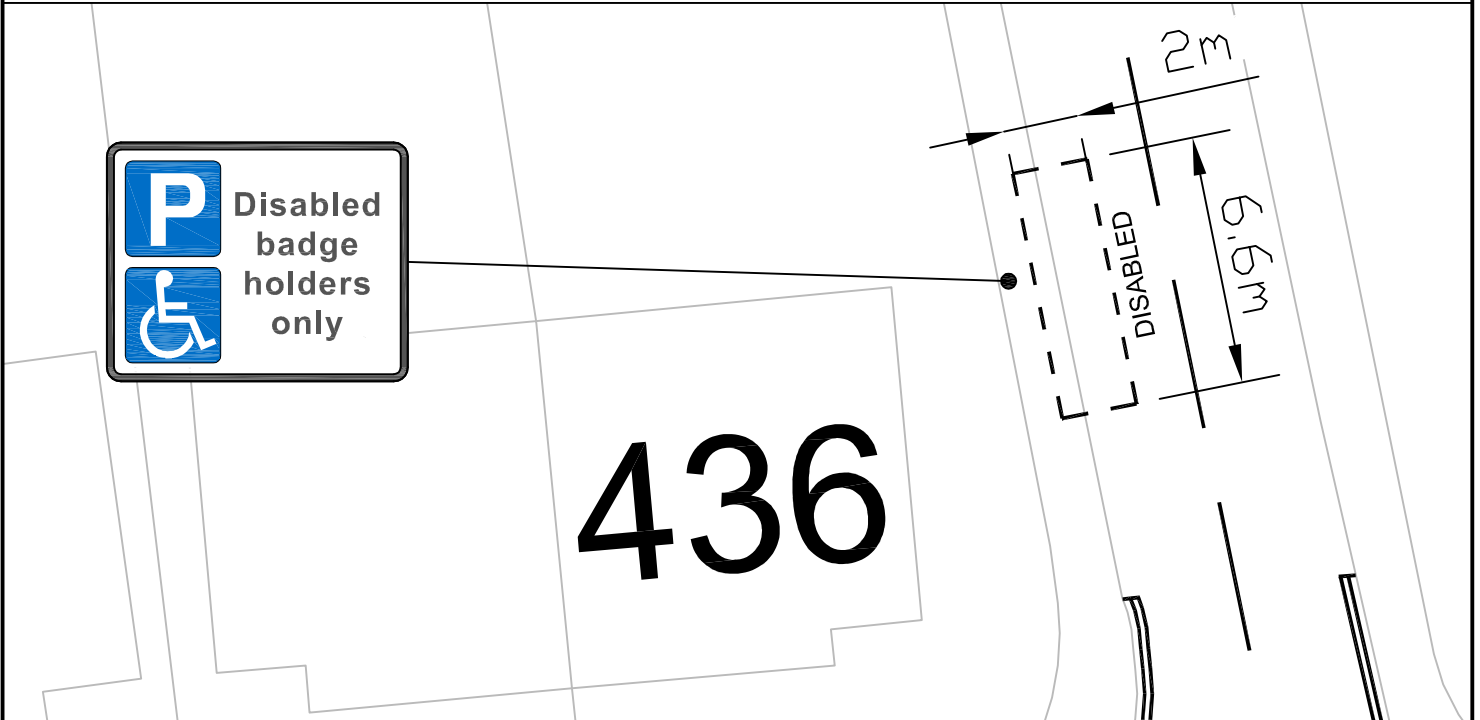

LAYOUT PLAN – SCALE 1:200



CLIENT LONDON BOROUGH OF RICHMOND UPON THAMES

PROJECT DISABLED PARKING BAY

DRAWING TITLE WARREN AVENUE, RICHMOND

A	AP 05/06/13	AP 05/06/13	MP 05/06/13	MT 05/06/13	Issue <input checked="" type="checkbox"/>	Draft <input checked="" type="checkbox"/>
REVISION	DRAWN BY & DATE	DESIGNED BY & DATE	CHECKED BY & DATE	APPROVED BY & DATE	Scale (at A4 size) VARIOUS	

ISSUING OFFICE TWICKENHAM

TELEPHONE 020 88911411

DRAWING NUMBER 2288_03_PR_GL_476840

REVISION A

TRAFFIC MANAGEMENT ORDER

THE LONDON BOROUGH OF RICHMOND UPON THAMES (FREE PARKING PLACES) (PEOPLE WITH DISABILITIES) (AMENDMENT No. 36) ORDER 2013

Made: 4 September 2013

Coming into operation: 7 September 2013

The Council of the London Borough of Richmond upon Thames, having consulted the Commissioner of Police of the Metropolis, in exercise of the powers conferred by Sections 6 and 124 of, and Part IV of Schedule 9 to, the Road Traffic Regulation Act 1984(a), as amended, and all other enabling powers hereby make the following Order—

1. This Order shall come into operation on 7 September 2013 and may be cited as the London Borough of Richmond upon Thames (Free Parking Places) (People with Disabilities) (Amendment No. 36) Order 2013.
2.
 - (1) In this Order the expression “enactment” means any enactment whether public, general or local and includes any order, bye-law, rule, regulation, scheme or other instrument having effect by virtue of an enactment.
 - (2) Any reference in this Order to any enactment shall be construed as a reference to that enactment as amended, applied, consolidated, re-enacted by or as having effect by virtue of any subsequent enactment.
 - (3) The Interpretation Act 1978(b) shall apply for the interpretation of this Order as it applies for the interpretation of an Act of Parliament.
3. Without prejudice to the validity of anything done or to any liability incurred in respect of any act or omission before the coming into operation of this Order, the London Borough of Richmond upon Thames (Free Parking Places) (People with Disabilities) Order 2007(c), as amended, shall have effect as though
 - (a) there were added to the items in Schedule 2 to that Order the items numbered 42A, 273, 274, 275, 276, 277, 279 and 280 and as set out in columns 1, 2, 3 and 4 of Schedule 1 to this Order; and
 - (b) the items in Schedule 2 to that Order numbered 32B, 89, 90B, 172, 178, 199, 200, 210 and 267A and as set out in Schedule 2 to this Order were revoked.

Dated 4 September 2013

Assistant Director, Traffic and Transport
(The officer appointed for this purpose)

(a) 1984 c. 27. (b) 1978 c.30.
(c) 2007/1 – the relevant amending order is 2012/11.

SCHEDULE 1
(see Article 3(a))

ITEMS TO BE ADDED TO SCHEDULE 2 [to 2007/1]

1 Item No.	2 Street	3 Permitted hours (see Schedule 1) [to 2007/1]	4 Special manner of standing
42A	Clavering Avenue, Barnes: the north-east side, from the existing disabled parking bay, an extension west for 4.4m, the resulting bay to be divided into two bays of 5.5m each with the double yellow lines commensurately reduced by 4.4m.	A	
273	Eastbank Road, Hampton Hill: the east side, from a point opposite the common boundary of 7 and 8 Eastbank Road north for a distance of 6.6 metres.	A	-
274	Edgar Road, Hounslow: the south side, from a point 5 metres west of a point opposite the western edge of No 6 Edgar Road westwards for a distance of 6.6 metres.	A	-
275	Haliburton Road, St Margarets: the west side, from a point opposite the common boundary of Nos 155 and 153 Haliburton Road southwards for a distance of 6.6 metres.	A	-
276	Melville Road, Barnes: the north side, from a point opposite the eastern boundary of the No 41 Melville Road and the passage, eastwards for a distance of 6.6 metres.	A	-
277	Marlow Crescent, Twickenham: the east side, from a point 1 metre north of a point opposite the common boundary of Nos 10 and 12 Marlow Crescent northwards for a distance of 5.4 metres.	A	-
279	Riverview Gardens, Barnes: the north-east side, from a point opposite the southern edge of the access pathway of Nos 25-30 Riverview Gardens south-eastwards for a distance of 6.6 metres.	A	-
280	South Road, Hampton: the north-west side, from a point 3.5m east from the common boundary of 2 and 4 South Road for a distance of 6.6 metres.	A	-

1 Item No.	2 Street	3 Permitted hours (see Schedule 1) [to 2007/1]	4 Special manner of standing
281	Warren Avenue, Richmond: the west side, from a point 5m north of the end of the double yellow lines northwards for a distance of 6.6 metres.	A	With two wheels resting on the footway

SCHEDULE 2
(see Article 3(b))

ITEMS TO BE REVOKED FROM SCHEDULE 2 [to 2007/1]

1 Item No.	2 Street	3 Permitted hours (see Schedule 1) [to 2007/1]	4 Special manner of standing
32B	Cambridge Cottages, Kew: the south-west side of the part of Cambridge Cottages which links the access to Nos 1-12 and the cul-de-sac serving Nos 13-36, from a point 4.6 metres north-west of the north-western kerb-line of the principal access link from Kew Green north-westwards for a distance of 5.8 metres.	A	-
89	Green The, Twickenham: the south side, from a point 2 metres east of the extended common boundary of Nos 78 and 80 The Green eastwards for a distance of 5.4 metres.	A	-
90B	Grimwood Road, Twickenham: the south-east side, from a point 2 metres south-west of the north-eastern boundary of No. 40 Grimwood Road south-westwards for a distance of 5 metres.	A	-
172	Norfolk Close, Twickenham: the south-west side, from a point opposite the party wall of Nos 3 and 4 Norfolk Close north-eastwards for a distance of 6 metres.	A	-
178	Oldfield Road, Hampton: the west side, from a point opposite the common boundary of Nos 2 and 4 Oldfield Road southwards for a distance of 6 metres.	A	-
199	Riverview Gardens, Barnes: the north-east side, from a point opposite the north-western flank wall of Nos 1 and 6 Riverview Gardens south-eastwards, the first bay of 6 metres to be retained, the second bay of 6 metres to be removed.	A	-
200	Riverview Gardens, Barnes: the north-east side, from a point 10 metres south-east of the common boundary of Nos 31/36 and 37/44 Riverview Gardens south-eastwards for a distance of 6.6 metres.	A	-
210	St Winifreds Road, Teddington: the south-east side, from the party wall of Nos 40 and 42 St Winifred's Road south-westwards for a distance of 6 metres.	A	-

SCHEDULE 2
(see Article 3(b))

ITEMS TO BE REVOKED FROM SCHEDULE 2 [to 2007/1]

1 Item No.	2 Street	3 Permitted hours (see Schedule 1) [to 2007/1]	4 Special manner of standing
267A	Windsor Road, Teddington: the south side, from a point opposite the common boundary of Nos 17 and 19 Windsor Road eastwards for a distance of 6.6 metres.	A	-

EXPLANATORY NOTE

(This Note is not part of the Order but is intended to indicate its general purport.)

This Order introduces 10 additional parking bays for people with disabilities to operate “at any time”, and revokes 9 similar bays which are no longer required.

The London Borough of Richmond upon Thames (Free Parking Places) (People with Disabilities) (Amendment No. 36) Order 2013

STATEMENT OF REASONS FOR PROPOSING TO MAKE THIS ORDER

- 1 Under delegated powers additional parking bays are proposed to be introduced for the exclusive use of Blue Badge holders who meet the criteria approved by the Transport Sub-Committee on 22 July 1996 and for any other vehicle displaying a valid disabled person’s badge issued by a Local Authority.

The bays are situated:-

- (i) alongside Castlenau Mansions in Clavering Avenue, Barnes;
- (ii) outside No 8 Eastbank Road, Hampton Hill;
- (iii) outside No 16 Edgar Road, Hounslow;
- (iv) outside 155 Haliburton Road, St Margarets;
- (v) outside No 12 Marlow Crescent, Twickenham;
- (vi) outside No 39 Melville Road, Barnes;
- (vii) outside 25-30 Riverview Gardens, Barnes;
- (viii) outside No 2 South Road, Hampton; and
- (ix) in Warren Avenue, Richmond, alongside the flank of No 436 Upper Richmond Road West.

and will be in operation at all times.

- 2 The Council is also proposing to revoke or discontinue the use of the following bays, where there is no longer any demand for their use:-

- (i) outside No 12a Cambridge Cottages, Kew;
- (ii) outside No 72 The Green, Twickenham;
- (iii) outside No 40 Grimwood Road, Twickenham;
- (iv) outside No 2 Norfolk Close, Twickenham;
- (v) outside No 4 Oldfield Road, Hampton;
- (vi) outside No 1-6 Riverview Gardens, Barnes (1 bay);
- (vii) outside No 37-44 Riverview Gardens, Barnes;
- (viii) outside No 40 St Winifred’s Road, Teddington; and
- (ix) outside No. 17 Windsor Road, Teddington.

*This map is reproduced from Ordnance Survey material with the permission of the Controller of Her Majesty's Stationery Office
 © Crown copyright. Unauthorised reproduction infringes Crown copyright and may lead to prosecution or civil proceedings
 100019441 [2013].*

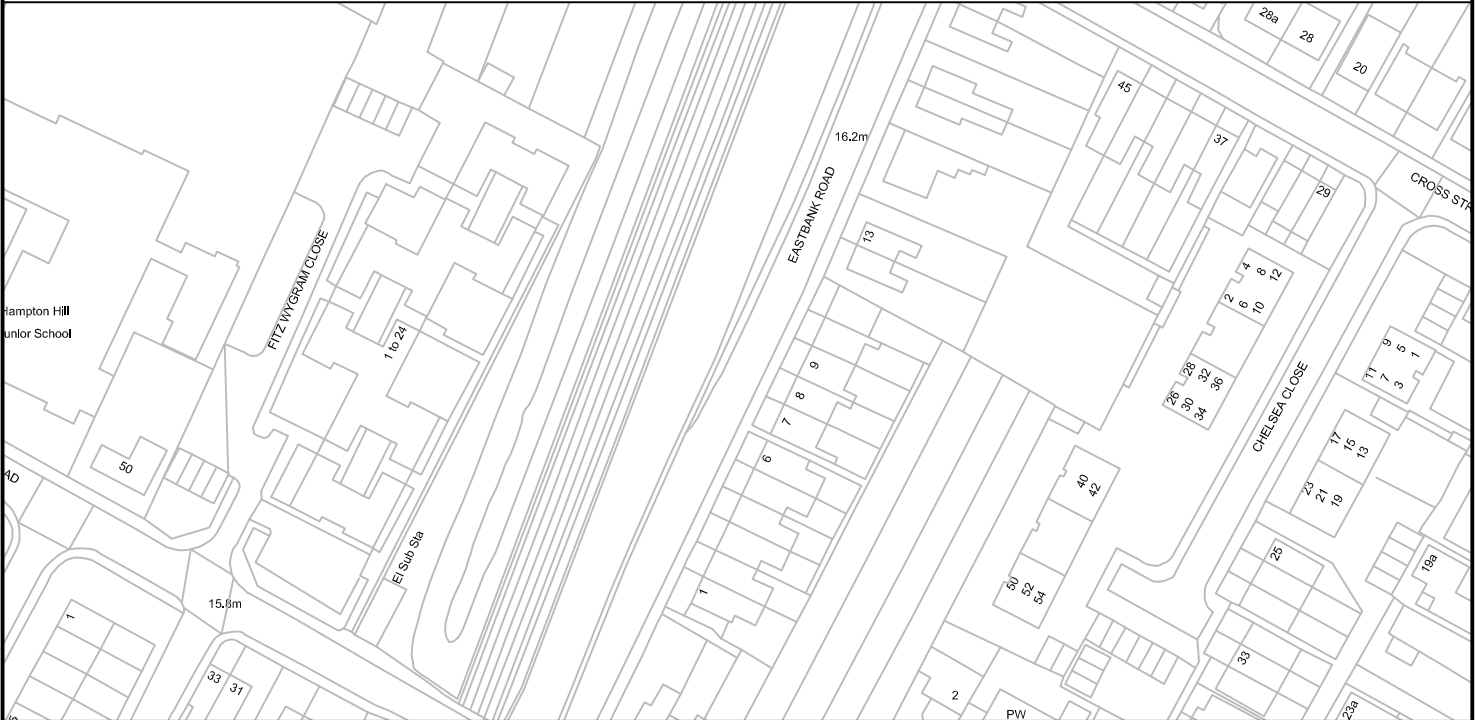

LOCATION PLAN – SCALE 1:1250

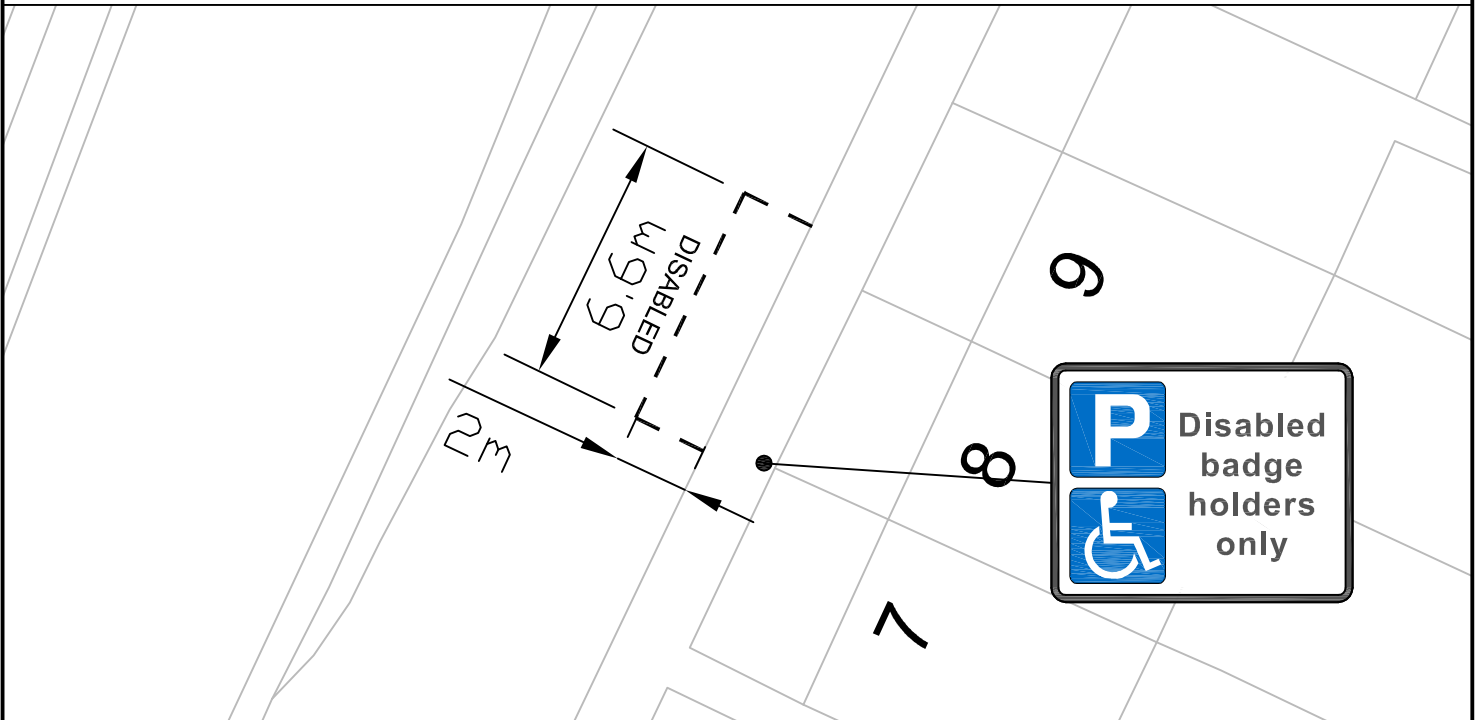

LAYOUT PLAN – SCALE 1:200



CLIENT LONDON BOROUGH OF RICHMOND UPON THAMES

PROJECT DISABLED PARKING BAY

DRAWING TITLE EASTBANK ROAD, HAMPTON HILL

A	AP 05/06/13	AP 05/06/13	MP 05/06/13	MT 05/06/13	Issue <input checked="" type="checkbox"/>	Draft <input checked="" type="checkbox"/>
REVISION	DRAWN BY & DATE	DESIGNED BY & DATE	CHECKED BY & DATE	APPROVED BY & DATE	Scale (at A4 size) VARIOUS	

ISSUING OFFICE TWICKENHAM

TELEPHONE 020 88911411

DRAWING NUMBER 2288_03_PR_GL_478120

REVISION A

This map is reproduced from Ordnance Survey material with the permission of the Controller of Her Majesty's Stationery Office ©Crown copyright. Unauthorised reproduction infringes Crown copyright and may lead to prosecution or civil proceedings 100019441 [2013].



LOCATION PLAN – SCALE 1:1250

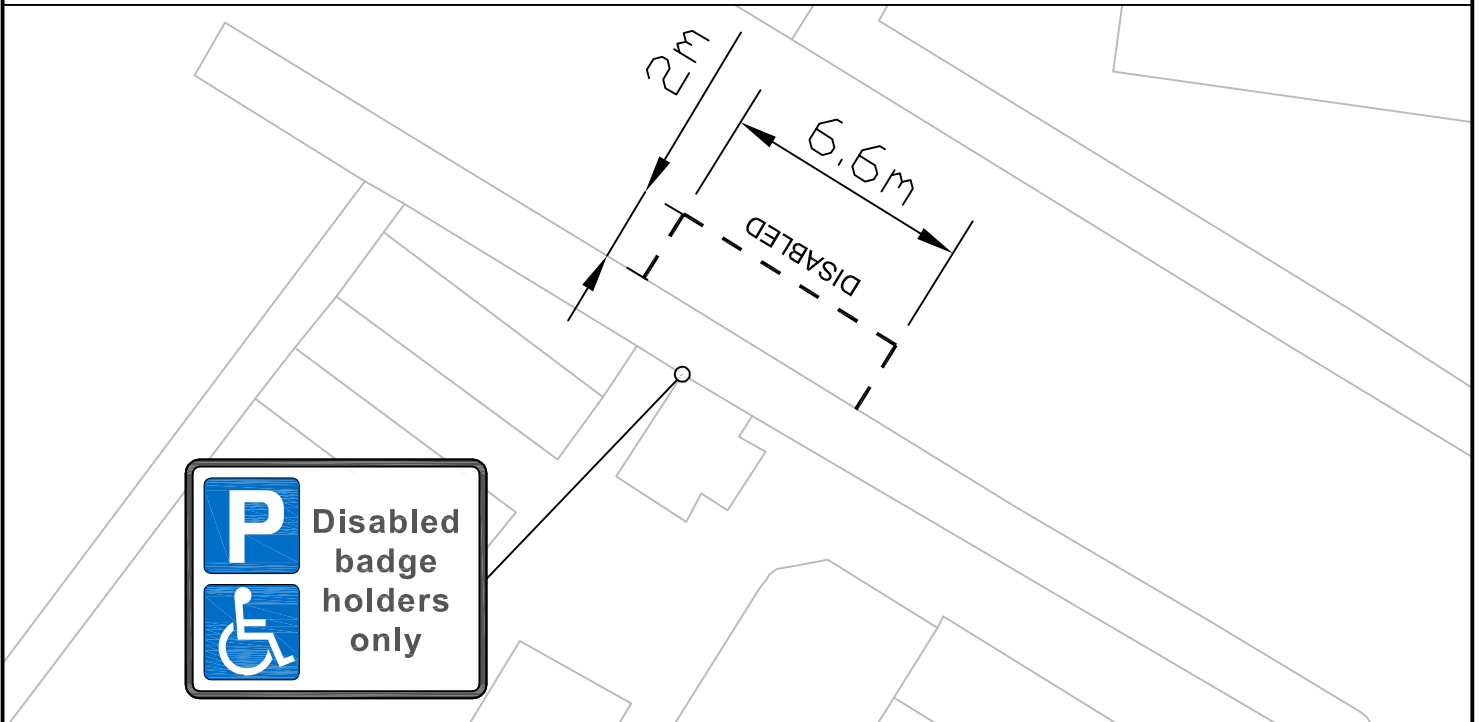

LAYOUT PLAN – SCALE 1:200



CLIENT LONDON BOROUGH OF RICHMOND UPON THAMES

PROJECT DISABLED PARKING BAY

DRAWING TITLE EDGAR ROAD, HEATHFIELD

A	AP 05/06/13	AP 05/06/13	MP 05/06/13	MT 05/06/13	Issue <input checked="" type="checkbox"/>	Draft <input checked="" type="checkbox"/>
REVISION	DRAWN BY & DATE	DESIGNED BY & DATE	CHECKED BY & DATE	APPROVED BY & DATE	Scale (at A4 size) VARIOUS	

ISSUING OFFICE TWICKENHAM

TELEPHONE 020 88911411

DRAWING NUMBER 2288_03_PR_GL_4000200

REVISION A

This map is reproduced from Ordnance Survey material with the permission of the Controller of Her Majesty's Stationery Office ©Crown copyright. Unauthorised reproduction infringes Crown copyright and may lead to prosecution or civil proceedings 100019441 [2013].

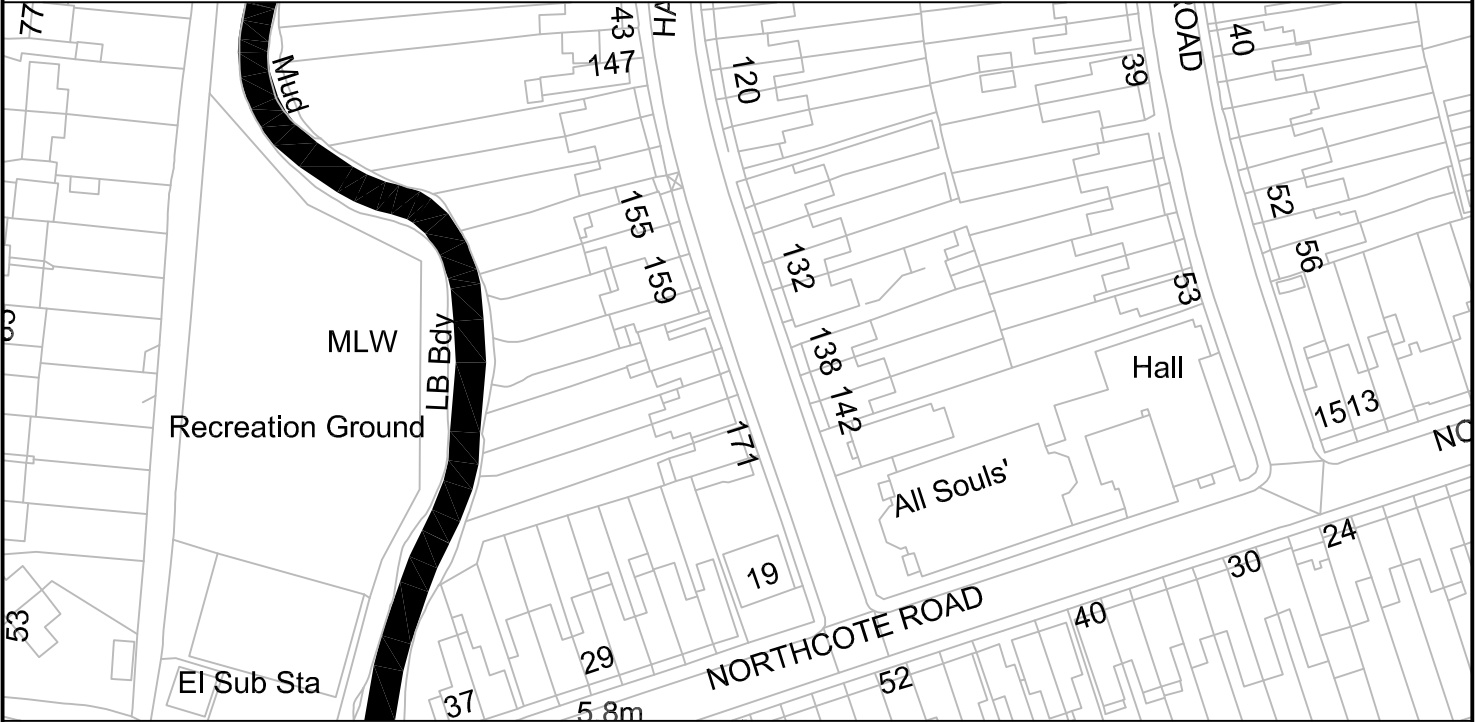

LOCATION PLAN – SCALE 1:1250



LAYOUT PLAN – SCALE 1:200



CLIENT LONDON BOROUGH OF RICHMOND UPON THAMES

PROJECT DISABLED PARKING BAY

DRAWING TITLE HALIBURTON ROAD, ST MARGARETS

A	AP 05/06/13	AP 05/06/13	MP 05/06/13	MT 05/06/13	Issue <input checked="" type="checkbox"/>	Draft <input checked="" type="checkbox"/>
REVISION	DRAWN BY & DATE	DESIGNED BY & DATE	CHECKED BY & DATE	APPROVED BY & DATE	Scale (at A4 size) VARIOUS	

ISSUING OFFICE TWICKENHAM

TELEPHONE 020 88911411

DRAWING NUMBER
2288_03_PR_GL_477781

REVISION
A

"This map is reproduced from Ordnance Survey material with the permission of the Controller of Her Majesty's Stationery Office © Crown copyright. Unauthorised reproduction infringes Crown copyright and may lead to prosecution or civil proceedings 100019441 [2011]"



LOCATION PLAN-1:1250

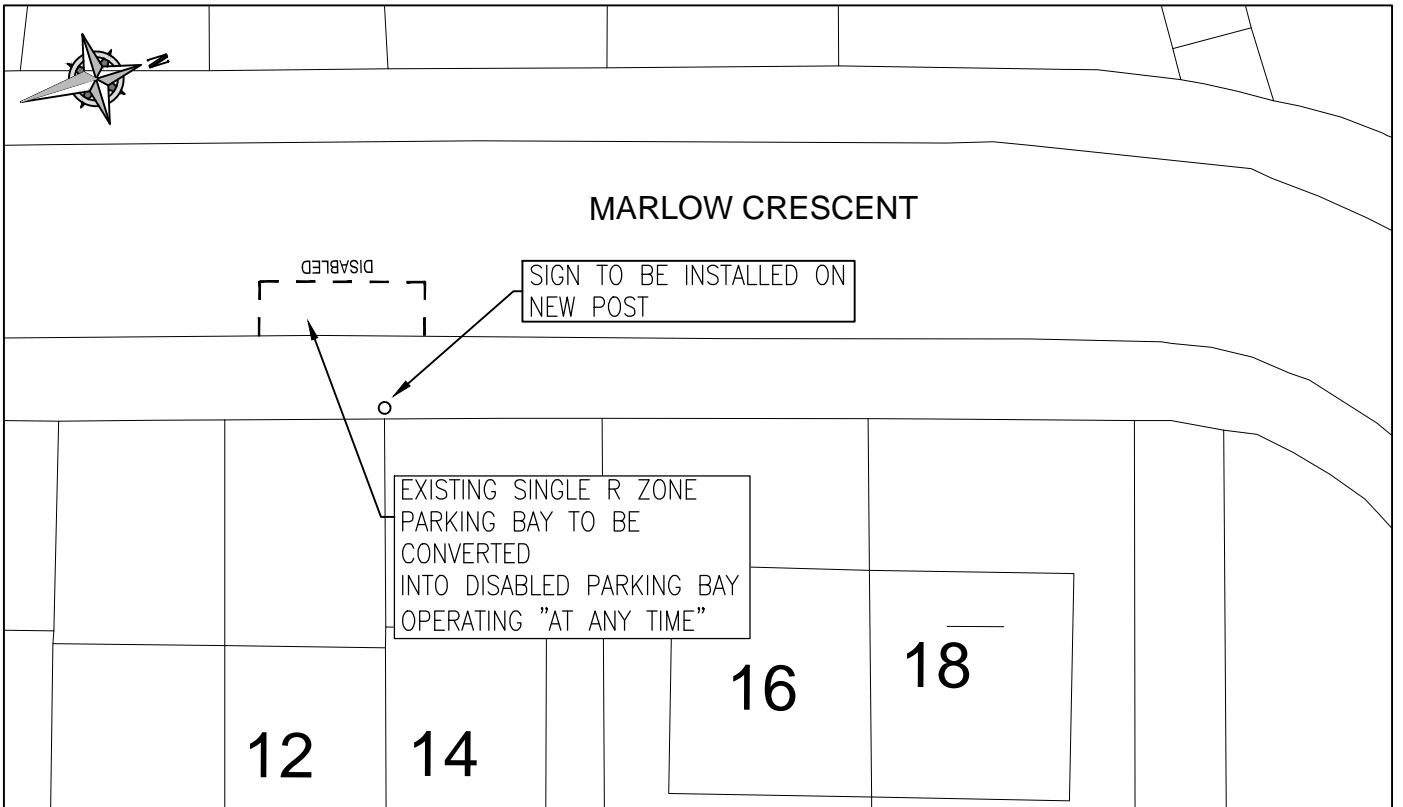

LAYOUT PLAN-1:250



CLIENT	LONDON BOROUGH OF RICHMOND UPON THAMES		
PROJECT	DISABLED PARKING BAY		
DRAWING TITLE	MARLOW CRESCENT, TWICKENHAM		
ISSUING OFFICE	TWICKENHAM	DRAWING NUMBER	REVISION
TELEPHONE	020 88911411	2288.PR.GL.477458	

					Draft	
					Issue	✓
					Scale (at A4 size)	AS SHOWN
REVISION	DRAWN BY & DATE	DESIGNED BY & DATE	CHECKED BY & DATE	APPROVED BY & DATE		