

ROAD TRAFFIC REGULATION ACT 1984

THE LONDON BOROUGH OF RICHMOND UPON THAMES (WAITING AND LOADING  
RESTRICTION) (CIVIL ENFORCEMENT AREA) (No. 1) EXPERIMENTAL ORDER 2018

**ENNERDALE ROAD, KEW  
FITZWILLIAM AVENUE, KEW**

(Reference 18/023)

1. NOTICE IS HEREBY GIVEN that the Council of the London Borough of Richmond upon Thames on 25 January 2018 made the above-mentioned Order under sections 9 and 10 of, and Part IV of Schedule 9 to, the Road Traffic Regulation Act 1984, as amended.
2. The general effect of the Order is to extend the existing double yellow lines ("no waiting at any time") at Ennerdale Road / Fitzwilliam Avenue, Kew junction so that they are sited: -
  - (a) **Ennerdale Road, Kew** - on its western side, from a point 12 metres south of its junction with Fitzwilliam Avenue to a point 10.7 metres north of its junction with Fitzwilliam Avenue;
  - (b) **Ennerdale Road, Kew** – on its eastern side, from a point 11.9 metres south of its junction with Fitzwilliam Avenue to a point 12.3 metres north of its junction with Fitzwilliam Avenue; and
  - (c) **Fitzwilliam Avenue, Kew** – from a point 7 metres east of its junction with Ennerdale Road to a point 7 metres west of its junction with Ennerdale Road.
3. Full details of the Order, which will come into operation on 5 February 2018, are contained in the following documents: -
  - (a) the Order;
  - (b) a plan indicating the location and effect of the restrictions; and
  - (c) the Council's Statement of Reasons for making the Order.
4. Copies of the above documents: -
  - (a) can be inspected, quoting Reference 18/023, at the Civic Centre (Central Reception, ground floor), 44 York Street, Twickenham between 9.15am and 5pm on Mondays to Fridays, except for Bank and other public holidays; and
  - (b) may be viewed on the Council's web-site at [http://www.richmond.gov.uk/public\\_notices](http://www.richmond.gov.uk/public_notices)until the date on which the Order ceases to have effect.
5. This Order provides that in pursuance of section 10(2) of the Road Traffic Regulation Act 1984 the Assistant Director of Environment of the London Borough of Richmond upon Thames, or other person authorised in that behalf by that officer may, if it appears to that officer or to that person essential in the interests of the expeditious, convenient and safe movement of traffic, or of the provision of suitable and adequate parking facilities on the highway, or for preserving or improving the amenities of the area through which the roads affected by this Order run, modify or suspend the Order or any provision thereof.
6. If the provisions of this Order continue in operation for a period of not less than six months, the Council will consider in due course whether the its provisions should be reproduced and continued in force indefinitely by means of an Order under section 6 of the said Act of 1984. Persons wishing to object to or support the making of such an

Order for the purpose of such reproduction and continuation in force may, within the period of six months referred to above send a statement in writing of their objection and the grounds of that objection to the address below.

7. Please address any representations to the Order to the Head of Engineering, Traffic and Parking Policy, London Borough of Richmond upon Thames, Civic Centre, 44 York Street, Twickenham, TW1 3BZ or by e-mail to [highwaysandtransport@richmondandwandsworth.gov.uk](mailto:highwaysandtransport@richmondandwandsworth.gov.uk) , quoting the reference given above by no later than 10 August 2018.
8. Persons wishing to question the validity of this Order or any of its provisions on the grounds that it or they are not within the powers conferred by the 1984 Act, or that any requirement of the Act or any instrument made under the Act has not been complied with that person may, within six weeks from the date on which the Order was made, apply for the purpose to the High Court

Nick O'Donnell  
Assistant Director – Traffic and Engineering  
Civic Centre, 44 York Street, Twickenham TW1 3BZ

Dated 26 January 2018



---

## **TRAFFIC MANAGEMENT ORDER**

### **THE LONDON BOROUGH OF RICHMOND UPON THAMES (WAITING AND LOADING RESTRICTION) (CIVIL ENFORCEMENT AREA) (No. 1) EXPERIMENTAL ORDER 2018**

Made: 25 January 2018

Coming into operation: 5 February 2018

The Council of the London Borough of Richmond upon Thames, having consulted the Commissioner of Police of the Metropolis, in exercise of the powers conferred by Sections 9 and 10 of, and Part IV of Schedule 9 to, the Road Traffic Regulation Act 1984(a), as amended, hereinafter referred to as "the Act of 1984" and all other enabling powers hereby make the following Order —

1. This Order shall come into operation on 5 February 2018 and may be cited as the London Borough of Richmond upon Thames (Waiting and Loading Restriction) (Civil Enforcement Area) (No. 1) Experimental Order 2018.
2.
  - (1) In this Order the expression "enactment" means any enactment whether public, general or local and includes any order, bye-law, rule, regulation, scheme or other instrument having effect by virtue of an enactment.
  - (2) Any reference in this Order to any enactment shall be construed as a reference to that enactment as amended, applied, consolidated, re-enacted by or as having effect by virtue of any subsequent enactment.
  - (3) The Interpretation Act 1978(b) shall apply for the interpretation of this Order as it applies for the interpretation of an Act of Parliament.
3. Whilst this Order continues in force the provisions of the London Borough of Richmond upon Thames (Waiting and Loading Restriction) (Civil Enforcement Area) (Consolidation No. 8) Order 2008(c), as amended, shall have effect as though: -
  - (a) for the item numbered 228 and 250 in that Order there was substituted the item similarly numbered and set out in columns 1, 2 and 3 of Schedule 1 to this Order;
4. In pursuance of section 10(2) of the Road Traffic Regulation Act 1984 the Assistant Director, Traffic and Engineering of the London Borough of Richmond upon Thames, as the specified officer, or some person authorised in that behalf by that officer may, if it appears to that officer or to that person essential in the interests of the expeditious, convenient and safe movement of traffic, or of the provision of suitable and adequate parking facilities on the highway, or for preserving or improving the amenities of the area through which the road affected by this Order runs, modify or suspend this Order or any provision thereof.

---

(a) 1984 c. 27.

(b) 1978 c. 30.

(c) 2008/38, - The relevant amending Orders are

Dated 25 January 2018

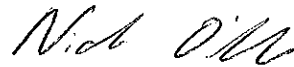

Assistant Director, Traffic and Engineering  
(The officer appointed for this purpose)

**THE SCHEDULE**  
(See Article 3(a))

ITEM TO BE SUBSTITUTED IN SCHEDULE 1 [to 2008/38]

1 Item No.	2 Street	3 Prescribed Hours – See Schedule 3 (to 2008/38)
228	<p>Ennerdale Road, Kew:</p> <p>(a) the north and north-west side:</p> <ul style="list-style-type: none"> <li>(i) from the western kerb-line of Sandycombe Road, Kew westwards for a distance of 10 metres;</li> <li>(ii) from a point 10 metres west of the western kerb-line of Sandycombe Road westwards then south-westwards to a point 13 metres west of party wall of Nos 4 and 6 Ennerdale Road;</li> <li>(iii) from a point 16.5 metres north of the common boundary of "Celia Court" and No 8 Ennerdale Road north-eastwards to a point 13 metres west of the common boundary of Nos 2/4 and No 6 Ennerdale Road;</li> <li>(iv) from a point 16.5 metres north of the common boundary of "Celia Court" and No 8 Ennerdale Road south-westwards to a point 10 metres north-east of the northern kerb-line of Branstone Road, Kew;</li> <li>(v) from a point 10 metres north-east of the northern kerb-line of Branstone Road to a point 10 metres south-west of the southern kerb-line of Branstone Road;</li> <li>(vi) from a point 10 metres south-west of the southern kerb-line of Branstone Road south-westwards to a point 6.5 metres north-east of the northern kerb-line of Hatherley Road, Kew;</li> <li>(vii) from a point 6.5 metres north-east of the northern kerb-line of Hatherley Road to a point 9 metres south-west of the southern kerb-line of Hatherley Road;</li> <li>(viii) from a point 9 metres south-west of the southern kerb-line of Hatherley Road south-westwards to a point 6.5 metres north-east of the northern kerb-line of The Avenue, Kew;</li> <li>(ix) from a point 6.5 metres north-east of the northern kerb-line of The Avenue south-westwards to a point 6.5 metres south-west of the southern kerb-line of The Avenue;</li> <li>(x) from a point 6.5 metres south of the southern kerb-line of The Avenue to a point 10 metres north of the northern kerb-line of Eversfield Road, Kew;</li> </ul>	<p>A</p> <p>Z22</p> <p>A</p> <p>Z22</p> <p>A</p> <p>Z22</p> <p>A</p> <p>Z22</p> <p>A</p> <p>Z22</p>

1 Item No.	2 Street	3 Prescribed Hours – See Schedule 3 (to 2008/38)
	<p>(xi) from a point 10 metres north of the northern kerb-line of Eversfield Road to a point 10 metres south of the southern kerb-line of Eversfield Road;</p> <p>(xii) from a point 10 metres south of the southern kerb-line of Eversfield Road to a point 10 metres north of the northern kerb-line of Walpole Avenue, Kew;</p> <p>(xiii) from a point 10 metres north of the northern kerb-line of Walpole Avenue to a point 10 metres south of the southern kerb-line of Walpole Avenue;</p> <p>(xiv) from a point 10 metres south of the southern kerb-line of Walpole Avenue to a point 10.7 metres north of the northern kerb-line of Fitzwilliam Avenue, Kew;</p> <p>(xv) from a point 10.7 metres north of the northern kerb-line of Fitzwilliam Avenue to a point 12 metres south of the southern kerb-line of Fitzwilliam Avenue;</p> <p>(xvi) from a point 12 metres south of the southern kerb-line of Fitzwilliam Avenue to its junction with the north to south arm of Lion Gate Gardens, Kew;</p> <p>(b) the south and south-east side:</p> <p>(i) from the western kerb-line of Sandycombe Road westwards for a distance of 10 metres;</p> <p>(ii) from a point 10 metres west of the western kerb-line of Sandycombe Road westwards then south-westwards to a point 6.5 metres north-east of the northern kerb-line of The Avenue;</p> <p>(iii) from a point 6.5 metres north-east of the northern kerb-line of The Avenue south-westwards to a point 10 metres south-west of the southern kerb-line of The Avenue.</p> <p>(iv) from a point 10 metres south of the southern kerb-line of The Avenue to a point 12.3 metres north of the northern kerb-line of Fitzwilliam Avenue;</p> <p>(v) from a point 12.3 metres north of the northern kerb-line of Fitzwilliam Avenue to a point 11.9 metres south of the southern kerb-line of Fitzwilliam Avenue;</p> <p>(vi) from a point 11.9 metres south of the southern kerb-line of Fitzwilliam Avenue to its junction with the north to south arm of Lion Gate Gardens.</p>	<p>A</p> <p>Z22</p> <p>A</p> <p>Z22</p> <p>A</p> <p>Z22</p> <p>A</p> <p>Z22</p> <p>A</p> <p>Z22</p> <p>A</p> <p>Z22</p>
250	<p>Fitzwilliam Avenue, Kew:</p> <p>(a) the north side:</p> <p>(i) from the eastern kerb-line of Kew Road, Kew eastwards for a distance of 16 metres;</p>	<p>A</p>

1 Item No.	2 Street	3 Prescribed Hours – See Schedule 3 (to 2008/38)
	<p>(ii) from a point 16 metres east of the eastern kerb-line of Kew Road eastwards to a point 7 metres west of the western kerb-line of Ennerdale Road, Kew;</p> <p>(b) the south side:</p> <p>(i) from the eastern kerb-line of Kew Road eastwards for a distance of 10 metres;</p> <p>(ii) from a point 10 metres east of the eastern kerb-line of Kew Road eastwards to a point 7 metres west of the western kerb-line of Ennerdale Road;</p> <p>(c) from a point 7 metres west of the western kerb-line of Ennerdale Road to a point 7 metres east of the eastern kerb-line of Ennerdale Road;</p> <p>(d) from a point 7 metres east of the eastern kerb-line of Ennerdale Road to a point 5 metres west of the western kerb-line of Gainsborough Road, Kew;</p> <p>(e) from the western kerb-line of Gainsborough Road westwards for a distance of 5 metres.</p>	<p>Z22</p> <p>A</p> <p>Z22</p> <p>A</p> <p>Z22</p> <p>A</p>

## EXPLANATORY NOTE

This Order introduces lengths of waiting restrictions ("no waiting at any time") in Ennerdale Road and Fitzwilliam Avenue, Kew.

THE LONDON BOROUGH OF RICHMOND UPON THAMES (WAITING AND LOADING  
RESTRICTION) (CIVIL ENFORCEMENT AREA) (No. 1) EXPERIMENTAL ORDER 2018

STATEMENT OF REASONS

The Council receives reports from time to time on matters of road safety caused by parked vehicles and these may come from residents, Councilors, Council officers or bus and emergency services. These matters include poor sight lines at junctions, obstruction of footway crossing points, lack of suitable passing areas and reduced carriageway width restricting or preventing access for vehicles especially emergency service vehicles.

This Order is intended to improve road safety for all users by introducing waiting restrictions "no waiting at any time" at the locations contained within the Notice of Making, Experimental Traffic Management Order and accompanying drawing. Similar restrictions have proved effective in locations elsewhere in the borough that previously suffered similar problems.

This scheme is being introduced on an experimental basis to give the Council of the London Borough of Richmond upon Thames powers to make modifications or variations to the scheme in the light of operational experience.

The Council will consider in due course whether to make permanent Orders the effect of which will be to reproduce and continue in force indefinitely the provisions of these Orders



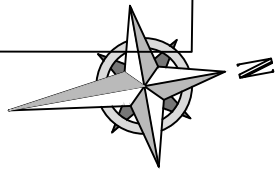

"This map is reproduced from Ordnance Survey material with the permission of the Controller of Her Majesty's Stationery Office ©Crown copyright. Unauthorised reproduction infringes Crown copyright and may lead to prosecution or civil proceedings 100019441 [2014]."

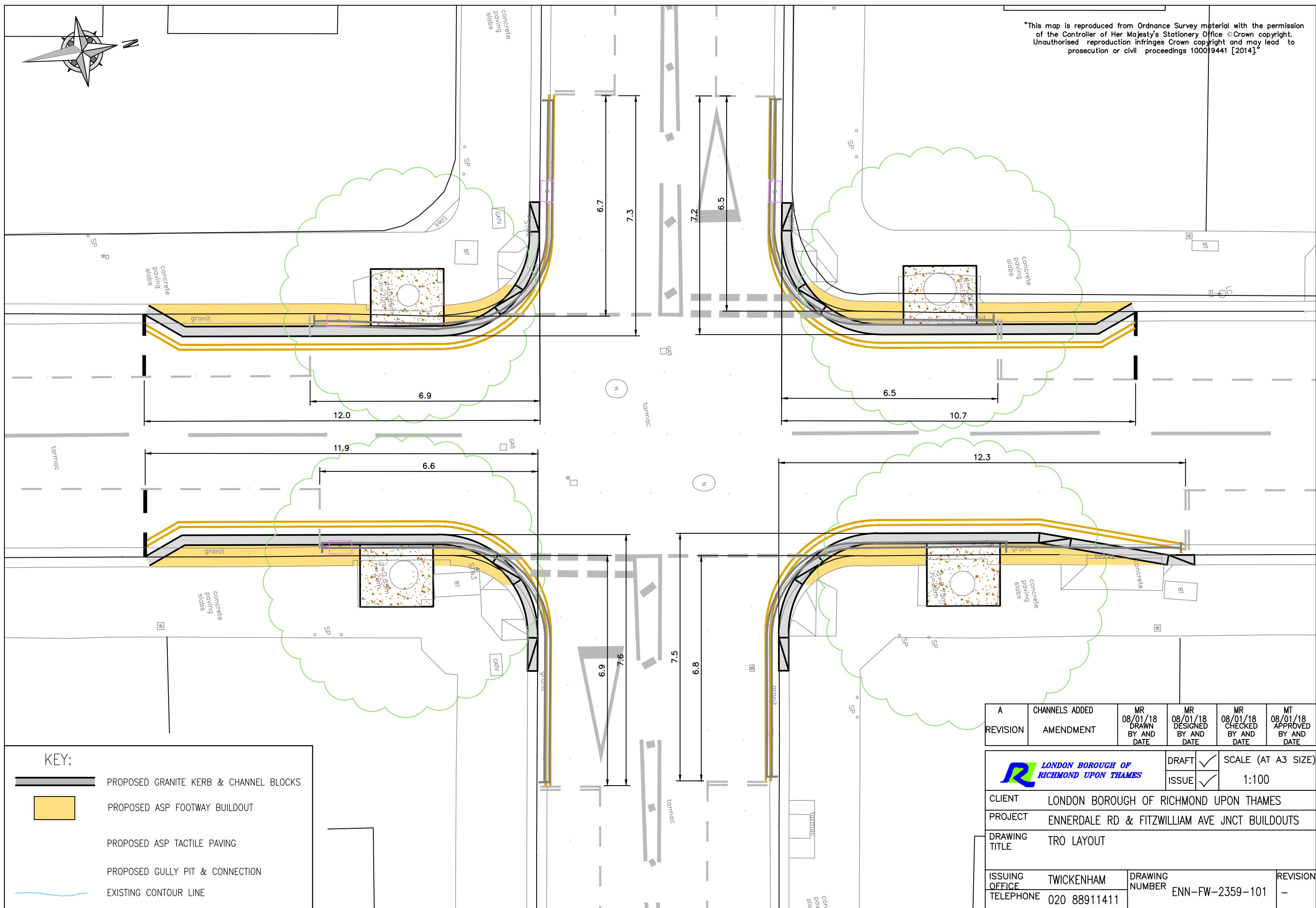

KEY:

- PROPOSED GRANITE KERB & CHANNEL BLOCKS
- PROPOSED ASP FOOTWAY BUILDOUT
- PROPOSED ASP TACTILE PAVING
- PROPOSED GULLY PIT & CONNECTION
- EXISTING CONTOUR LINE

A	CHANNELS ADDED	MR	MR	MR	MT
REVISION	AMENDMENT	08/01/18	08/01/18	08/01/18	08/01/18
		DRAWN	DESIGNED	CHECKED	APPROVED
		BY AND	BY AND	BY AND	BY AND
		DATE	DATE	DATE	DATE
LONDON BOROUGH OF RICHMOND UPON THAMES			DRAFT	✓	SCALE (AT A3 SIZE)
			ISSUE	✓	1:100
CLIENT	LONDON BOROUGH OF RICHMOND UPON THAMES				
PROJECT	ENNERDALE RD & FITZWILLIAM AVE JNCT BUILDOUTS				
DRAWING TITLE	TRO LAYOUT				
ISSUING OFFICE	TWICKENHAM	DRAWING NUMBER	ENN-FW-2359-101		
TELEPHONE	020 88911411				REVISION -