

## HIGHWAYS ACT 1980 – SECTION 90C

### SPEED TABLE

#### SANDYCOMBE ROAD, KEW

(Reference 15/217)

NOTICE IS HEREBY GIVEN that the Council of the London Borough of Richmond upon Thames proposes to install a speed table in Sandycombe Road, Kew at its junctions with Lichfield Road and High Park Road, extending into Station Parade.

The speed table will be sited in Sandycombe Road from a point 20 metres south of the southern kerb-line of Lichfield Road extending northwards to a point 29 metres north of the northern kerb-line of Lichfield Road, extending into Lichfield Road from the western kerb-line of Sandycombe Road, for a distance of some 8 metres, and extending into High Park Road for a distance of some 30 metres with an extension into Station Parade from the eastern kerb-line of High Park Road for a distance of some 7 metres. All the lengths include ramps, which have a gradient of 1:20.

A drawing showing the proposed design will be available for public inspection, quoting reference 15/217, at:-

- (a) the Civic Centre (Central Reception, ground floor), 44 York Street, Twickenham between 9.15am and 5pm on Mondays to Fridays, except for Bank and other public holidays; or
- (b) may be viewed on the Council's web-site at [http://www.richmond.gov.uk/public\\_notices](http://www.richmond.gov.uk/public_notices)

Persons wishing to make representations regarding proposals should write to the Highway Infrastructure Manager, Civic Centre, 44 York Street, Twickenham TW1 3BZ by no later than 4 January 2016. Representations may also be sent by email to [highwaysandtransport@richmond.gov.uk](mailto:highwaysandtransport@richmond.gov.uk)

PAUL CHADWICK  
Director of Environment  
Civic Centre, 44 York Street, Twickenham TW1 3BZ

Dated 4 December 2015



This map is reproduced from Ordnance Survey material with the permission of the Controller of Her Majesty's Stationery Office © Crown copyright. Unauthorised reproduction infringes Crown copyright and may lead to prosecution or civil proceedings 100019441 [2014].

ARTIFICIAL STONE PAVING

HERITAGE (GOLDEN) GRAVEL

BUFF COLOURED ANTISKID SURFACE

BLACK/GREY COLOURED ANTISKID SURFACE

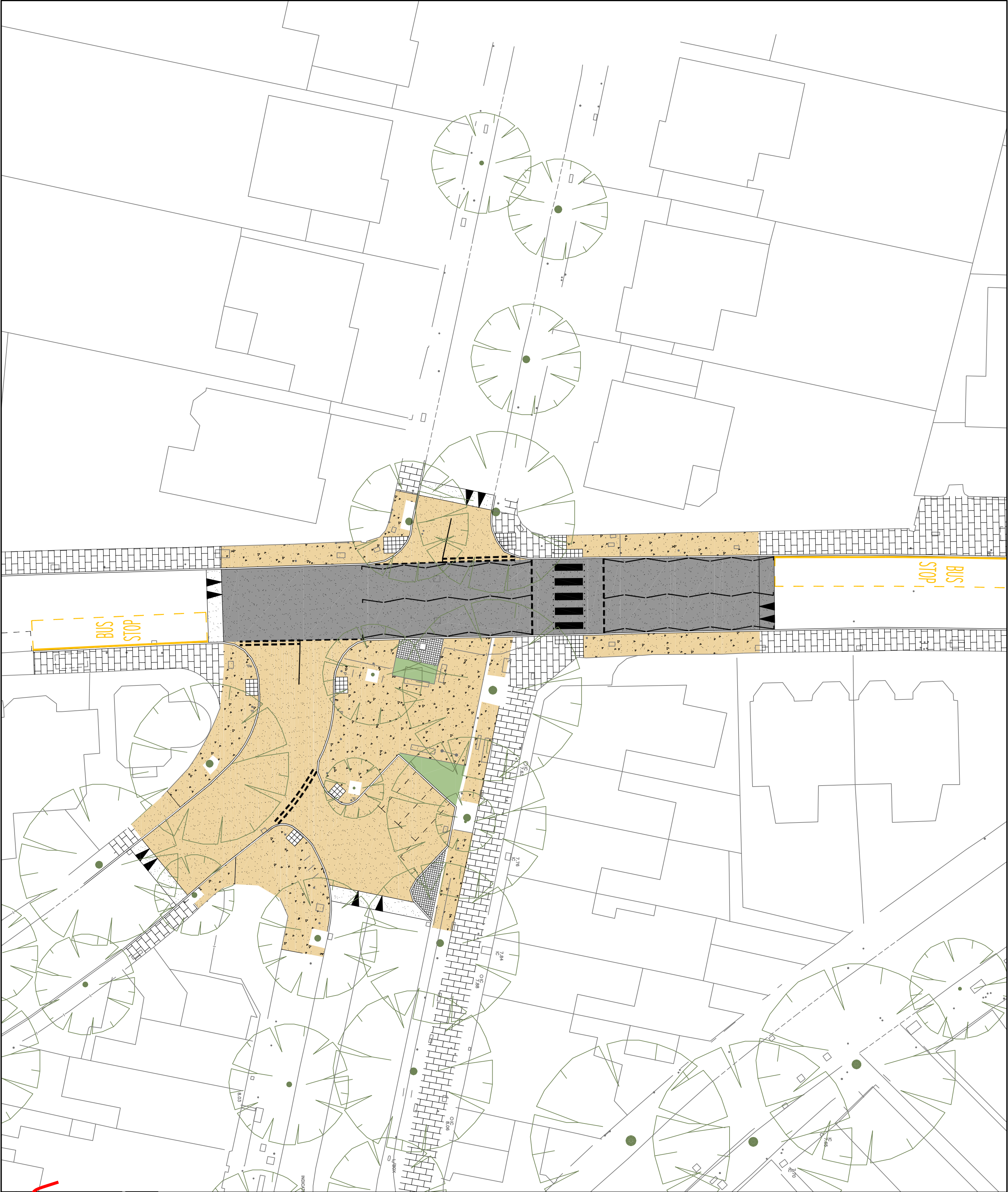

REVISION	AMENDMENT	DRAWN BY AND DATE	DESIGNED BY AND DATE	CHECKED BY AND DATE	APPROVED DATE

**LONDON BOROUGH OF RICHMOND UPON THAMES**  
PROJECT: SANDYCOMBE ROAD - TRAFFIC CALMING  
DRAWING: DETAIL DESIGN  
SCALE: 1:250  
ISSUE: 1

**UNCONTROLLED**  
ISSUING OFFICE: TWICKENHAM  
DRAWING NUMBER: 2334-DD-1100-001  
TELEPHONE: 020 88911411  
REVISION: