

THE LONDON BOROUGH OF RICHMOND UPON THAMES  
(RICHMOND TOWN) (PARKING PLACES) (AMENDMENT No. 3) ORDER 2013

THE LONDON BOROUGH OF RICHMOND UPON THAMES  
(WAITING AND LOADING RESTRICTION) (CIVIL ENFORCEMENT AREA)  
(AMENDMENT No. 87) ORDER 2013

**LEWIS ROAD AND RED LION STREET, RICHMOND**  
(Reference 13/068)

1. The Council of the London Borough of Richmond upon Thames on 17 June 2013 made the above-mentioned Orders under sections 6, 45, 46, 49 and 124 of, and Part IV of Schedule 9 to, the Road Traffic Regulation Act 1984, as amended.
2. The principal objective of these Orders is to allow part of an experimental traffic management scheme (introduced on 20 August 2012) to be continued on a permanent basis.
3. The Council has decided not to continue the part of the experiment whereby two of the three pay and display bays in Lewis Road were redesignated as a parking place for police vehicles. That area will, therefore, revert to the three pay and display bays which had been in place up until August 2012.
4. The general effect of the **parking places amendment order** is to make permanent the provision by which a pay and display parking place in Red Lion Street within the Richmond Town controlled parking zone (zone "A1") was extended from 4 bays to 6 bays. The sole effect of this Order is to replicate and continue in force indefinitely one of the provisions of the London Borough of Richmond upon Thames (Richmond Town) (Parking Places) (No. 1) Experimental Order 2012.
5. The general effect of the **waiting and loading restriction amendment order** is to make the consequential amendments to the waiting restrictions such that the order is consistent with the parking places referred to in paragraphs 3 and 4 above.
6. Copies of the Orders, which will come into operation on 1 July 2013, a plan showing the location and effect of the scheme and the Council's Statement of Reasons for making the Orders:-
  - (a) can be inspected for a period of 6 weeks, quoting Reference 13/068, at the Civic Centre (Central Reception, ground floor), 44 York Street, Twickenham between 9.15am and 5pm on Mondays to Fridays, except for Bank and other public holidays; and
  - (b) may be viewed on the Council's web-site at [http://www.richmond.gov.uk/traffic\\_management\\_orders.htm](http://www.richmond.gov.uk/traffic_management_orders.htm)
7. Copies of the Orders may be purchased from the Environment Directorate, Civic Centre, 44 York Street, Twickenham TW1 3BZ.
8. If any person wishes to question the validity of the Orders or of any of their provisions on the grounds that they are not within the powers conferred by the Road Traffic Regulation Act 1984, or that any requirement of the said Act of 1984 or of any instrument made under the said Act of 1984 has not been complied with, that person may, within 6 weeks from the date on which the Orders were made, apply for the purpose to the High Court.

ANDREW DARVILL

Assistant Director, Traffic and Transport  
Civic Centre, 44 York Street, Twickenham TW1 3BZ

Dated 21 June 2013

---

## PARKING PLACES ORDER

### THE LONDON BOROUGH OF RICHMOND UPON THAMES (RICHMOND TOWN) (PARKING PLACES) (AMENDMENT No. 3) ORDER 2013

Made: 17 June 2013

Coming into operation: 1 July 2013

The Council of the London Borough of Richmond upon Thames, having consulted the Commissioner of Police of the Metropolis, in exercise of the powers conferred by Sections 45, 46, 49 and 124 of, and Part IV of Schedule 9 to, the Road Traffic Regulation Act 1984(a), as amended, and all other enabling powers hereby make the following Order —

#### Commencement and citation

1. This Order shall come into operation on 1 July 2013 and may be cited as the London Borough of Richmond upon Thames (Richmond Town) (Parking Places) (Amendment No. 3) Order 2013.

#### Interpretation

2. (1) In this Order the expression “enactment” means any enactment whether public, general or local and includes any order, bye-law, rule, regulation, scheme or other instrument having effect by virtue of an enactment.  
(2) Any reference in this Order to any enactment shall be construed as a reference to that enactment as amended, applied, consolidated, re-enacted by or as having effect by virtue of any subsequent enactment.  
(3) The Interpretation Act 1978(b) shall apply for the interpretation of this Order as it applies for the interpretation of an Act of Parliament.

#### Revocation

3. The London Borough of Richmond upon Thames (Richmond Town) (Parking Places) (No. 1) Experimental Order 2012(c) is hereby revoked.

#### Amendment to the parking places order

4. Without prejudice to the validity of anything done or to any liability incurred in respect of any act or omission before the coming into operation of this Order, the London Borough of Richmond upon Thames (Richmond Town) (Parking Places) (Consolidation No. 2) Order 2008(d), as amended, shall have effect as though there were substituted for the item in Schedule 1C to that order numbered 1C/2 the item similarly numbered and as set out in columns 1, 2, 3, 4 and 5 of the Schedule to this order.

---

(a) 1984 c. 27.

(b) 1978 c. 30.

(c) 2012/33

(d) 2008/51 – there is no relevant amending order.

Dated: 17 June 2013

Assistant Director, Traffic and Transport  
(The officer appointed for this purpose)

**SCHEDULE**  
(See Article 4)

ITEM TO BE SUBSTITUTED IN SCHEDULE 1C [to 2008/51]

**SCHEDULE 1C**

IN RELATION TO A PARKING PLACE REFERRED TO IN THIS SCHEDULE THE EXPRESSION "PERMITTED HOURS" MEANS THE PERIODS BETWEEN 8.30 AM AND 6.30 PM ON MONDAYS TO SATURDAYS INCLUSIVE AND BETWEEN 11.00 AM AND 5.00 PM ON SUNDAYS AND BANK HOLIDAYS, EXCEPT EASTER SUNDAY AND CHRISTMAS DAY.

PARKING PLACES IN RESPECT OF WHICH THE MAXIMUM PARKING PERIOD FOR WHICH A VEHICLE MAY BE LEFT DURING THE PERMITTED HOURS IS ONE HOUR, OR IN WHICH A VEHICLE MAY BE LEFT BETWEEN 8.30 AM AND 9.30 AM AND BETWEEN 5.30 PM AND 6.30 PM IF IT DISPLAYS A VALID RESIDENTS' OR RESIDENTS' VISITORS PERMIT.

1 No. of parking place	2 Designated parking place	3 Minimum number of parking spaces	4 Minimum total length in metres not to be occupied by parking spaces	5 Special manner of standing
1C/2	RED LION STREET, the south side, from a point opposite the party wall of Nos. 14 and 16 Red Lion Street north-eastwards to a point opposite the party wall of Nos. 26 and 26A Red Lion Street.	6	-	-

## EXPLANATORY NOTE

(This Note is not part of the Order but is intended to indicate its general purport.)

This Order continues in force the following alteration to a parking place in Red Lion Street, Richmond (within the Richmond Town controlled parking zone), which was introduced as an experiment in 2012:

- (a) two new pay and display parking bays in Red Lion Street, Richmond (each being 5 metres long) to operate between the hours of 8.30am and 6.30pm on Mondays to Saturdays inclusive and between 11am and 5pm on Sundays and bank holidays where the maximum stay is 1 hour. As with all such parking bays in this controlled parking zone vehicles which display a valid residents parking permit or a valid residents visitors permit may be left here between the hours of 8.30am and 9.30am and between 5.30pm and 6.30pm.

The part of the experiment by which an existing pay and display bay in Lewis Road was shortened to accommodate a parking bay for police vehicles has been abandoned. There is, therefore, no requirement for any amendments to be made to the parking places order in respect of Lewis Road.

---

## PARKING PLACES ORDER

### THE LONDON BOROUGH OF RICHMOND UPON THAMES (WAITING AND LOADING RESTRICTION) (CIVIL ENFORCEMENT AREA) (AMENDMENT No. 87) ORDER 2013

Made: 17 June 2013

Coming into operation: 1 July 2013

The Council of the London Borough of Richmond upon Thames, having consulted the Commissioner of Police of the Metropolis, in exercise of the powers conferred by Sections 6 and 124 of, and Part IV of Schedule 9 to, the Road Traffic Regulation Act 1984(a), as amended, and all other enabling powers hereby make the following Order —

#### Commencement and citation

1. This Order shall come into operation on 1 July 2013 and may be cited as the London Borough of Richmond upon Thames (Waiting and Loading Restriction) (Civil Enforcement Area) (Amendment No. 87) Order 2013.

#### Interpretation

2. (1) In this Order the expression “enactment” means any enactment whether public, general or local and includes any order, bye-law, rule, regulation, scheme or other instrument having effect by virtue of an enactment.  
  
(2) Any reference in this Order to any enactment shall be construed as a reference to that enactment as amended, applied, consolidated, re-enacted by or as having effect by virtue of any subsequent enactment.  
  
(3) The Interpretation Act 1978(b) shall apply for the interpretation of this Order as it applies for the interpretation of an Act of Parliament.

#### Amendments to the waiting and loading restriction order

3. Without prejudice to the validity of anything done or to any liability incurred in respect of any act or omission before the coming into operation of this Order, the London Borough of Richmond upon Thames (Waiting and Loading Restriction) (Civil Enforcement Area) Order 2008(c), as amended, shall have effect as though there were substituted for the items in Schedule 1 to that order numbered 491 and 572 the items similarly numbered and as set out in columns 1, 2 and 3 of the Schedule to this order.

---

(a) 1984 c. 27. (b) 1978 c. 30.  
(c) 2008/38 – there is no relevant amending order.

17 June 2013

Assistant Director, Traffic and Transport  
(The officer appointed for this purpose)

**THE SCHEDULE**

(See Article 3)

ITEMS TO BE SUBSTITUTED IN SCHEDULE 1 [to 2008/38]  
RESTRICTED STREETS

1 Item No.	2 Street	3 Prescribed hours - see Schedule 3 [to 2008/38]
491	Lewis Road, Richmond: (a) the south-west side; (b) the north-east side: (i) from the southern kerb-line of Red Lion Street to a point opposite the extended south-east kerb-line of Castle Yard; (ii) from a point opposite the extended south-eastern kerb-line of Castle Yard south-eastwards for a distance of 15.5 metres; (iii) from a point 15.5 metres south-east of a point opposite the extended south-eastern kerb-line of Castle Yard to the north-western kerb-line of Wakefield Road.	A  A  Z34  A
572	Red Lion Street, Richmond: (a) the north side; (b) the south side: (i) from the eastern kerb-line of Hill Street to the common boundary of Nos 14 and 16 Red Lion Street; (ii) from the common boundary of Nos 14 and 16 Red Lion Street to the common boundary of Nos 26 and 26A Red Lion Street; (iii) from the common boundary of Nos 26 and 26A Red Lion Street to the western kerb-line of Church Terrace.	A  A  Z34  A

## EXPLANATORY NOTE

(This Note is not part of the Order but is intended to indicate its general purport.)

This Order continues in force the following part of an experimental scheme:

- (a) waiting restrictions in Red Lion Street to provide for a pay and display parking bay (10 metres long) in Red Lion Street to operate between the hours of 8.30am and 6.30pm on Mondays to Saturdays inclusive and between 11am and 5pm on Sundays and bank holidays.

The Council has decided not to make permanent that part of the experimental scheme by which a parking place for police vehicles had been introduced in Lewis Road, Richmond. The two pay and display bays in that road which had been discontinued to allow for the police vehicle bay are, therefore, to be reinstated. This order makes a technical amendment to the waiting restrictions in Lewis Road and Red Lion Street, Richmond whereby any ambiguity as to the provisions of this order with the provisions of the corresponding parking places order is removed.



ROAD TRAFFIC REGULATION ACT 1984

**THE LONDON BOROUGH OF RICHMOND UPON THAMES (RICHMOND TOWN)  
(PARKING PLACES) (AMENDMENT No. 3) ORDER 2013**

**THE LONDON BOROUGH OF RICHMOND UPON THAMES (WAITING AND  
LOADING RESTRICTION) (CIVIL ENFORCEMENT AREA) (AMENDMENT No. 87)  
ORDER 2013**

STATEMENT OF REASONS FOR MAKING THESE ORDERS

These orders are made to bring to a conclusion an experimental scheme affecting on-street parking provision in Lewis Road and Red Lion Street, Richmond.

The purpose of the experimental scheme had been to provide a parking bay in Lewis Road, Richmond solely for the use by the Police and was introduced to improve their operational effectiveness. To compensate for the loss of on-street parking available to the public, an existing rank of 4 pay and display bays in Red Lion Street was extended to 6 bays.

The facility for police vehicles parking has been negated on account of the imminent closure of the Richmond police station in Red Lion Street. However, no adverse effect of traffic flow along Red Lion Street due to the extended parking place had been observed in the course of the experiment, and the Council has decided that this part of the experiment should be continued as a permanent feature.

21 June 2013

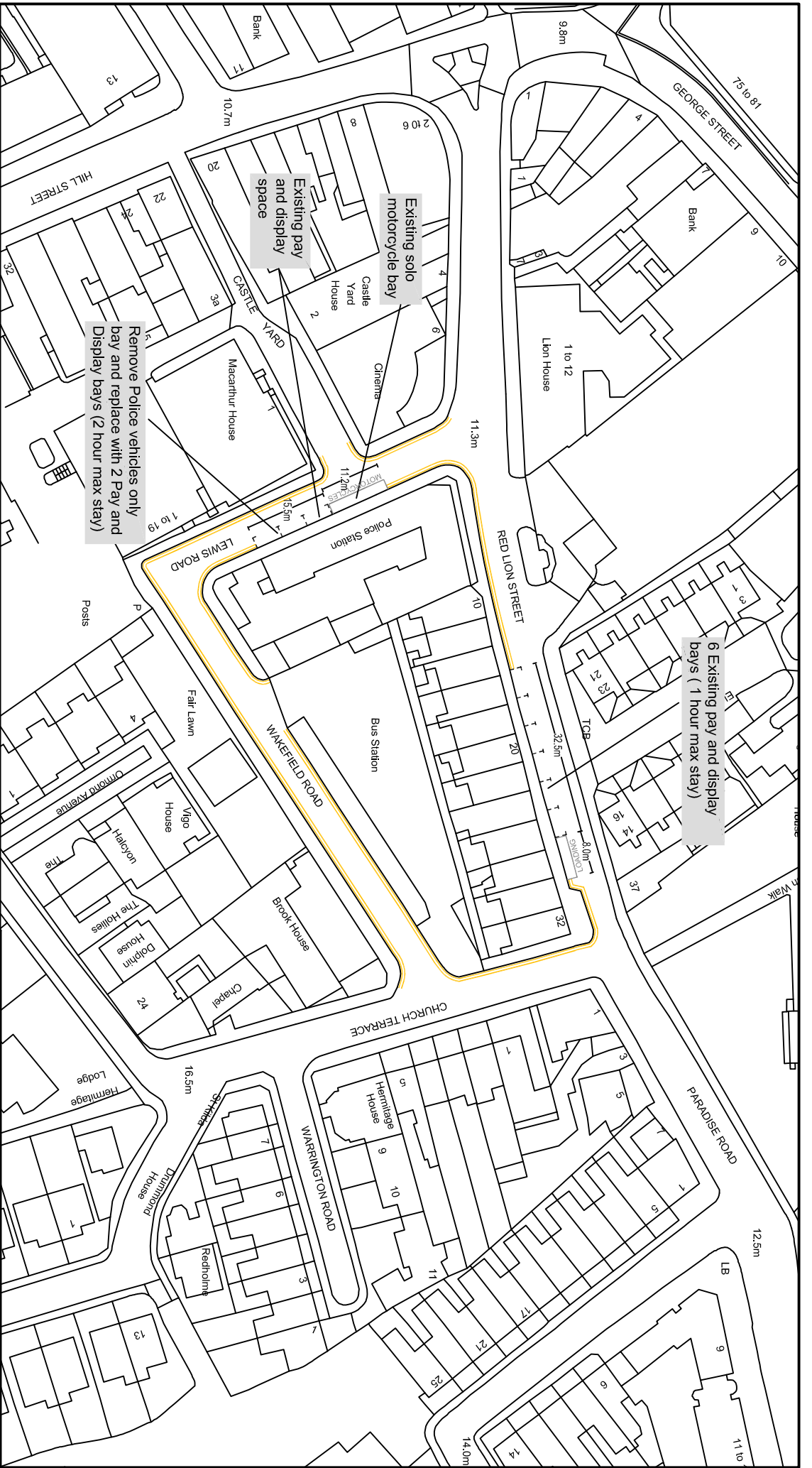

NOTES: REMOVE POLICE VEHICLE BAY IN LEWIS ROAD

"This map is reproduced from Ordnance Survey material with the permission of the Controller of Her Majesty's Stationery Office © Crown copyright. Unauthorised reproduction infringes Crown copyright and may lead to prosecution or civil proceedings 100019441 [2011]."

REVISION	A	AP 03/06/13	AP 03/06/13	SM 03/06/13	MT 03/06/13	Issue	Draft
DRAWN BY & DATE		DESIGNED BY & DATE	CHECKED BY & DATE	APPROVED BY & DATE	Scale (at A4 size)	<input checked="" type="checkbox"/>	1:1000

CLIENT	LONDON BOROUGH OF RICHMOND UPON THAMES		
PROJECT	POLICE VEHICLE BAY		
DRAWING TITLE	LEWIS ROAD		
ISSUING OFFICE	TWICKENHAM	DRAWING NUMBER	2245_CS_465476_002
TELEPHONE	020 88911411	REVISION	A

ROAD TRAFFIC REGULATION ACT 1984, SECTIONS 9 AND 10

THE LONDON BOROUGH OF RICHMOND UPON THAMES  
(RICHMOND TOWN) (PARKING PLACES) (No 1) EXPERIMENTAL ORDER 2012

**LEWIS ROAD, RICHMOND**  
**RED LION STREET, RICHMOND**  
(Reference 33/12)

1. NOTICE IS HEREBY GIVEN that the Council of the London Borough of Richmond upon Thames made the above mentioned Order on 25 July 2012 under sections 9 and 10 of, and Part IV of Schedule 9 to, the Road Traffic Regulation Act 1984, as amended.
2. The general effect of the order is:
  - (a) to introduce a parking bay for use by police vehicles only on the north-east side of Lewis Road outside the Police Station; and
  - (b) to introduce two additional pay and display parking bays on the south side of Red Lion Street.
3. Full details of the Order, which will come into operation on 20 August 2012, are contained in the following documents:-
  - (a) the order;
  - (b) a plan indicating the location and effect of the restrictions; and
  - (c) the Council's Statement of Reasons for making the Order.
4. Copies of the above documents:-
  - (a) can be inspected, quoting Reference 33/12, at the Civic Centre (Central Reception, ground floor), 44 York Street, Twickenham between 9.15am and 5pm on Mondays to Fridays, except for Bank and other public holidays; and
  - (b) may be viewed on the Council's web-site at [http://www.richmond.gov.uk/traffic\\_management\\_orders.htm](http://www.richmond.gov.uk/traffic_management_orders.htm)until the date on which the Order ceases to have effect.
5. Copies of the Order may be purchased from the Environment Directorate, Civic Centre, 44 York Street, Twickenham TW1 3BZ.
6. This Order provides that in pursuance of section 10(2) of the Road Traffic Regulation Act 1984 the Assistant Director of Environment of the London Borough of Richmond upon Thames, or other person authorised in that behalf by that officer may, if it appears to that officer or to that person essential in the interests of the expeditious, convenient and safe movement of traffic, or of the provision of suitable and adequate parking facilities on the highway, or for preserving or improving the amenities of the area through which the roads affected by this Order run, modify or suspend this Order or any provision thereof.
7. If the provisions of this Order continue in operation for a period of not less than six months, the Council will consider in due course whether the its provisions should be reproduced and continued in force indefinitely by means of an Order under sections 45, 46 and 49 of the said Act of 1984. Persons wishing to object to or support the making of such Order for the purpose of such reproduction and continuation in force

may, within the period of six months referred to above by 19 February 2013, send a statement in writing of their objection and the grounds of that objection to the address below.

8. Please address any representations to this Order to Head of Highways and Transport, London Borough of Richmond upon Thames, Civic Centre, 44 York Street, Twickenham, TW1 3BZ.
9. If any person wishes to question the validity of this order or of any of its provisions on the grounds that it or they are not within the powers conferred by the Road Traffic Regulation Act 1984, or that any requirement of the said Act of 1984 or of any instrument made under the said Act of 1984 has not been complied with, that person may, within 6 weeks from the date on which the order is made, apply for the purpose to the High Court.

ANDREW DARVILL  
Assistant Director, Traffic and Transport  
Civic Centre, 44 York Street, Twickenham TW1 3BZ

Dated: 3 August 2012

---

## PARKING PLACES ORDER

### THE LONDON BOROUGH OF RICHMOND UPON THAMES (RICHMOND TOWN) (PARKING PLACES) (No. 1) EXPERIMENTAL ORDER 2012

Made: 25 July 2012

Coming into operation: 20 August 2012

The Council of the London Borough of Richmond upon Thames, having consulted the Commissioner of Police of the Metropolis, in exercise of the powers conferred by Sections 9 and 10 of, and Part IV of Schedule 9 to, the Road Traffic Regulation Act 1984(a), as amended, hereinafter referred to as “the Act of 1984” and all other enabling powers hereby make the following Order —

#### Commencement and citation

1. This Order shall come into operation on 20 August 2012 and may be cited as the London Borough of Richmond upon Thames (Richmond Town) (Parking Places) (No. 1) Experimental Order 2012.

#### Interpretation

2. (1) In this Order the expression “enactment” means any enactment whether public, general or local and includes any order, bye-law, rule, regulation, scheme or other instrument having effect by virtue of an enactment.  
(2) Any reference in this Order to any enactment shall be construed as a reference to that enactment as amended, applied, consolidated, re-enacted by or as having effect by virtue of any subsequent enactment.  
(3) The Interpretation Act 1978(b) shall apply for the interpretation of this Order as it applies for the interpretation of an Act of Parliament.

#### Amendments to the parking places order

3. Whilst this Order continues in force the provisions of the London Borough of Richmond upon Thames (Richmond Town) (Parking Places) (Consolidation No. 2) Order 2008(c), as amended, shall apply as if :-
  - (a) there were added to Article 3(1) of that order a further meaning in respect of “police vehicles” and in Article 6 of that order a further paragraph numbered (4) to be added after paragraph (3), all as set out in Schedule 1 to this order;
  - (b) there were substituted for the item numbered 1C/2 the item similarly numbered and as set out in columns 1, 2, 3, 4 and 5 of Schedule 2 to this order;

---

(a) 1984 c. 27.

(b) 1978 c. 30.

(c) 2008/51 – there is no relevant amending order.

- (c) there were substituted for the item numbered 2A/7 the item similarly numbered and as set out in columns 1, 2, 3, 4 and 5 of Schedule 3 to this order; and
- (d) there were added to that order a new schedule being Schedule 10 and the item numbered 10/1 and as set out in columns 1, 2, 3, 4 and 5 of Schedule 4 to this order.

#### **Consequential modifications of other Orders**

- 4. Whilst this order remains in force any restriction in respect of waiting and loading at any parking place specified in Schedules 2, 3 or 4 to this order which is provided for by the London Borough of Richmond upon Thames (Waiting and Loading Restriction) (Civil Enforcement Area) (Consolidation No. 8) Order 2008(a), as amended, shall be suspended.

#### **Modification or suspension of this Order**

- 5. In pursuance of section 10(2) of the Act of 1984 the Assistant Director, Traffic and Transport of the London Borough of Richmond upon Thames, as the specified officer, or some person authorised in that behalf by that officer may, if it appears to that officer or to that person essential in the interests of the expeditious, convenient and safe movement of traffic, or of the provision of suitable and adequate parking facilities on the highway, or for preserving or improving the amenities of the area through which the road affected by this Order runs, modify or suspend this Order or any provision thereof.

Dated: 25 July 2012

Assistant Director, Traffic and Transport  
(The officer appointed for this purpose)

---

(a) 2008/38.

**SCHEDULE 1**  
(See Article 3(a))

PARAGRAPHS TO BE ADDED TO 2008/51

**A further meaning to be added to Article 3(1)**

“police vehicle” has the same meaning as in the Traffic Signs Regulations and General Directions 2002(a).

(a) S.I. 2002 No 3113.

**A further paragraph to be added to Article 6(4)**

- (4) Each parking place referred to in Schedule 10 may be used, subject to the provisions of this Order, for the leaving during the permitted hours of such vehicles as are police vehicles.

**SCHEDULE 2**  
(See Article 3(b))

ITEM TO BE SUBSTITUTED IN SCHEDULE 1C [to 2008/51]

**SCHEDULE 1C**

IN RELATION TO A PARKING PLACE REFERRED TO IN THIS SCHEDULE THE EXPRESSION "PERMITTED HOURS" MEANS THE PERIODS BETWEEN 8.30 AM AND 6.30 PM ON MONDAYS TO SATURDAYS INCLUSIVE AND BETWEEN 11.00 AM AND 5.00 PM ON SUNDAYS AND BANK HOLIDAYS, EXCEPT EASTER SUNDAY AND CHRISTMAS DAY.

PARKING PLACES IN RESPECT OF WHICH THE MAXIMUM PARKING PERIOD FOR WHICH A VEHICLE MAY BE LEFT DURING THE PERMITTED HOURS IS ONE HOUR, OR IN WHICH A VEHICLE MAY BE LEFT BETWEEN 8.30 AM AND 9.30 AM AND BETWEEN 5.30 PM AND 6.30 PM IF IT DISPLAYS A VALID RESIDENTS' OR RESIDENTS' VISITORS PERMIT.

1 No. of parking place	2 Designated parking place	3 Minimum number of parking spaces	4 Minimum total length in metres not to be occupied by parking spaces	5 Special manner of standing
1C/2	RED LION STREET, the south side, from a point opposite the party wall of Nos. 14 and 16 Red Lion Street north-eastwards to a point opposite the party wall of Nos. 26 and 26A Red Lion Street.	6	-	-

**SCHEDULE 3**  
(See Article 3(c))

ITEM TO BE SUBSTITUTED IN SCHEDULE 2A [to 2008/51]

**SCHEDULE 2A**

IN RELATION TO A PARKING PLACE REFERRED TO IN THIS SCHEDULE THE EXPRESSION "PERMITTED HOURS" MEANS THE PERIOD BETWEEN 8.30 AM AND 6.30 PM ON MONDAYS TO SATURDAYS INCLUSIVE, ANY SUCH DAY NOT BEING GOOD FRIDAY, CHRISTMAS DAY OR A BANK HOLIDAY.

PARKING PLACES IN RESPECT OF WHICH THE MAXIMUM PARKING PERIOD FOR WHICH A VEHICLE MAY BE LEFT DURING THE PERMITTED HOURS IS TWO HOURS, OR IN WHICH A VEHICLE MAY BE LEFT BETWEEN 8.30 AM AND 9.30 AM AND BETWEEN 5.30 PM AND 6.30 PM IF IT DISPLAYS A VALID RESIDENTS' OR RESIDENTS' VISITORS PERMIT.

1	2	3	4	5
No. of parking place	Designated parking place	Minimum number of parking spaces	Minimum total length in metres not to be occupied by parking spaces	Special manner of standing
2A/7	LEWIS ROAD, the north-east side, from a point opposite the south-eastern wall of the Odeon Cinemas, Red Lion Street south-eastwards for a distance of 5.5 metres.	1	-	-



**SCHEDULE 4**  
(See Article 3(d))

SCHEDULE AND ITEMS TO BE ADDED TO 2008/51

**SCHEDULE 10**

IN RELATION TO A PARKING PLACE REFERRED TO IN THIS SCHEDULE THE EXPRESSION "PERMITTED HOURS" MEANS AT ANY TIME.

PARKING PLACE IN RESPECT OF WHICH POLICE VEHICLES MAY BE LEFT.

1 No. of parking place	2 Designated parking place	3 Minimum number of parking spaces	4 Minimum total length in metres not to be occupied by parking spaces	5 Special manner of standing
10/1	LEWIS ROAD, the north-east side, from a point 16.7 metres south-east of a point opposite the south-eastern wall of the Odeon Cinemas, Red Lion Street south-eastwards for a distance of 10 metres.	1	-	-

EXPLANATORY NOTE

(This Note is not part of the Order but is intended to indicate its general purport.)

This Order introduces:

- (a) a parking bay (10 metres long) in Lewis Road adjacent to the Police Station for use by police vehicles which will be in operation at any time; and
- (b) a new Pay and Display bay in Red Lion Street (10 metres long) to operate between the hours of 8.30am and 6.30pm on Mondays to Saturdays inclusive and between 11am and 5pm on Sundays and bank holidays.

An existing pay and display bay at (a) above is being shortened to accommodate the police parking bay, and the provision of the new bays at (b) results in no overall change to the on-street parking provision in this locality.

ROAD TRAFFIC REGULATION ACT 1984

**THE LONDON BOROUGH OF RICHMOND UPON THAMES (RICHMOND TOWN)  
(PARKING PLACES) (No. 1) EXPERIMENTAL ORDER 2012**

STATEMENT OF REASONS FOR MAKING THIS ORDER

This Order introduces a number of changes to the on-street parking provision within Richmond Town community parking zone (Zone "A1").

The purpose of the experimental scheme is to provide a parking bay in Lewis Road, Richmond solely for the use by the Police and is intended to improve their operational effectiveness.

The new police bay will reduce the number of pay and display bays in Lewis Road. However, by providing an equivalent number bays in Red Lion Street where currently there are double yellow line waiting restrictions, there will be no overall loss of parking in this locality. It is anticipated that the additional parking bays in Red Lion Street will not have an adverse effect on the flow of traffic along that road.

This scheme is being introduced on an experimental basis to give the Council of the London Borough of Richmond upon Thames powers to make modifications or variations to the scheme in the light of operational experience.

The Council will consider in due course whether to make a permanent Order the effect of which will be to reproduce and continue in force indefinitely the provisions of this Order.

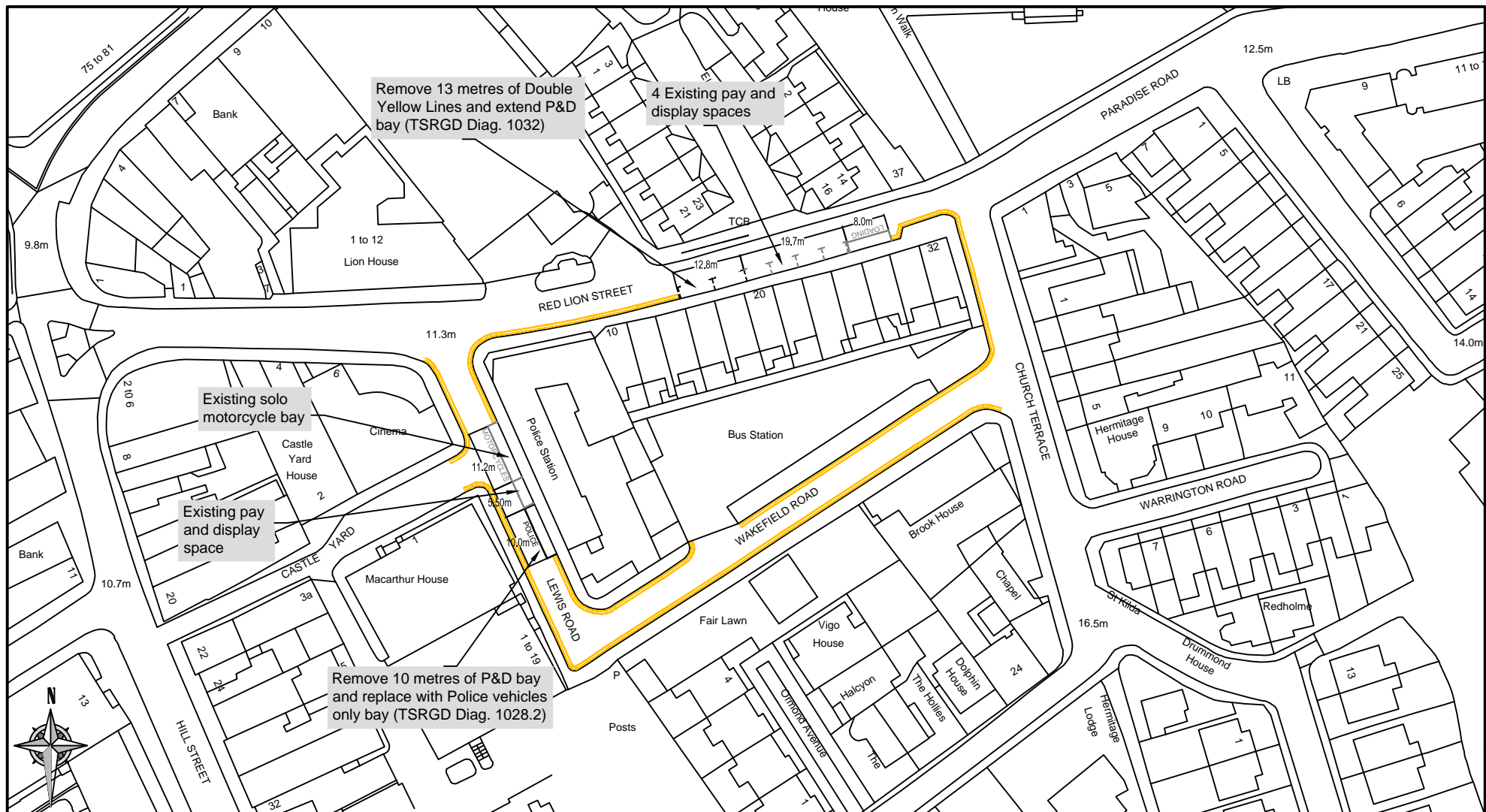

NOTES: INSTALL POLICE BAY TO TSRGD DIAG. 1028.2



CLIENT	LONDON BOROUGH OF RICHMOND UPON THAMES		
PROJECT	POLICE VEHICLE BAY		
DRAWING TITLE	LEWIS ROAD POLICE BAY AND RED LION ST P&D		
ISSUING OFFICE	TWICKENHAM	DRAWING NUMBER	2245_CS_465476_002
TELEPHONE	020 88911411	REVISION	

"This map is reproduced from Ordnance Survey material with the permission of the Controller of Her Majesty's Stationery Office © Crown copyright. Unauthorised reproduction infringes Crown copyright and may lead to prosecution or civil proceedings 100019441 [2011]."

REVISION	DRAWN BY & DATE	DESIGNED BY & DATE	CHECKED BY & DATE	APPROVED BY & DATE	Issue <input checked="" type="checkbox"/>	Draft <input checked="" type="checkbox"/>
Scale (at A4 size)						
1:1000						

UNCONTROLLED